

Sustainability Initiatives Update:

Horizon 2020 Steering Committee

Eileen Horn, Sustainability Coordinator

ehorn@lawrenceks.org

June 9, 2014



City of Lawrence



Sustainability:



Economy



Environment



Society



Sustainability: Multi-pronged approach

- **Policy/Programs**
- **Municipal Leadership**
- **Community Engagement**



Guiding Documents:

- ▶ City of Lawrence: Climate Protection Plan (2009)
- ▶ Douglas County: County Sustainability Plan (2011)
- ▶ City of Lawrence reports from Peak Oil Task Force, Solid Waste Task Force, Complete Streets committee, etc...
- ▶ Douglas County: Food System Assessment (2011)
- ▶ City & County: Horizon 2020: Chapter 16 (2011)
- ▶ T2040 Transportation Plan

Advisory Boards:

- ▶ Sustainability Advisory Board
 - ▶ Bicycle Advisory Committee
 - ▶ Douglas County Food Policy Council
-



Energy efficiency & conservation

Alternative fleet fuels

Economic development

Local food systems

Transportation

Water

Waste reduction & recycling

Green buildings

Citizen engagement & education



Municipal Leadership:



Municipal Leadership:



Venture Park:

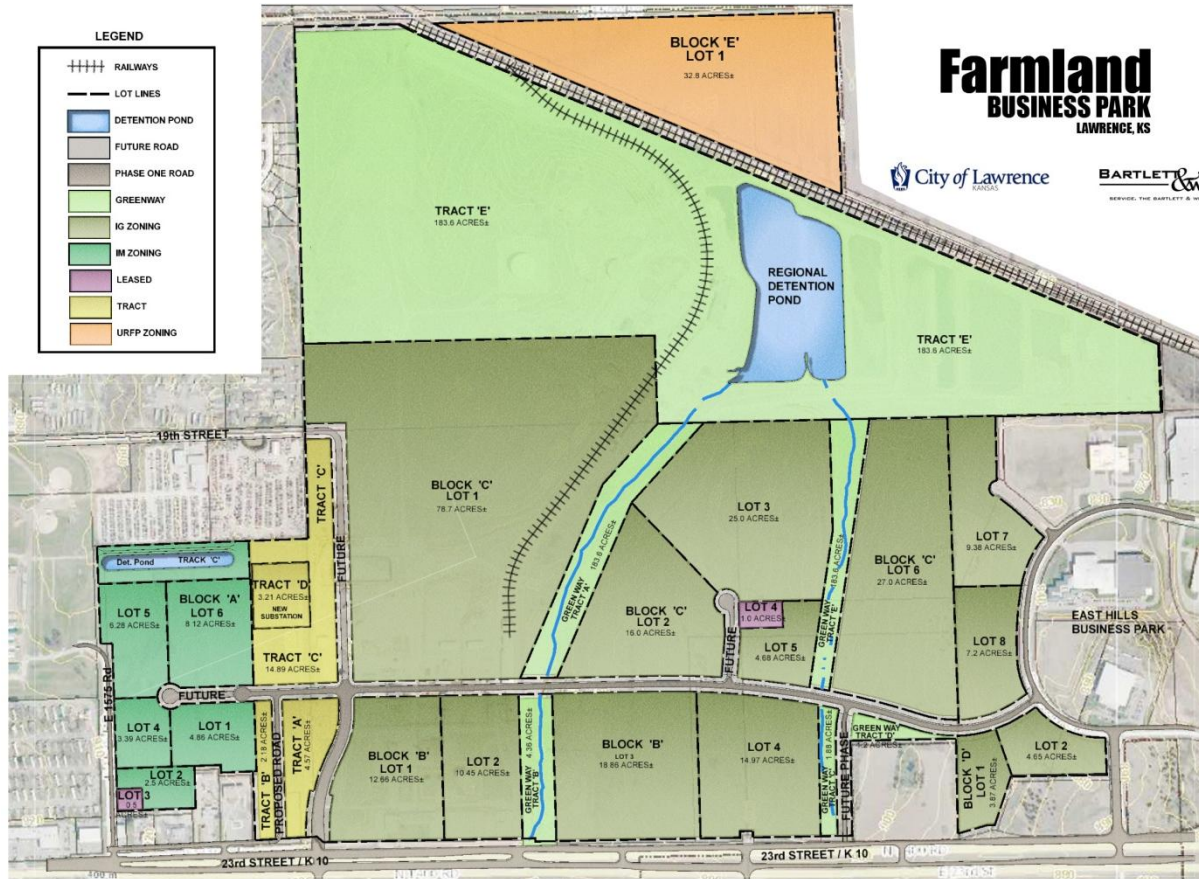

**CURB IT WITH
BLUE**





THE DOUGLAS COUNTY FOOD POLICY COUNCIL

- Established by the County Commission in 2010.
- Convened as a joint City-County Council in 2013.
- Identifies the benefits, challenges and opportunities for a successful food system.
- Recommends local policies to support food system.
- Represents a wide range of stakeholders in food system.



FOOD POLICY COUNCIL GOALS

- ✓ **Economy:** Economic development and entrepreneurial opportunities in local food production = jobs.
- ✓ **Wellness:** Improved health outcomes with access to wholesome foods.
- ✓ **Environment:** Improved environmental quality.
- ✓ **Equity:** Increased access to healthy food for all residents, regardless of income.



COMMON GROUND PROGRAM:

COMMON GROUND PROGRAM

- Utilizes vacant, under-utilized city owned properties.
- FREE lease to community gardeners, market farmers.
- WIN-WIN for gardeners and farmers who need land and City staff tired of mowing vacant lots.

www.lawrenceks.org/commonground



Common Ground 2013 Program Accomplishments:

Number of gardens/farms: **9**

Acres in food production: **5.6**

Number of gardeners/farmers: **120**

Number of classes/community work days: **54**

Number of volunteers/community participants: **463**

Pounds of produce grown (*estimate*): **40,000**

Market value of produce (*estimate*): **\$80,000**

Pounds of donated produce (reported): **2,000**

2013: FOOD HUB FEASIBILITY STUDY

Timeline: Final report June 2014

Proposed product: Feasibility study for a northeast Kansas regional food hub + collaboration with KC Regional Study

Methods: Producer surveys, institutional and wholesale purchaser surveys (throughout fall-winter 2013)

Funding: USDA Rural Development and Kansas Health



FOOD HUB BENEFITS

- Increases access to local foods
- Saves farmers time, increases market opportunities.
- Provides small and medium producers a reliable market.
- Enables institutions to consistently, reliably secure local food.
- Supports increased regional food security.
- Builds “local food culture” beyond the farmers market.



OTHER KEY COUNCIL ACCOMPLISHMENTS in 2013

- ✓ Improved Douglas County Incubator Kitchen Policies to improve access to food processing resources for entrepreneurs.
- ✓ Initiated a SNAP dollar-for-dollar matching program at regional farmers markets.
- ✓ Hosted 3rd annual Chefs Challenge at the Douglas County Fair.
- ✓ Engaged in County Agritourism Regulation revisions process.
- ✓ Co-hosted a food hub workshop with the Kansas Health Foundation, USDA Rural Development, and Kansas Farmers Union.
- ✓ Assisted USD497 in creating a Farm to School Coordinator position.

Horizon 2020 Topics of Interest:

- ▶ Green infrastructure for stormwater mitigation
- ▶ Prairie restoration on city/county property
- ▶ Bicycle and pedestrian improvements
- ▶ Food System:
 - ▶ In Economic Development, Community Facilities, Environment
 - ▶ Specifically: gardening, food hub development, food waste composting
- ▶ Continued focus on greenhouse gas emissions reductions
- ▶ Climate change adaptation





Jobs



Payments



Parks & Rec



Trash

Sustainability

[City Sustainability Initiatives](#) ▾

[Participate](#) ▾

[Home](#) / [Public Works](#) / [Quick Links](#) /

Sustainability

Sustainability means making decisions that balance the needs of the environment, economy, and society — for both present and future generations.

In the City of Lawrence, that means finding more efficient, smarter ways of serving our community.

We share our citizens' commitment to sustainability, and are working to foster a healthy environment that contributes to a growing economy and a livable community.

Sustainability Coordinator **Eileen Horn** can be reached at (785) 330-2873 or via email at ehorn@lawrenceks.org.



Annual Report

 Download the [2012 Sustainability Annual Report](#)

What the city is doing:

Our approach to sustainability involves these key initiatives. Each of these initiatives provides an opportunity to positively impact our City operations and our citizen's quality of life.

- [Energy efficiency & conservation](#)
- [Fuel conservation & alternative fleet fuels](#)
- [Economic development](#)
- [Healthy, local food systems](#)
- [Sustainable transportation](#)
- [Water & utilities](#)
- [Waste reduction & recycling](#)
- [Green building design & construction](#)
- [Outdoors & recreation](#)

What you can do:

Sustainability is a city priority, but creating a healthy environment, economy, and society is going to take the efforts of all of us. Find out [what you can do](#) to participate in the city's sustainability efforts.

- [What you can do](#)
- [Citizen engagement & outreach](#)
- [Sustainability Advisory Board](#)

City Commission · Meeting Agenda

The **04-01-14** City Commission Meeting agenda is now online.

I Want To...

- [Apply](#)
- [Contact](#)
- [Dispose](#)
- [Pay](#)
- [Report](#)
- [Sign Up](#)
- [View](#)

Events

	Tue, Apr 8, 2014
12:00pm	Parks & Recreation Board Meeting
4:10pm	Public Transit Advisory Committee
6:30pm	City Commission Meeting
	Sat, Apr 19, 2014
11:00am	Earth Day Parade & Festival
	Sat, May 10, 2014
10:00am	Lawrence-Douglas Bicycle Helmet Fair
	Thu, Sep 18, 2014
4:00pm	Youth Camps - Golf Advanced (runs W/T 9/19)

[View](#)

The Department of
Sustainability[About Us](#) [Departments](#) [District Attorney](#) [District Court](#) [Employment](#) [Local Government](#) [Online Services](#)

Monday, June 09, 2014

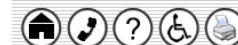
SHARE   

Follow us on:



Sustainability Home

You are here: [Home Page](#) > [Departments](#) > [Administration](#) > [Sustainability](#) > Sustainability Home

Welcome to the home page for the Sustainability Department of Douglas County, Kansas.

Sustainability means balancing the needs of the economy, environment, and society. Together, we can create a vibrant economy, a healthy environment, and a livable society for all Douglas County residents – today and into the future.

As a County, we are striving for sustainability in our day-to-day operations, our facilities and buildings, the policies we implement, and the education we provide to our employees and citizens. Currently, we're working to reduce the energy use in our buildings and utilize the free renewable power of the sun where it's appropriate. We have a robust recycling program in our County buildings, innovative pilot programs to reduce fuel use in our fleet, and are working to purchase "green" products for office and cleaning supplies.

Want to learn more? Check out our Sustainability Plan for Douglas County facilities and operations!

- [Douglas County Sustainability Plan: March 17, 2011](#) (PDF format)



Energy Efficiency Projects



Forms & Documents



Food Policy Council



What YOU Can Do



Recycling



Sustainability Team



Renewable Energy



Green Games



Sustainability Coordinator

Sustainability Coordinator
Eileen Horn

Contact Information

Address
1100 Massachusetts Street, 2nd level, Lawrence, KS 66044
Phone (785) 330-2873 **Fax** (785) 832-5148
Office Hours
Monday - Friday
8:00 a.m. - 5:00 p.m.

Feedback

Douglas County wants to hear from you! Please click on the 'Give Feedback' button below to submit your feedback to us.

[Give Feedback >>](#)

Language Translator



- Select a Language - ▾

Disclaimer: This language translator is provided by Google as a service. Douglas County does not expressly or implied warrant that the translated

Department Links

[Sustainability Home](#)
[Sustainability Coordinator Eileen Horn](#)
[Energy Efficiency Projects](#)
[Food Policy Council](#)
[Green Games](#)
[Recycling](#)
[Renewable Energy](#)
[Sustainability Team](#)
[What YOU Can Do](#)
[Forms & Documents](#)
[Food System Report: Executive Summary](#)
[Food System Report: Building a Deep Rooted Local Food System](#)
[Boiler Replacement: June 16, 2010](#)
[Flyer: Our Food System](#)
[JLE Efficiency Upgrades: June 16, 2010](#)
[more...](#)
[External Links](#)
[YouTube: Project Good Neighbor](#)
[YouTube: Sustainability in Action](#)
[Section Home](#)
[Departments](#)



Acrobat Reader is needed to view files in PDF format. Download a free copy by clicking

ehorn@lawrenceks.org

785-330-3121

Questions?