

GENERAL SIDEWALK LAYOUT PLAN

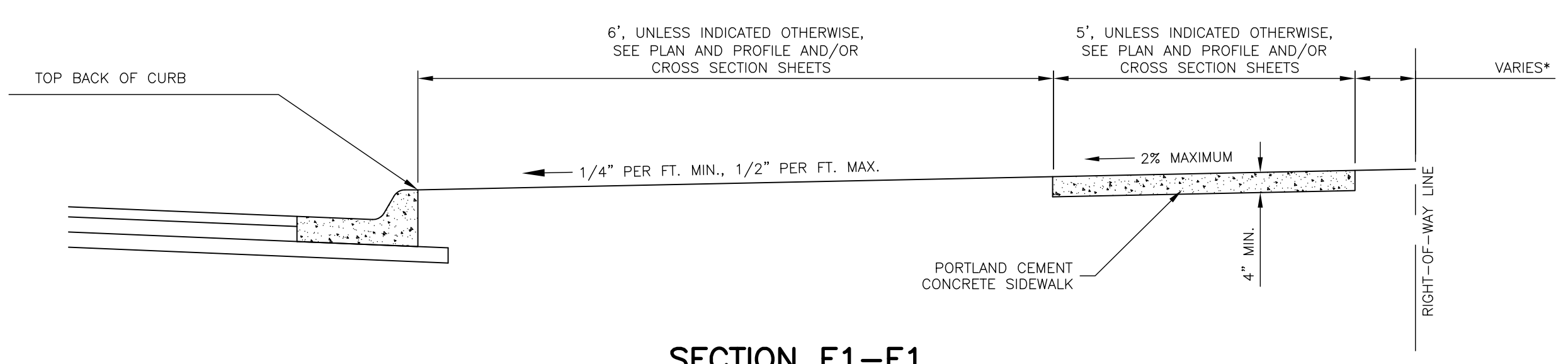

SECTION E1-E1

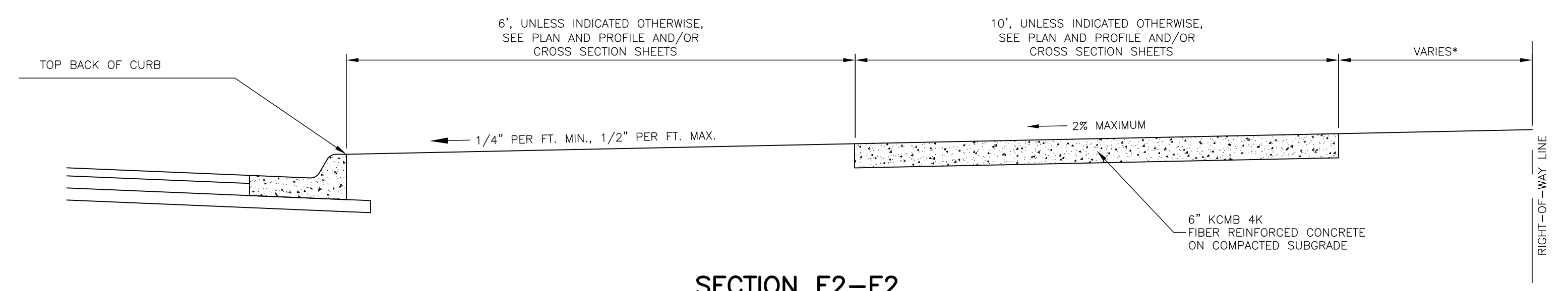

SECTION E2-E2

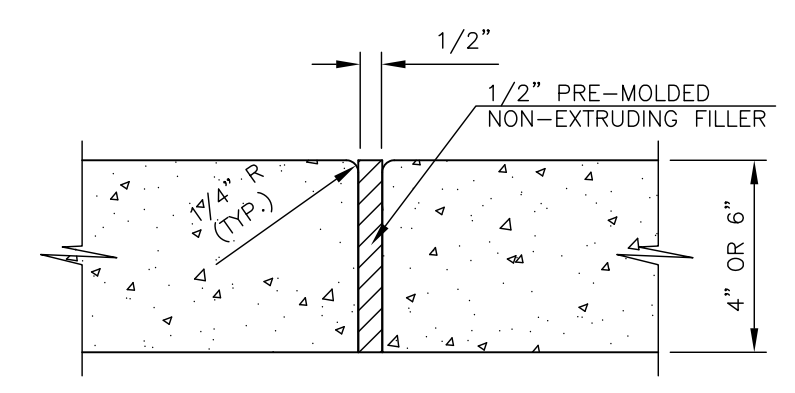

SECTION F-F ISOLATION JOINT

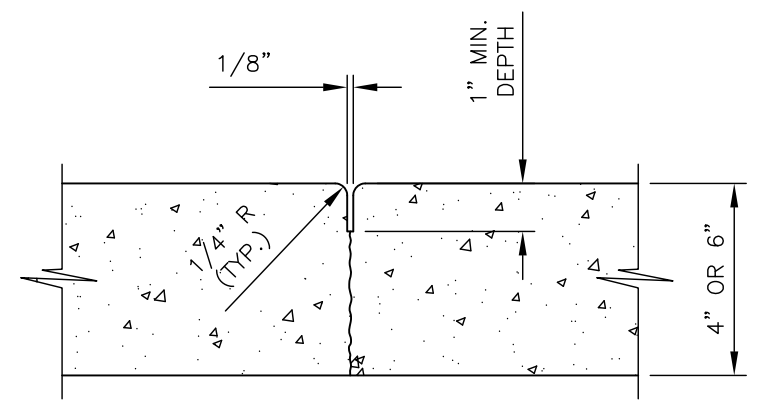

SECTION G-G CONTRACTION JOINT (SAWED OR FORMED)

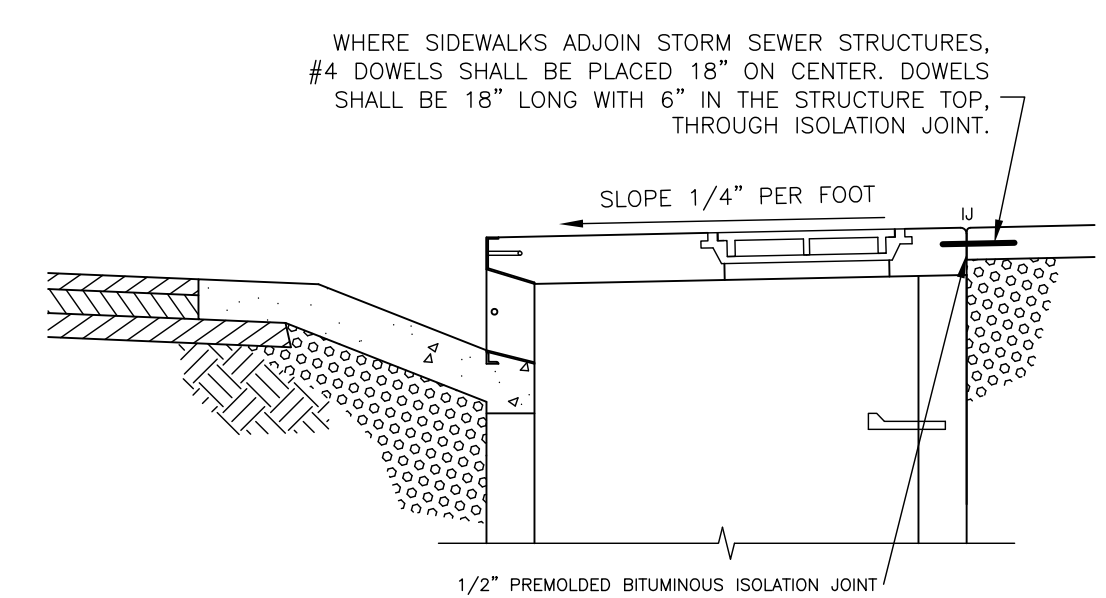

SECTION H-H SIDEWALK TO INLET DOWELING DETAIL

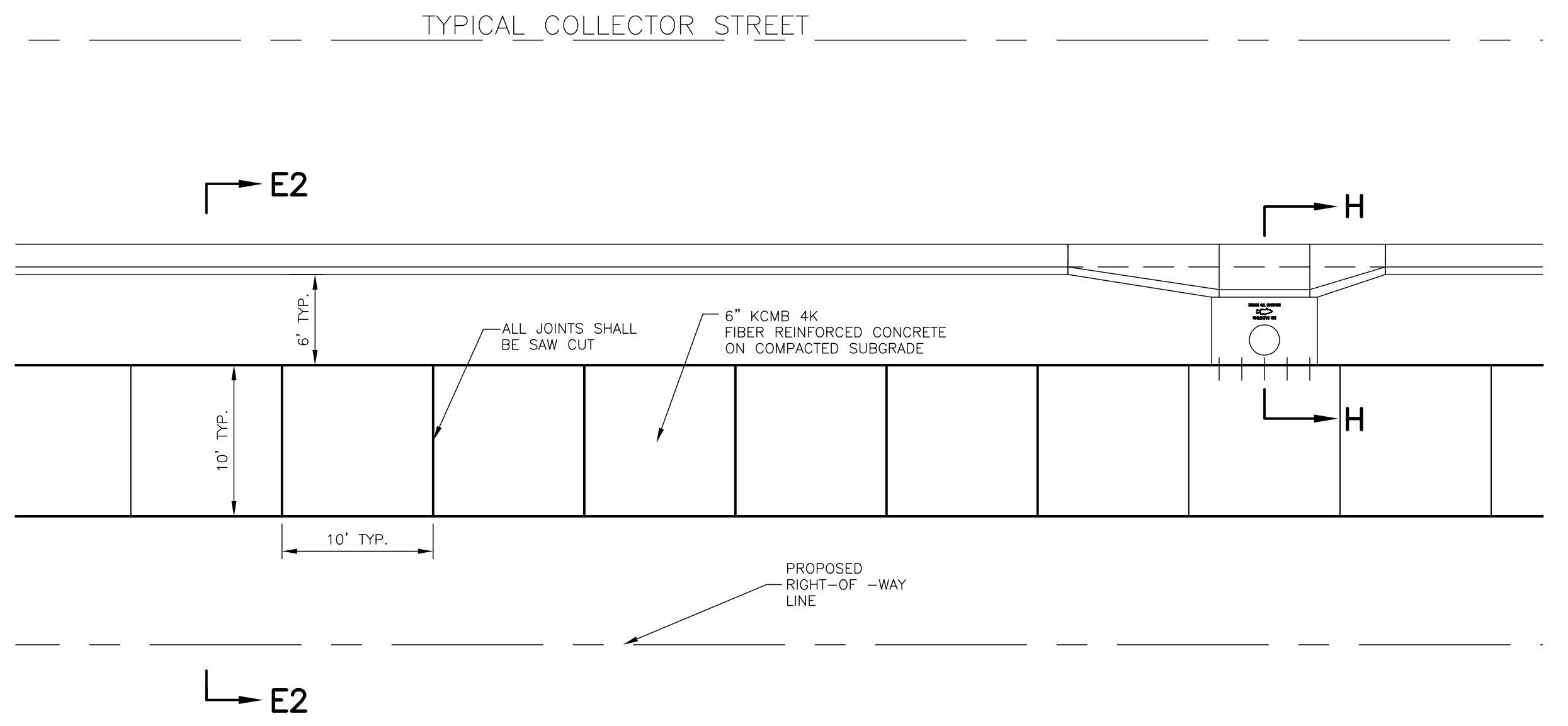

GENERAL SHARED USE PATH LAYOUT PLAN

SIDEWALK GENERAL NOTES

1. CONSTRUCTION JOINTS SHALL BE PLACED IN 5'-0" WIDE SIDEWALKS AT A MINIMUM OF 5'-0" INTERVALS. WHEN OTHER WIDTHS OF SIDEWALK ARE USED, CONSTRUCTION JOINTS SHALL BE PLACED AS DIRECTED BY THE CITY ENGINEER OR AN AUTHORIZED REPRESENTATIVE.
2. ISOLATION JOINTS SHALL BE PLACED AT ALL LOCATIONS WHERE SIDEWALK ABUTS EXISTING STRUCTURES AND AS DIRECTED BY THE CITY ENGINEER OR AN AUTHORIZED REPRESENTATIVE.
3. ACCESS RAMPS SHALL BE CONSTRUCTED AT ALL LOCATIONS WHERE SIDEWALKS INTERSECT NEW STREET CONSTRUCTION AND AS OTHERWISE SHOWN ON THE PLANS.
4. ALL SHARED USE PATH JOINTS SHALL BE SAW CUT.
5. ALL SIDEWALKS AND RAMPS MUST BE CONSTRUCTED TO CURRENT ADA STANDARDS.

2017 EDITION SHEET ____ OF ____

DATE	BY	REVISION
03-21-17	LJM	REPLACES ALL PREVIOUS VERSIONS OF SIDEWALK DETAILS
02-22-16	LJM	REPLACES ALL PREVIOUS VERSIONS OF SIDEWALK DETAILS
03-20-08	LJM	REPLACES ALL PREVIOUS VERSIONS OF SIDEWALK DETAILS



STANDARD DETAILS FOR CONCRETE SIDEWALKS

DAVID P. CRONIN CITY ENGINEER THOMAS M. MARKUS CITY MANAGER

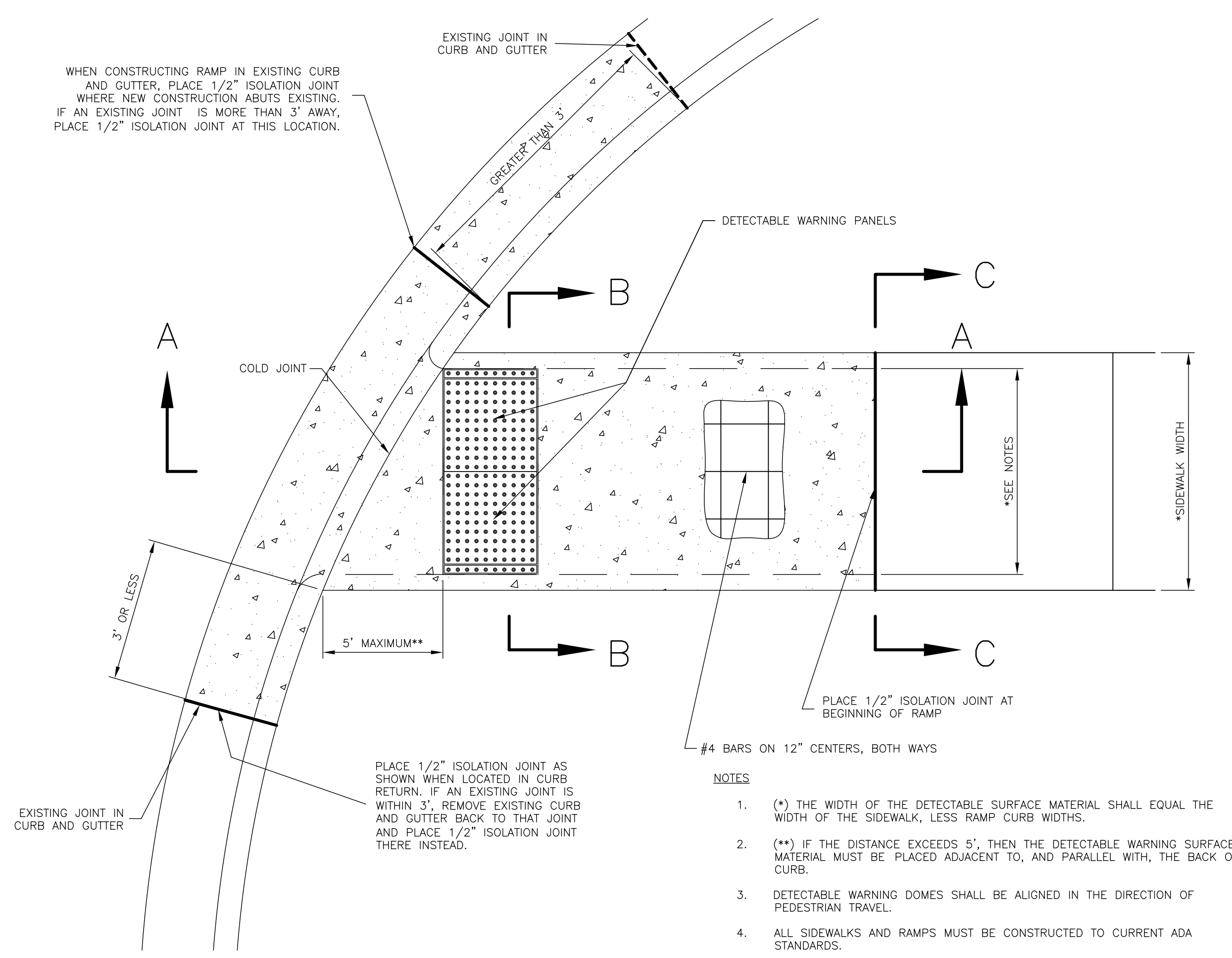

ACCESS RAMP PLAN

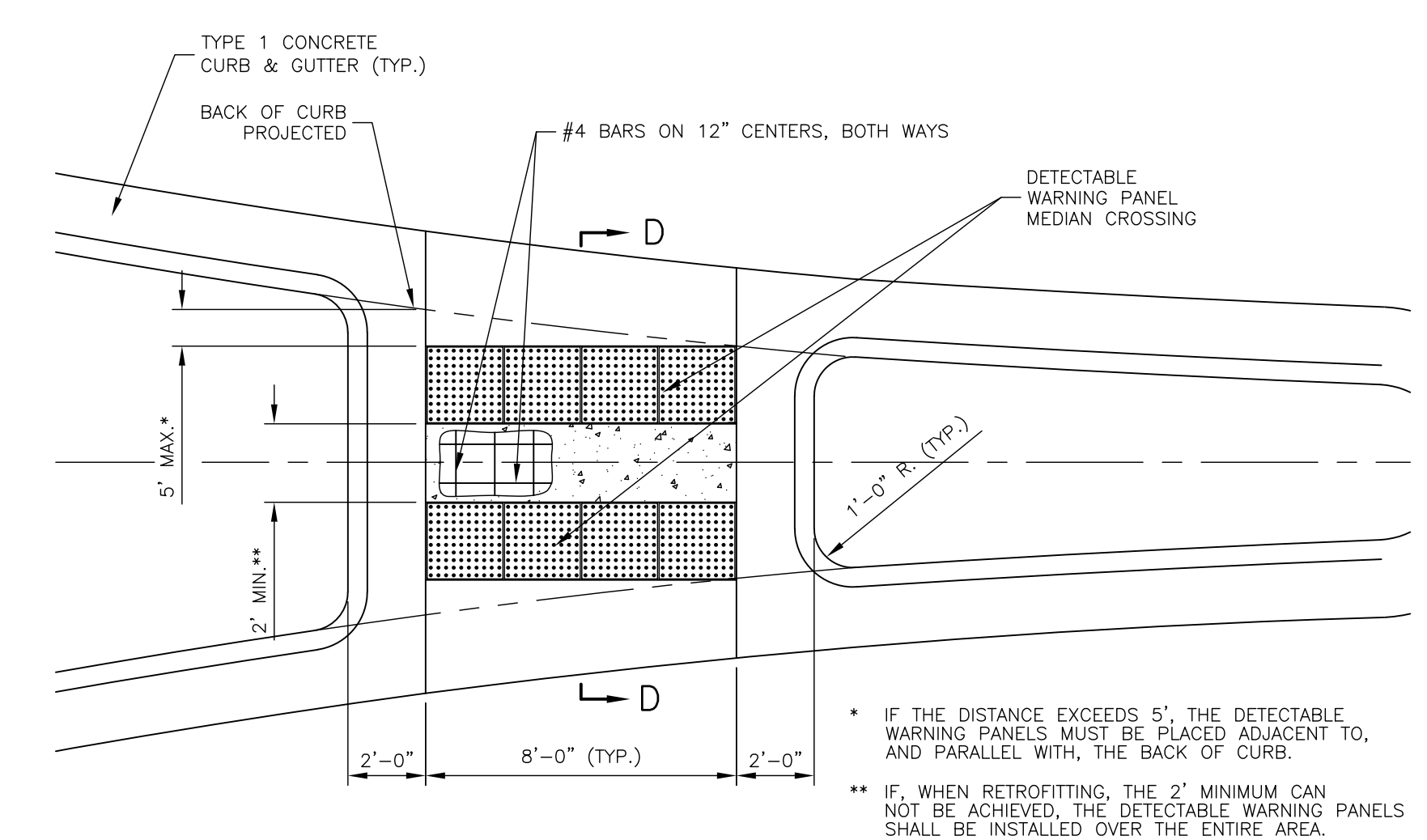

MEDIAN RAMP CROSSING PLAN

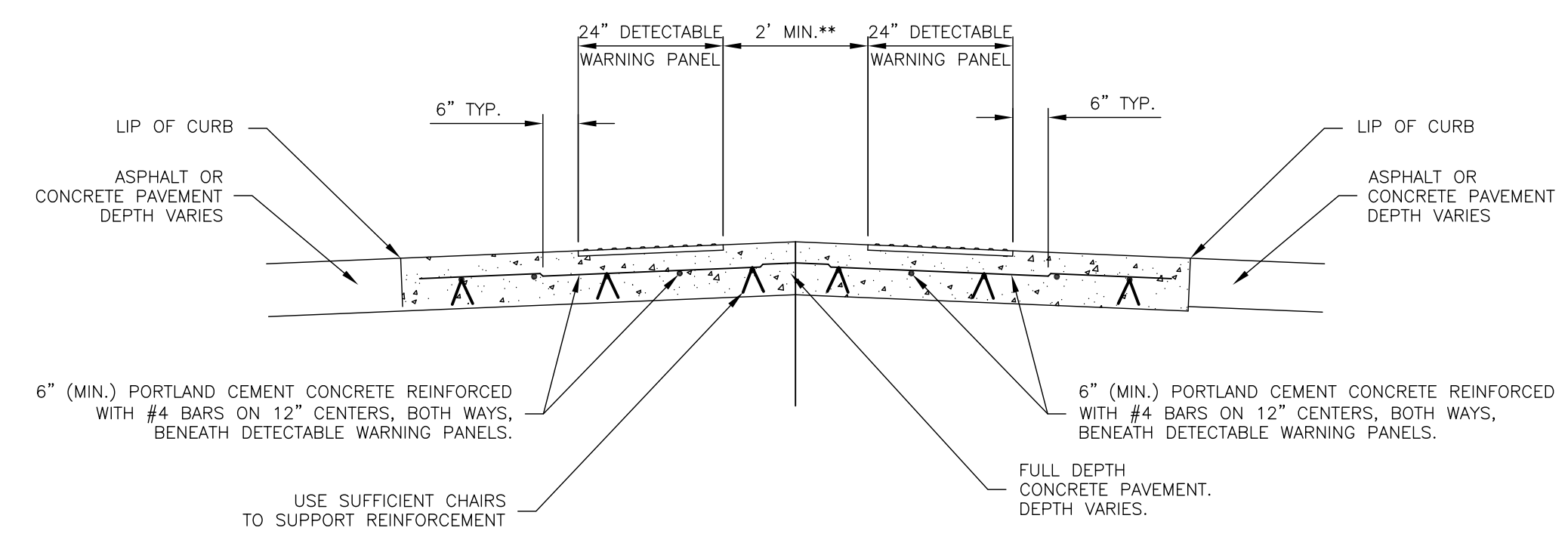

SECTION D-D

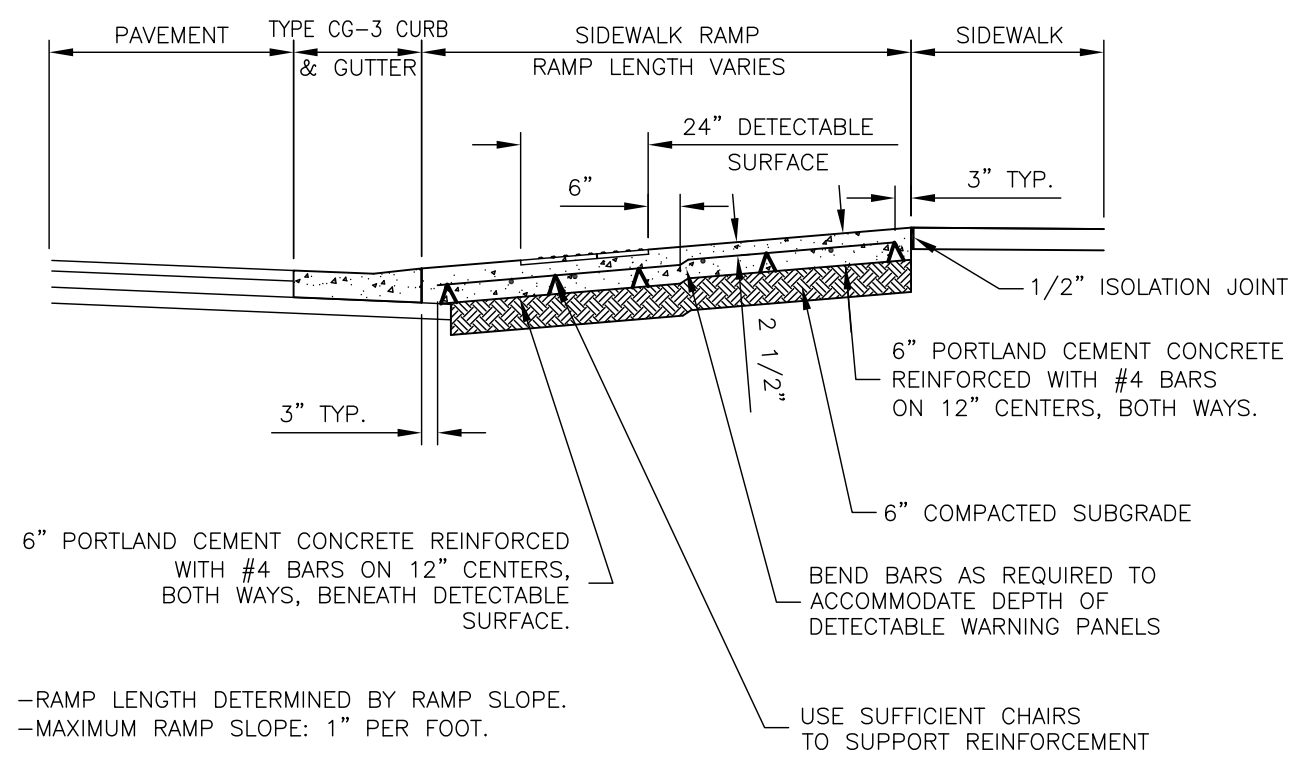

SECTION A-A

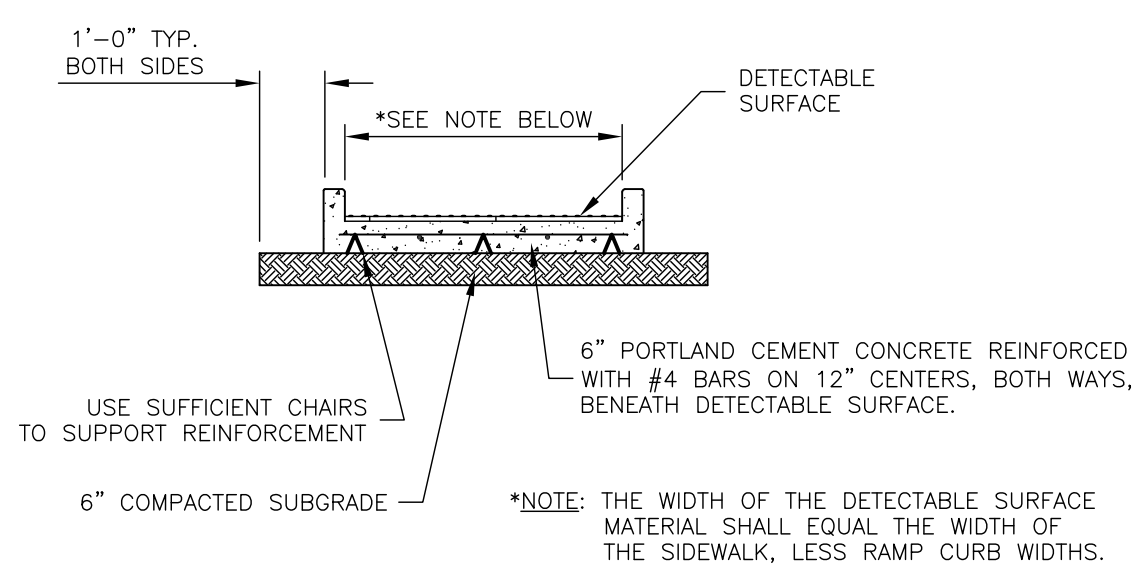

SECTION B-B

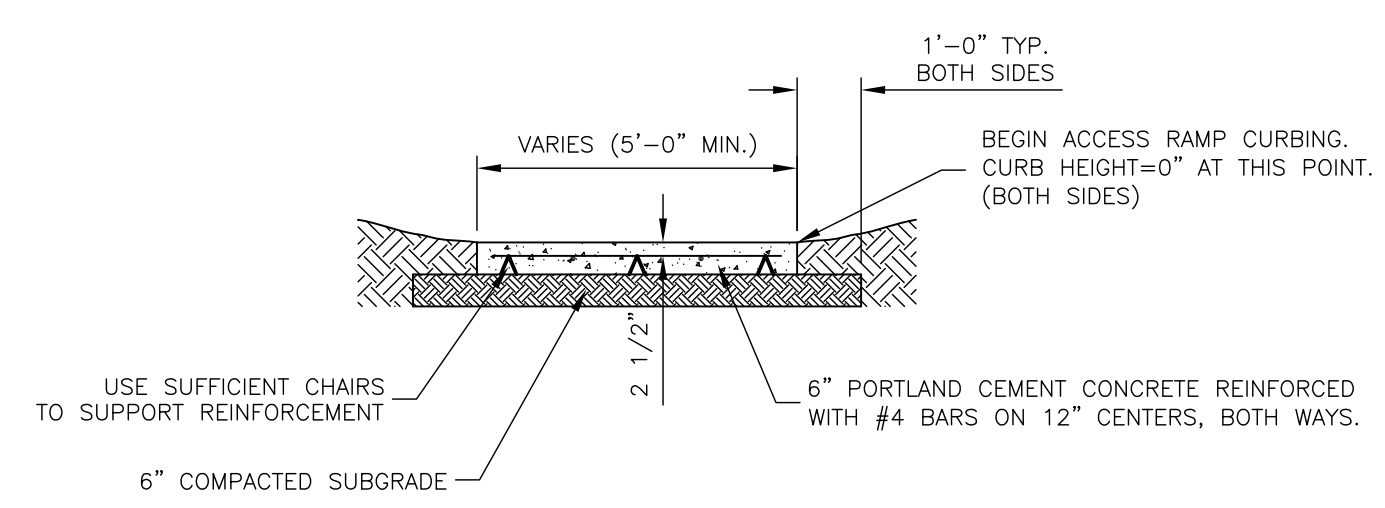

SECTION C-C

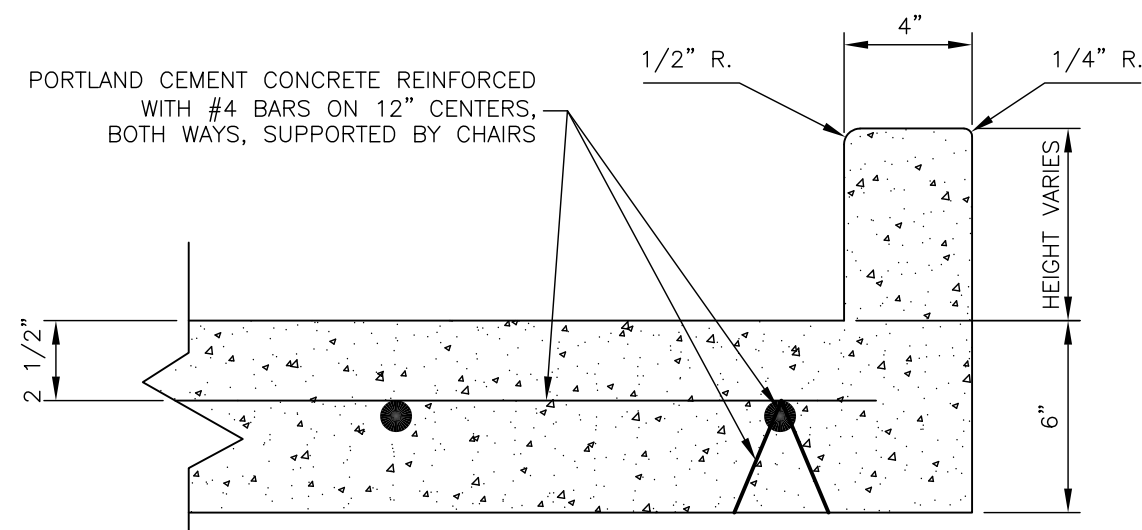

ACCESS RAMP CURB DETAIL

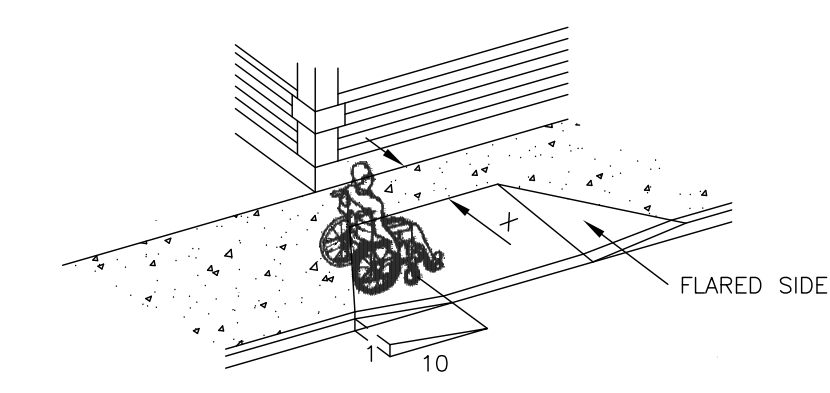

THIS FIGURE SHOWS A TYPICAL CURB RAMP, CUT INTO A WALKWAY PERPENDICULAR TO THE CURB FACE, WITH FLARED SIDES HAVING A MAXIMUM SLOPE OF 1:10. THE LANDING AT THE TOP, MEASURED FROM THE TOP OF THE RAMP TO THE EDGE OF THE WALKWAY OR CLOSEST OBSTRUCTION IS DENOTED AS "X". IF X, THE LANDING DEPTH AT THE TOP OF THE CURB RAMP IS LESS THAN 48", THEN THE SLOPE OF THE FLARED SIDE SHALL NOT EXCEED 1:12.

ACCESS RAMP WITH FLARED SIDES

2017 EDITION SHEET ____ OF ____

DATE	BY	REVISION
03-21-17	LJM	REPLACES ALL PREVIOUS VERSIONS OF SIDEWALK DETAILS
02-22-16	LJM	REPLACES ALL PREVIOUS VERSIONS OF SIDEWALK DETAILS
03-20-08	LJM	REPLACES ALL PREVIOUS VERSIONS OF SIDEWALK DETAILS



STANDARD DETAILS FOR CONCRETE SIDEWALK ACCESS RAMPS

DAVID P. CRONIN CITY ENGINEER THOMAS M. MARKUS CITY MANAGER