



PUBLIC ART REQUEST FOR QUALIFICATIONS (RFQ)

Lawrence, Kansas Police Department – Headquarters Park Site

Public Art Project Budget: \$325,000

Deadline for Submittals: Midnight, June 3, 2019

DESCRIPTION

The Lawrence Cultural Arts Commission (LCAC), in collaboration with the Lawrence Police and Parks & Recreation Departments, is seeking professional artists or artist teams to develop innovative, original exterior art to be incorporated as part of the new Lawrence Police Department Headquarters [site](#).



BACKGROUND

Construction of the new [Lawrence Police Department Headquarters facility](#) will begin during the summer of 2019. The facility will be constructed on an approximately 29.5 acre Open Space District site located at 5100 Overland Drive in Lawrence. The site includes the Police Headquarters facility, additional Police facilities, wooded areas and mixed-use park space. Park access will primarily include the Police Department, area neighborhoods, nearby Free State High School and the general public.

BUDGET/COMMISSION

The total public art project budget is \$325,000. Artwork for this project will be commissioned through the City of Lawrence Cultural Arts Commission (LCAC). Collaboration with the Lawrence Parks & Recreation Department to include artwork as an integrated aspect of park amenities is encouraged. *The LCAC and staff will coordinate the overall public art program for the site which may include more than one artist or project.*

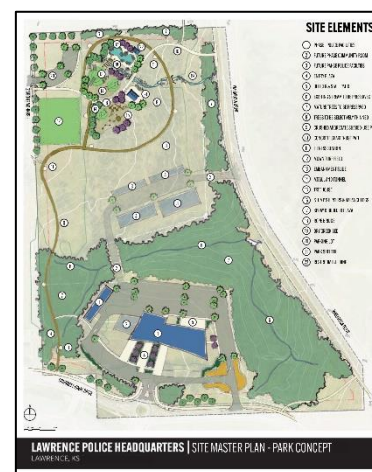

ELIGIBILITY

The opportunity to compete for this project is open to all professional artists residing in the United States. Interested local and regional artists are encouraged to submit their qualifications.

The City of Lawrence does not discriminate on the basis of race, gender, religion, age, national origin, sexual orientation, or disability. Qualifications by City employees or their relatives, and members of the Artist Selection Panel or Cultural Arts Commission or their relatives will not be considered. Experience with public art projects, especially in relation to capital projects, is preferred. Applicants must be able to work effectively within the project timeline and collaborate with the design team and multiple government agencies.



SELECTION PROCESS

The selection panel will comprise arts professionals familiar with the field of public art, community members, police representatives, design professionals and city staff. The panel will select a small group of finalists for interviews and to possibly develop proposals.

The criteria used by the panel will include:

- Artistic quality, innovation, and originality
- Professional public art experience
- Sensitivity and connection to the site

The City of Lawrence is not required to make selections from these submissions, if, in their opinion, qualifications are not appropriate.

SUBMISSIONS

Interested artists should enter and submit their application materials, listed below, **online** by midnight, Central Time, June 3, 2019. The online application form is here: <https://lawrenceks.org/public-art/> and will include the following which should be prepared in advance of filling out the online form.

1. **A letter of interest**, up to 500 words, outlining your approach to public art and insights regarding your interest in making art for this project; what you bring to the project as an artist; challenges and/or sources of inspiration presented by the project; what you would hope to gain from this experience; and any other comments that might help to differentiate you as a candidate for this program.
2. **A professional resume/CV**, including three professional references and their contact information, in PDF format.
3. **An annotated image list**, including thumbnail images, of past works in a PDF format that clearly indicates the title, dimensions, materials, date of work, and locations, as well as project budget and commissioning entity, if applicable.
4. **Up to 15 images of past work** and/or web links for short video if applicable.
5. **A link to your website or up to three individual pieces, total, of selected printed materials** such as articles, catalogues, etc. in PDF format.

For further information, contact Porter Arneill, parneill@lawrenceks.org or 785-832-3402

ANTICIPATED ART PROJECT SELECTION TIMELINE

Qualifications Due: June 3, 2019 by Midnight, Central Time

Panel Review(s): June/July 2019

If applicable, RFP to selected artists: July/August 2019

Proposals Reviewed/Artist(s) Selected: September/October 2019

Estimated Project Completion Date: Summer/Fall 2020

The Lawrence Cultural Arts Commission (LCAC) was established by the City of Lawrence in December 1973, as the Lawrence Arts Commission. It was charged "to promote, encourage, and coordinate the artistic and cultural activities of the community through recommendations made to the Governing Body of the City and through coordinating endeavors of those groups and organizations which identify themselves as primarily concerned with the artistic environment of Lawrence."