



Pre-Application Meeting Required Planner _____ Date _____ Application Number _____ L- _____ Date Received _____ _____

6 East 6th St.
P.O. Box 708
Lawrence, KS 66044

www.lawrenceks.org/pds

Phone 785-832-3150
Tdd 785-832-3205
Fax 785-832-3160

**APPLICATION FOR LANDMARK DESIGNATION IN
THE LAWRENCE REGISTER OF HISTORIC PLACES**

1. Property Nomination Information

Historic Property Name:	Clark Residence
Property Address:	643 Indiana Street
City, State, Zip Code:	Lawrence, Kansas 66044
Legal Description:	LANE'S FIRST ADD BLK 2 (LT 24 FT WIDE) LT 1 & LT 2 (LT 50
	FT WIDE); ALSO INDIANA STREET S 22 FT LT 165 (U02251,4642
	& 4643 COMBINED 1988)

2. Applicant Information

Name:	Daniel and Phyllis Watkins c/o Lindsay Crick
Street Address:	219 N 5th St.
City, State, Zip Code:	Lawrence, Kansas 66044
Home Phone:	513-257-4892
Work Phone:	
Email Address:	lindsaycrick@gmail.com

3. Owner Information

Name:	Daniel and Phyllis Watkins
Street Address:	643 Indiana Street
City, State, Zip Code:	Lawrence, Kansas 66044
Home Phone:	
Work Phone:	
Email Address:	danwatkins@danwatkinslaw.com

Is this an owner initiated nomination?: ☒ Yes ☐ No

If not, has the owner been notified by the applicant of this nomination?: ☐ Yes ☐ No

If sponsored by an organization:

Organization Name: Lawrence Preservation Alliance

Organization Address: P.O. Box 1073

Organization City, State, Zip Code: Lawrence, Kansas 66044

4. This property is being nominated for its:
 Historic Significance: ☐
 Architectural Significance: ☒
 Association with an Important Local, State or National individual or event: ☐

5. Historic Background Information

Date Built: 1895	Estimated Documented <input type="checkbox"/> <input checked="" type="checkbox"/>	Source: National Register Nomination	Comments:
Date of Building Alterations or Additions: See attachments	Estimated Documented <input type="checkbox"/> <input type="checkbox"/>	Source: Owner	Comments:

Description of Building Additions or Alterations:

Original Owner: James Francis Wilder	Source: NR Nomination & Watkins Museum Files
Original Builder or Architect: Unknown	Source:
Original Use: Residence	Source: NR Nomination & Watkins Museum Files

6. Architectural Significance

See attachments

7. Historic Significance

See attachments

8. Authorization and Certification

I, the undersigned do hereby have the legal authority to submit this nomination and I certify that the information provided on this application is true and correct to the best of my knowledge.

Signature: Jan Watkins 11/20/18 Date:

Signature: Phyllis Watkins 11-20-15 Date:



**City of Lawrence
Douglas County**
PLANNING & DEVELOPMENT SERVICES

6 East 6th St.
P.O. Box 708
Lawrence, KS 66044

www.lawrenceks.org/pds

Phone 785-832-3150
Tdd 785-832-3205
Fax 785-832-3160

**INFORMATION REQUIRED FOR SUBMITTAL WITH APPLICATION FOR NOMINATION
TO THE LAWRENCE REGISTER OF HISTORIC PLACES**

Use the checklist below to be sure your application is complete.

- ☒ Application Form
- ☒ Certified property owner list from County Clerk's office for properties within 250' of the requested property for nomination.
- ☐ Photographs of each elevation of the structure.
- ☒ Legal description of nominated property.
- ☒ If the property is listed on the State and/or National Registers of Historic Places, copies of the applications for nomination and pertinent resources materials.
- ☒ Any additional documentation you believe is relevant to this nomination which you would like considered in the review process.
- ☒ The fee for application processing is \$10.00 for landmark nominations and \$50.00 for district nominations.



APPLICATION FOR LANDMARK DESIGNATION IN THE LAWRENCE REGISTER OF HISTORIC PLACES

643 Indiana Street
Lawrence, Kansas 66044

Architectural Significance

This large, two and a half story story house in Old West Lawrence is a well-preserved example of the Queen Anne style of architecture that was popular between approximately 1880 and 1910. The house has a rusticated stone foundation with clapboard or weatherboard siding. There is a band of scalloped shingles between the first and second floors, with these same shingles appearing on each of the gables. The roof is complex mixture of gable and hipped roof forms and is clad with asphalt shingles; the roof also contains multiple, red brick chimneys. All windows are 1-over-1, with the exception of a few decorative windows (primarily in the gables).

The front facade has a full-width, wrap-around porch with a shed roof that has two gabled projections, one at the front entry location and the other at the corner where the porch wraps to the west. This porch is supported by turned columns and has a great deal of architectural detail, especially the spandrel fans located in each of the gables. The porch also has spandrel and bracket detailing that runs its entire length, as well as a decorative balustrade.

There is an additional entry on the south elevation of the house, as well as another entryway on the west elevation that is set into a small shed roofed addition/enclosed porch.

At the northwest corner of the property is a one and a half story, two-car garage that has matching siding and shingle detail in the gable ends. The garage access is from the south side of the structure. The south gable end has two windows, and the garage's eaves have exposed rafter tails with brackets at the gable ends.

Overall, this property has a high degree of architectural integrity worthy of placement on the Lawrence Register of Historic Places. Additionally, it is listed as a contributing structure within the Old West Lawrence National Register District.

APPLICATION FOR LANDMARK DESIGNATION IN THE LAWRENCE REGISTER OF HISTORIC PLACES

643 Indiana Street
Lawrence, Kansas 66044

Historic Information

(All information is from the "643 Indiana St." vertical file at the Watkins Museum)

This home was built ca. 1895 for James Francis Wilder, more commonly known as J. F. Wilder. Wilder came to Lawrence from Troy, New York in 1870 along with his wife, Abigale Betsy Bogardus Wilder. In 1873, his brother Charles followed, and after his arrival, the two formed the Wilder Brothers Shirt Manufacturing Company.

Wilder Brothers produced made to order garments, especially men's shirts. Business grew rapidly, and they soon had traveling salesmen that covered Kansas, Colorado, New Mexico, and Texas. Uniform shirts were sold to fire companies; miners purchased wool flannel; and bartenders often purchased "fancy" shirts made to order just for them.

Following their initial success, J.F. and Charles built a laundry next to their original location to provide a local and mail-order laundry service. In 1881, they began constructing a new, three-story building with a basement at 612 New Hampshire Street (later home to Reuter Organ Company). When it opened in 1883, the building provided space for a cutting room, space for two dozen sewing machines, a trimming room, laundry room, ironing room, a shipping room, and an office. The building also showcased steam heat and gas lighting.

By the mid-1880s, Wilder Brothers employed approximately 100 people, and began producing women's garments. At the end of the decade, the business was one of the largest of its kind in the nation devoted to made to order shirts and garments. However, by the late 1890s, business began to decline due to a lack of effort to modernize. Charles passed away in 1899, and by 1917, J.F. sold the business to Rahn & Lyman, who then removed the plants to Topeka. Wilder then sold his two Indiana Street residences, the Wilder Brothers factory building and grounds, plus land in Western Kansas, to his son-in-law, John McCurdy, and John's brother, Charles.

643 Indiana Street was owned by J.F. Wilder for approximately twenty-two years. Following the sale of the house in 1917, J.F. lived with Charles McCurdy until passing away in May 1918. In the 1920s, the house was home to Rumsey Brothers Funeral Home, and later was supposedly operated as a boarding house before being converted back to a single-family residence. From 1940 to 1975, the house was home to Carroll and Pearl Clark. Mrs. Clark is known for founding the Old West Lawrence Association.

**APPLICATION FOR LANDMARK DESIGNATION IN THE LAWRENCE REGISTER OF
HISTORIC PLACES**

643 Indiana Street
Lawrence, Kansas 66044

Alterations According to Property Owner

The garage and back driveway were constructed in 1987. There previously was a barn in the back, but the current owners understand that it burned down at some point. The current owners reconstructed the south porch in 1994. It originally had a roof on it. They also reconstructed the whole back porch area in early 2000's to extend a landing for the lift to connect with. Mark Russell did the plans for each of these projects and aimed to keep the reconstruction as consistent as possible with the original. Additionally, a patio area was constructed in 1994.

Kansas State Historical Society
Historic Sites Survey

HISTORIC BUILDING INVENTORY FORM

SEE INSTRUCTIONS

1. NAME				
COMMON: <u>Clark Residence</u>				
AND/OR HISTORIC:				
2. LOCATION				
STREET AND NUMBER: <u>643 Indiana</u>				
CITY OR TOWN: <u>Lawrence</u>			CONGRESSIONAL DISTRICT:	
STATE: <u>Ks.</u>		CODE:	COUNTY: <u>Douglas</u>	CODE:
3. CLASSIFICATION				
CATEGORY (Check One) <input type="checkbox"/> District <input checked="" type="checkbox"/> Building <input type="checkbox"/> Site <input type="checkbox"/> Structure <input type="checkbox"/> Object		OWNERSHIP <input type="checkbox"/> Public Public Acquisition: <input checked="" type="checkbox"/> Private <input type="checkbox"/> In Process <input type="checkbox"/> Both <input type="checkbox"/> Being Considered		STATUS <input checked="" type="checkbox"/> Occupied <input type="checkbox"/> Unoccupied <input type="checkbox"/> Preservation work in progress
ACCESSIBLE TO THE PUBLIC Yes: <input checked="" type="checkbox"/> Restricted <input type="checkbox"/> Unrestricted <input type="checkbox"/> No				
PRESENT USE (Check One or More as Appropriate).				
<input type="checkbox"/> Agricultural	<input type="checkbox"/> Government	<input type="checkbox"/> Park	<input type="checkbox"/> Transportation	<input type="checkbox"/> Comments
<input type="checkbox"/> Commercial	<input type="checkbox"/> Industrial	<input checked="" type="checkbox"/> Private Residence	<input type="checkbox"/> Other (Specify)	
<input type="checkbox"/> Educational	<input type="checkbox"/> Military	<input type="checkbox"/> Religious		
<input type="checkbox"/> Entertainment	<input type="checkbox"/> Museum	<input type="checkbox"/> Scientific		
4. OWNER OF PROPERTY				
OWNER'S NAME: <u>Mr. & Mrs. Carroll D. Clark</u>				
STREET AND NUMBER: <u>same</u>				
CITY OR TOWN:			STATE:	CODE:
5. LOCATION OF LEGAL DESCRIPTION				
COURTHOUSE, REGISTRY OF DEEDS, ETC:				
STREET AND NUMBER:				
CITY OR TOWN:			STATE:	CODE:
6. REPRESENTATION IN EXISTING SURVEYS				
TITLE OF SURVEY: <u>Inventory of Historic Sites</u>				
DATE OF SURVEY: <u>1976</u> <input type="checkbox"/> Federal <input type="checkbox"/> State <input checked="" type="checkbox"/> County <input type="checkbox"/> Local				
DEPOSITORY FOR SURVEY RECORDS: <u>Kansas State Historical Society</u>				
STREET AND NUMBER: <u>120 W 10th</u>				
CITY OR TOWN: <u>Topeka, Ks.</u>			STATE:	CODE:

Topeka, Ks. 66612

7 DESCRIPTION

CONDITION

☐ Excellent☒ Good☐ Fair(Check One)
☐ Deteriorated☐ Ruins☐ Unexposed

(Check One)

☐ Altered☒ Unaltered

(Check One)

☐ Moved☒ Original SitePresent appearance: *Same as original*Number of stories 3 Basement yes Length 70' Width 50' Height 50'

Foundation material:

Exterior wall material: *White wooden lap siding + dark green wooden shingles*

Color of exterior:

Type (shape) of roof: *Pitched*Color of roof: *Dark green*Roof materials: *Asphalt shingles*Windows: material, form *wood frames painted white, clear glass. Frame on screens are gray. Ornate cut glass above main window on S.E. corner of window.*Doors: materials, form *Main entr. - single, wood, varnished with ornate frosted glass + prism edge glass.*Lintels and sills: type, shape, material *Wood*Eaves and cornice: *Case has ornate work of exposed rafters + support members.*

Chief exterior features: (towers, turrets, bays, porches, entrances, unusual detailing)

*Large porch enclosed the front portion of the house, ornate wood features.*Architectural style: *Victorian*Explain how the present exterior appearance differs from the original.
What additions and alterations have been made?

SEE INSTRUCTIONS

SEE INSTRUCTIONS

SIGNIFICANCE

PERIOD (Check One or More as Appropriate)

☐ Pre-Columbian

☐ 16th Century

☐ 18th Century

☐ 20th Century

☐ 15th Century

☐ 17th Century

☐ 19th Century

SPECIFIC DATE(S) (If Applicable and Known) 1890's

AREAS OF SIGNIFICANCE (Check One or More as Appropriate)

Aboriginal

☐ Prehistoric

☐ Historic

☐ Agriculture

☐ Architecture

☐ Art

☐ Commerce

☐ Communications

☐ Conservation

☐ Education

☐ Engineering

☐ Industry

☐ Invention

☐ Landscape

☐ Architecture

☐ Literature

☐ Military

☐ Music

☐ Political

☐ Religion/Phi-

losophy

☐ Science

☐ Sculpture

☐ Social/Human-

itarian

☐ Theater

☐ Transportation

☐ Urban Planning

☐ Other (Specify)

☒ Western Settlement

Date of construction:

Architect:

Builder:

Cost:

Other construction data:

First occupant:

Original usage: Residence

Other occupants, if known:

Other usages, if any:

Present use: Residence

Future plans, if known:

Reason(s) the place is significant:

9. MAJOR BIBLIOGRAPHICAL REFERENCES

Local contact person:

Written sources:

10. GEOGRAPHICAL DATA

Sketch Map: Draw a map showing the building or site in relationship to streets or roads. Label all streets and include a north arrow.

Sketch the shape of the building, indicating porches, additions, and entrances. Include north arrow.

Acreage:

Outbuildings:

Neighborhood, or environment:

Is the property endangered? If so, by what?

11. FORM PREPARED BY

NAME AND TITLE:

ORGANIZATION

DATE

1976

STREET AND NUMBER:

CITY OR TOWN:

STATE

CODE

633 Indiana Street (continued)

agent, J. R. Holmes) and his wife Mary I. (1923, 1925/26); Edward F. Sullivan (binder, KU Library) and his wife L. Margaret (1927/28, 1929/30). The dwelling was recorded on the 1927 Sanborn Map. Ed Scheurick Construction was issued a building permit (#18680) to remodel the dwelling on 1/21/1983.

Two story, cross gable, brick Folk House National dwelling on rusticated stone foundation. Entrance to dwelling is located in north end of facade. A two story, clapboard sheathed gable addition projects from north elevation. Chamfered column porch projects from east elevation of addition. Clapboard sheathed, flat roofed second story above porch. A concrete walk leads from public sidewalk to two concrete steps at building entrance. One and a half story, end-gable garage located on SW corner of property. Garage entrance located in south elevation. Fenestration in gable ends.

637 Indiana Street (244) Contributing

The property was recorded as unimproved in the 1873 Atlas of DG Co. A significant increase in property tax valuation occurred in 1908 when E. F. Rogers was the owner of record. In 1908/09, 1911, 1913/14, 1915, and 1917 J. Frank Wilder (Wilder Bros. Steam Laundry, Shirt Mnfg. & Mens Furnishings, 612 N.H.) and his wife Abbie were listed as residents of this location. Oscar D. Moore (contractor, 637 Indiana) and his wife Lenora were listed as occupants in 1919. In 1923, 1925/26, and 1927/28 Harry L. Kane (prop., Kane's Cash Grocery, 904 Mass.) and his wife Mella M. were listed as residents. Harry Kane was listed as the owner of the property in 1923, 1925/26, and 1927/28. Lawrence Kane was also listed as a resident in 1927/28. By 1929/30 Mella M. Kane (widow of Harry) was listed as owner and occupant. The dwelling was recorded on the 1927 Sanborn Map.

Two story, gambrel with cross gable, frame Colonial Revival dwelling on rusticated stone foundation. Entrance to dwelling is located under southeast corner of gambrel. A flat roof porch supported by Tuscan columns on rusticated stone piers projects from east end of south elevation. A brick chimney pierces roof centrally. Clapboards sheathe first story, shingles sheathe second story. A gable dormer projects from south roof slope above porch. A concrete walk leads from public sidewalk to two concrete steps at entrance. A concrete driveway runs along south edge of property.

643 Indiana Street (245) Key contributing

J. F. Wilder was the owner of record when a significant increase in property tax valuation occurred in 1895. James Frank Wilder (Wilder Bros. Shirt Mnfg. & Steam Laundry, 612 N. H.) was listed as residing at this address in 1896, 1898, 1900/01, 1902/03, 1905, and 1907. James Frank Wilder was listed as the treas., Atlas B. & L. Association in 1898 and the director of the Lawrence National Bank in 1900/01. Mrs. Abbie Wilder (wife of J. F.) was listed as resident in 1898 through 1907. In 1911 Whitsed C. Laming, his wife Mattie, Foster Laming, and Edith Laming (student, KU) were listed as residents of this address. Edwin S. Peckham (pres., Peckham Clothing Co., 807 Mass.) and his wife Marie were listed as occupants in 1913/14, 1915, 1917 and 1919. In 1923, 1925/26, 1927/28 and 1929/30 the Rumsey Bros. Funeral Home, Ambulance Service & Undertakers were listed at this address. In addition, Charles B. Rumsey, his wife Mabel and Mrs. Delia C. Rumsey (widow of Lawson) were also listed as residents in 1923, 1925/26, 1927/28, and 1929/30. The dwelling was recorded on the 1927 Sanborn map. Natural Breeze was issued a building permit (#24731) to remodel the dwelling on 8/28/1987.

Kan. Cong. Dist. No. 3
Larry Winn
Form 10-300
(July 1969)

UNITED STATES DEPARTMENT OF THE INTERIOR
NATIONAL PARK SERVICE

NATIONAL REGISTER OF HISTORIC PLACES
INVENTORY - NOMINATION FORM

(Type all entries - complete applicable sections)

STATE: Kansas	
COUNTY: Douglas	
FOR NPS USE ONLY	
ENTRY NUMBER	DATE

1. NAME	
COMMON: Old West Lawrence Historic District	
AND/OR HISTORIC:	

2. LOCATION			
STREET AND NUMBER: Boundaries as marked on map (see continuation sheet)			
CITY OR TOWN: Lawrence			
STATE Kansas	CODE 66044	COUNTY: Douglas	CODE 045

3. CLASSIFICATION			
CATEGORY (Check One)	OWNERSHIP	STATUS	ACCESSIBLE TO THE PUBLIC
<input checked="" type="checkbox"/> District <input type="checkbox"/> Building <input type="checkbox"/> Site <input type="checkbox"/> Structure <input type="checkbox"/> Object	<input type="checkbox"/> Public <input checked="" type="checkbox"/> Private <input type="checkbox"/> Both	<input checked="" type="checkbox"/> Occupied <input type="checkbox"/> Unoccupied <input type="checkbox"/> Preservation work in progress	Yes: <input checked="" type="checkbox"/> Restricted <input type="checkbox"/> Unrestricted <input type="checkbox"/> No
PRESENT USE (Check One or More as Appropriate)			
<input type="checkbox"/> Agricultural <input type="checkbox"/> Commercial <input type="checkbox"/> Educational <input type="checkbox"/> Entertainment	<input type="checkbox"/> Government <input type="checkbox"/> Industrial <input type="checkbox"/> Military <input type="checkbox"/> Museum	<input type="checkbox"/> Park <input checked="" type="checkbox"/> Private Residence <input type="checkbox"/> Religious <input type="checkbox"/> Scientific	<input type="checkbox"/> Transportation <input checked="" type="checkbox"/> Other (Specify) Apartments

4. OWNER OF PROPERTY	
OWNER'S NAME: Multiple Private	
STREET AND NUMBER:	
CITY OR TOWN:	STATE: Kansas

5. LOCATION OF LEGAL DESCRIPTION	
COURTHOUSE, REGISTRY OF DEEDS, ETC: Register of Deeds	
STREET AND NUMBER: Douglas County Courthouse	
CITY OR TOWN: Lawrence	STATE: Kansas

6. REPRESENTATION IN EXISTING SURVEYS	
TITLE OF SURVEY: None	
DATE OF SURVEY: <input type="checkbox"/> Federal <input type="checkbox"/> State <input type="checkbox"/> County <input type="checkbox"/> Local	
DEPOSITORY FOR SURVEY RECORDS:	
STREET AND NUMBER:	
CITY OR TOWN:	STATE: Kansas

STATE: Kansas	COUNTY: Douglas
ENTRY NUMBER	DATE
FOR NPS USE ONLY	

SEE INSTRUCTIONS

3. SIGNIFICANCE

PERIOD (Check One or More as Appropriate)

- ☐ Pre-Columbian ☐ 16th Century ☐ 18th Century ☒ 20th Century
☐ 15th Century ☐ 17th Century ☒ 19th Century

SPECIFIC DATE(S) (If Applicable and Known)

AREAS OF SIGNIFICANCE (Check One or More as Appropriate)

- | | | | |
|--|--------------------------------------|---|--|
| <input type="checkbox"/> Aboriginal | <input type="checkbox"/> Education | <input type="checkbox"/> Political | <input type="checkbox"/> Urban Planning |
| <input type="checkbox"/> Prehistoric | <input type="checkbox"/> Engineering | <input type="checkbox"/> Religion/Phi- | <input type="checkbox"/> Other (Specify) |
| <input type="checkbox"/> Historic | <input type="checkbox"/> Industry | losophy | |
| <input type="checkbox"/> Agriculture | <input type="checkbox"/> Invention | <input type="checkbox"/> Science | |
| <input checked="" type="checkbox"/> Architecture | <input type="checkbox"/> Landscape | <input type="checkbox"/> Sculpture | |
| <input type="checkbox"/> Art | Architecture | <input type="checkbox"/> Social/Human- | |
| <input type="checkbox"/> Commerce | <input type="checkbox"/> Literature | itarian | |
| <input type="checkbox"/> Communications | <input type="checkbox"/> Military | <input type="checkbox"/> Theater | |
| <input type="checkbox"/> Conservation | <input type="checkbox"/> Music | <input type="checkbox"/> Transportation | |

STATEMENT OF SIGNIFICANCE

Subsequent to the passage of the Kansas-Nebraska Act in 1854, organizations were formed in New England to encourage and assist the emigration to Kansas of people opposed to the expansion of slavery. The New England Emigrant Aid Association sent Charles H. Branscomb and Charles Robinson (later the first governor of the state) to locate a suitable site for a settlement. They were soon followed by the first group of 29 settlers who arrived at the present location of Lawrence on August 1, 1854, and camped on a hill which they named Mount Oread after a seminary in Massachusetts. (It was on this site that the University of Kansas was later established.) After a day or two the group moved on to the town site and pitched their tents on what is now the west side of Massachusetts street. After the arrival of a second group of 114 in September, the two groups united and organized a town association on September 18, taking the name of their new city from Amos A. Lawrence, one of the trustees of the Emigrant Aid Association.

A. D. Searle started to survey the town site on September 25. Trustees were selected on October 9 to guide the affairs of the Lawrence Association, and on October 17 the members of the association drew for city lots. Construction of simple buildings began immediately thereafter.

Lawrence was the main center of Free State thinking and leadership in Kansas Territory, and as such it was often the focal point for the hatreds and violence of Proslavery settlers and Missouri "Border Ruffians." The city and its inhabitants were several times threatened with destruction and death by besieging forces of irregulars. The government of the territory was controlled by the Proslavery element and created all possible hardships for the Free State people in Lawrence. On May 1, 1856, a Proslavery force burned a number of buildings, destroyed the printing presses of Free State publications and plundered the town.

Perhaps the most infamous event in the history of Lawrence was the raid by Quantrill's guerillas on August 21, 1863. The citizens of Lawrence were caught off guard and generally without the means at hand to defend themselves. Approximately 143 people were murdered and another 30 seriously wounded. The raiders, according to survivors' accounts, passed by those who offered armed resistance and claimed the defenseless for their victims. Almost the entire business district

7. DESCRIPTION

CONDITION	(Check One)					
	<input type="checkbox"/> Excellent	<input checked="" type="checkbox"/> Good	<input type="checkbox"/> Fair	<input type="checkbox"/> Deteriorated	<input type="checkbox"/> Ruins	<input type="checkbox"/> Unexposed
	(Check One)			(Check One)		
	<input checked="" type="checkbox"/> Altered	<input type="checkbox"/> Unaltered	<input type="checkbox"/> Moved	<input checked="" type="checkbox"/> Original Site		

DESCRIBE THE PRESENT AND ORIGINAL (if known) PHYSICAL APPEARANCE

The Old West Lawrence Historic District encompasses all or parts of 12 city blocks near the center of Lawrence, Kansas. The major portion of the district lies in six city blocks bordered on the north by Sixth street, on the east by Tennessee, on the south by Eighth street and on the west by Indiana. Included in this residential neighborhood are about 50 residential structures of distinction.

The houses in the district reflect the distinctive characteristics of late 19th century Kansas architecture. A mixture of styles typical of this era in Kansas history as well as a cross section of building materials in common use can be found in the district. The district contains a significant and very distinguishable blending of style, form, character and construction. Examples of Victorian style, Eclectic assemblages, Italianate Renaissance style, and simple utilitarian Frontier architecture exist in peaceful coexistence in this area. Building materials range from massive stone masonry through brick construction to wood framing replete with intricate pattern and scroll designs embellishing stately two and three story mansions. Magnificent porches, soaring towers and bay windows typical of the period of construction are visible everywhere.

The fine structures are further enhanced by understanding site development and landscaping, establishing a dignity not readily found in today's residential communities. The close proximity of so many important houses and the fine care they have received make this district outstanding.

Restoration and preservation of many of the buildings, notably by their owners, has helped to revive interest in the district's potential by showing both the financial feasibility and the architectural merit of such improvements. There has been virtually no unsympathetic renovation.

Concern for the integrity of the district recently inspired the area residents to petition the city not to replace their original brick paved streets with modern concrete.

This district is the most unique collection of period residences in Kansas and by virtue of its breadth of architectural styles and building materials becomes a significant segment in the architectural heritage of the state.

SEE INSTRUCTIONS

UNITED STATES DEPARTMENT OF THE INTERIOR
NATIONAL PARK SERVICE

NATIONAL REGISTER OF HISTORIC PLACES
INVENTORY - NOMINATION FORM

(Continuation Sheet) No. 1

STATE	
Kansas	
COUNTY	
Douglas	
FOR NPS USE ONLY	
ENTRY NUMBER	DATE

(Number all entries)

2. The boundaries of the Old West Lawrence Historic District are as follows:

From the midpoint of the intersection of Tennessee and Sixth streets, the boundary runs south down the center of Tennessee street to a point about 392 feet south of the midpoint of the Eighth street intersection, then west to the alley west of Tennessee and north up the center of the alley to the middle of Eighth street, then one-half block west to the midpoint of the Eighth street-Ohio street intersection and south down Ohio about 140 feet, then west to the alley west of Ohio street and south down the alley about 85 feet, then west to the center of Louisiana street and north 85 feet, then west one and one-half blocks to the center of the alley west of Indiana street (which is the southwest corner of the district), then north up the center of the alley approximately two blocks to a point about 100 feet south of the east-west alley, then east across Indiana to the next alley, north to the center of Sixth street, and east two and one-half blocks to the beginning point.

8. was looted and burned to the ground. Nearly 100 homes were destroyed and most of the others were looted. Slowly the grief-stricken survivors came to grips with the situation and began to clean up and rebuild. Indicative of their spirit was the attitude reflected in a sign on a harness shop: "Established 1855; stood the drought of 1860; totally destroyed in 1863; defies all competition in 1864."

The end of the Civil War brought new settlers, economic recovery and a building boom. At the time of Quantrill's raid the main residential area was east of Massachusetts street. After the war an area west of Massachusetts became the fashionable part of town where many of the prominent and prosperous built their large homes. The neighborhood now designated as the Old West Lawrence Historic District was included in this post Civil War residential development and is the only part of it which has withstood the encroachments of business, university and multiple family housing.

Although all of what is now the Old West Lawrence Historic District was included in the October, 1854, survey map of Lawrence City by A. D. Searle, not all of the district was in the original Lawrence townsite. Official plat maps show that several blocks are in Lane's First Addition. James Lane was one of the prominent Free State leaders in Lawrence and one of the first two United States senators from Kansas. Through the use of political influence Lane was able to acquire the land adjoining the original townsite on the

NATIONAL REGISTER OF HISTORIC PLACES
INVENTORY - NOMINATION FORM

(Continuation Sheet) No. 2

STATE	
Kansas	
COUNTY	
Douglas	
FOR NPS USE ONLY	
ENTRY NUMBER	DATE

(Number all entries)

8. west. He had a previously granted patent invalidated and then claimed the land for himself. (Lane shot and killed Gaius Jenkins on June 3, 1858, in a dispute over this claim.) Lane's First Addition was developed as the city expanded westward after the Civil War.

The great majority of the homes in the Old West Lawrence Historic District were erected between 1870 and 1920, although examples can be found outside both dates. Several of the stone houses in the Vernacular style were built in the early 1860's, and at least one--646 Louisiana--was burned by Quantrill's raiders and later rebuilt. Predominant in the district are the frame or brick Italianate homes of the late 1860's and 1870's. Many of the homes built at the end of the 19th century are large pretentious structures in the Victorian Baroque style. Although houses of later construction can be found in the district, they blend into the neighborhood and do not detract from the atmosphere created by the older, more ornate homes.

The homeowners of this neighborhood take pride in their fine old homes and have united to form the Old West Lawrence Association. Street signs have been placed identifying the area as Old West Lawrence. (The area thus identified is larger than the historic district; the boundaries of the district were drawn after careful on-the-scene study showed that the organization included a number of blocks which had some modern commercial buildings and other structures out of keeping with the general atmosphere of a historic residential district.) One of the primary purposes of the association is to block attempts fostered by various commercial interests to change the city zoning ordinances to permit business and apartment development in the neighborhood.

The Old West Lawrence Historic District is important to the heritage of the city of Lawrence and the state of Kansas. Architecturally, this neighborhood demonstrates the development and transition of Kansas residential styles from the 1860's to the early 20th century. No other neighborhood in the state has yet been identified where such a large number of 19th century homes still stand in excellent condition and without detrimental encroachments by businesses and modern housing developments.

9. Cordley, Richard, A History of Lawrence, Kansas (Lawrence, Lawrence Journal Press, 1895).
- Crafton, Allen, Free State Fortress (Lawrence, The World Co., 1954).
- Frontier of Freedom: A Story of Lawrence (Lawrence, The World Co., 1955).
- Gladstone, Thomas H., Kansas; or Squatter Life and Border Warfare in the Far West (London, G. Routledge and Co., 1857), pp. 20-36.

9. MAJOR BIBLIOGRAPHICAL REFERENCES

Blackmar, Frank W., "The Annals of an Historic Town," Annual Report of the American Historical Association 1893 (Washington, D. C., Government Printing Office, 1894), pp. 486-499.

Bright, John D., editor, Kansas--The First Century (New York, Lewis Historical Publishing Co., 1956), pp. 121-128.

Caldwell, E. F., compiler, A Souvenir History of Lawrence, Kansas, 1898 (Kansas City, Mo., Lawton and Burnap, 1898).

Connelley, William E., editor, "The Lane-Jenkins Claim Contest," Kansas Historical Collections, v. 16 (1923-1925), pp. 21-176.

10. GEOGRAPHICAL DATA

LATITUDE AND LONGITUDE COORDINATES DEFINING A RECTANGLE LOCATING THE PROPERTY			LATITUDE AND LONGITUDE COORDINATES DEFINING THE CENTER POINT OF A PROPERTY OF LESS THAN TEN ACRES		
CORNER	LATITUDE	LONGITUDE			
	Degrees Minutes Seconds	Degrees Minutes Seconds	Degrees	Minutes	Seconds
NW	38° 58' 24"	95° 14' 36"			
NE	38° 58' 24"	95° 14' 21"			
SE	38° 58' 05"	95° 14' 21"			
SW	38° 58' 05"	95° 14' 36"			

APPROXIMATE ACREAGE OF NOMINATED PROPERTY: 40 acres

LIST ALL STATES AND COUNTIES FOR PROPERTIES OVERLAPPING STATE OR COUNTY BOUNDARIES

STATE:	CODE	COUNTY	CODE
STATE:	CODE	COUNTY:	CODE
STATE:	CODE	COUNTY:	CODE
STATE:	CODE	COUNTY:	CODE

11. FORM PREPARED BY

NAME AND TITLE: Richard D. Pankratz, Planner
Charles L. Hall, Architectural Consultant

ORGANIZATION: Kansas State Historical Society

DATE: October 14, 1971

STREET AND NUMBER: 120 West Tenth Street

CITY OR TOWN: Topeka

STATE: Kansas 66612

CODE: 20

12. STATE LIAISON OFFICER CERTIFICATION

As the designated State Liaison Officer for the National Historic Preservation Act of 1966 (Public Law 89-665), I hereby nominate this property for inclusion in the National Register and certify that it has been evaluated according to the criteria and procedures set forth by the National Park Service. The recommended level of significance of this nomination is:

National ☐ State ☒ Local ☐

Name

Nyle H. Miller

Title

Executive Secretary, Kansas
State Historical Society

Date

November 30, 1971

I hereby certify that this property is included in the National Register.

Chief, Office of Archeology and Historic Preservation

Date

ATTEST:

Keeper of The National Register

Date

SEE INSTRUCTIONS

NATIONAL REGISTER OF HISTORIC PLACES
INVENTORY - NOMINATION FORM

(Continuation Sheet) No. 3

STATE	
Kansas	
COUNTY	
Douglas	
FOR NPS USE ONLY	
ENTRY NUMBER	DATE

(Number all entries)

9. Holloway, J. N., History of Kansas (Lafayette, Indiana, James, Emmons and Co., 1868), pp. 317-338.
History of the State of Kansas (Chicago, A. T. Andreas, 1883), pp. 312-330.
Nineteenth Century Houses in Lawrence, Kansas (Lawrence, University of Kansas Museum of Art, 1968).
One Hundred Years of History Significant to Kansas (Lawrence, The World Co., 1954).
"Souvenir Program of the 75th Anniversary of the Founding of Lawrence" (Lawrence, the World Co., 1929).

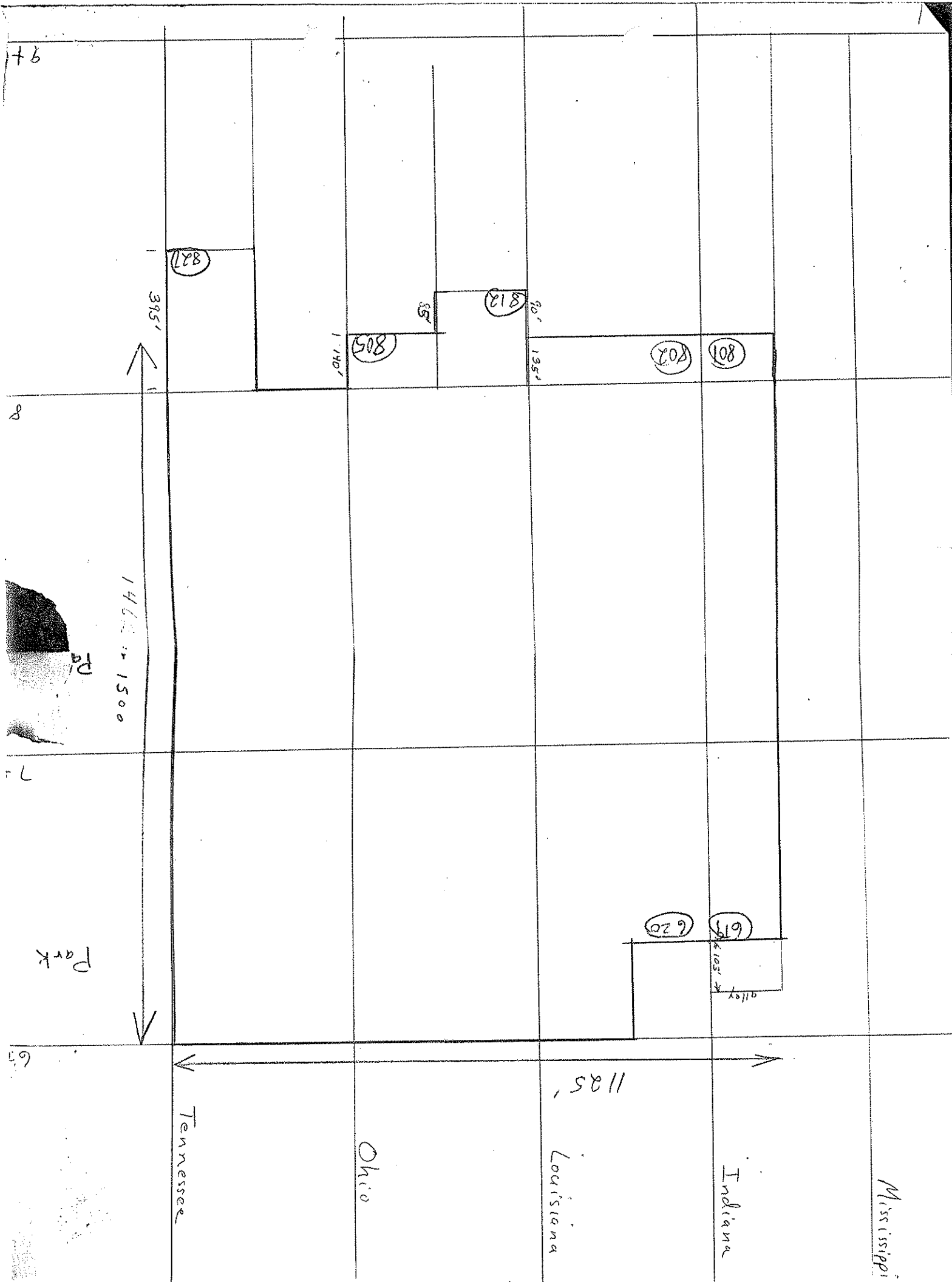

DOUGLAS COUNTY

OLD WEST LAWRENCE HIST. DIST.

045-3010-0028

600 Indiana	045-3010-0429**
601 Indiana	045-3010-0524** NC
612 Indiana	045-3010-0428** NC
615 Indiana	045-3010-0525**
617 Indiana	045-3010-0527**
620 Indiana	045-3010-0048
622 Indiana	045-3010-0426
623 Indiana	045-3010-0528
625 Indiana	045-3010-0529
630 Indiana	045-3010-0425
633 Indiana (Lanning House)	045-3010-0054
634 Indiana	045-3010-0424 NC
637 Indiana	045-3010-0531
638 Indiana	045-3010-0532 NC
640 Indiana	045-3010-0533 NC
643 Indiana (Clark House)	045-3010-0053
646 Indiana	045-3010-0536 NC
700 Indiana	045-3010-0447
703 Indiana	045-3010-0562 NC
704 Indiana	045-3010-0036
710 Indiana	045-3010-0039
711 Indiana (Van Vleck House)	045-3010-0052
718 Indiana	045-3010-0444 NC
720 Indiana	045-3010-0443
721 Indiana	045-3010-0564 NC
724 Indiana	045-3010-0038
728 Indiana	045-3010-0441
734 Indiana (Dodd House)	045-3010-0051
737 Indiana	045-3010-0034
742 Indiana (J.S. McKay House)	045-3010-0050
743 Indiana	045-3010-0566
746 Indiana	045-3010-0438
800 Indiana	045-3010-0537
801 Indiana (Anderson House)	045-3010-0071
808 Indiana	045-3010-0538**
809 Indiana	045-3010-0035**
812 Indiana	045-3010-0539**
815 Indiana	045-3010-0570**
816-818 Indiana	045-3010-0540** NC
817-817 1/2 Indiana	045-3010-0571** NC
820 Indiana	045-3010-0541**

** OLD WEST LAWRENCE RESURVEY AREA, NOT ON NR

OLD WEST LAWRENCE HISTORIC DISTRICT

821 Indiana	045-3010-0572**
824 Indiana	045-3010-0542** NC
825 Indiana	045-3010-0573** NC
828 Indiana	045-3010-0543** NC
829 Indiana	045-3010-0574**NC
833 Indiana	045-3010-0575** NC
836 Indiana	045-3010-0544** NC
837 Indiana	045-3010-0576**
846 Indiana	045-3010-0545** NC
847 Indiana	045-3010-0577** NC
600 Ohio	045-3010-0041
603 Ohio (Godwin House)	045-3010-0019
610 Ohio	045-3010-0671
615 Ohio (Phillip Reed House)	045-3010-0065
618 Ohio	045-3010-0673
620 Ohio	045-3010-0674
622 Ohio	045-3010-0675
625 Ohio	045-3010-0676
626 Ohio	045-3010-0677
627 Ohio (Wyatt House)	045-3010-0066
630 Ohio	045-3010-0678
631 Ohio	045-3010-0501
636 Ohio	045-3010-0679
637 Ohio	045-3010-0502
638 Ohio	045-3010-0680
640 Ohio	045-3010-0681
641 Ohio	045-3010-0503
645-645 1/2 Ohio	045-3010-0504
646 Ohio	045-3010-0682 NC
700 Ohio	045-3010-0683
701 Ohio	045-3010-0505
704 Ohio	045-3010-0684
705 Ohio	045-3010-0506
708 Ohio	045-3010-0685
709 Ohio	045-3010-0507
712 Ohio	045-3010-0686 NC
717 Ohio (Waid Apartments)	045-3010-0068
718 Ohio	045-3010-0687
720 Ohio	045-3010-0033
721 Ohio	045-3010-0509
725 Ohio	045-3010-0510
726 Ohio	045-3010-0589 NC
728 Ohio	045-3010-0727
729 Ohio	045-3010-0511
735 Ohio	045-3010-0512
738 Ohio	045-3010-0731 NC

** OLD WEST LAWRENCE RESURVEY AREA, NOT ON NR

OLD WEST LAWRENCE HISTORIC DISTRICT

739 Ohio	045-3010-0513
740 Ohio	045-3010-0690
742 Ohio	045-3010-0032
745 Ohio (Bess Stone Activity Center)	045-3010-0067
746 Ohio	045-3010-0692
800 Ohio	045-3010-0693
805 Ohio (Ragle House)	045-3010-0014
806 Ohio	045-3010-0694** NC
809-811 Ohio	045-3010-0516** NC
812 Ohio	045-3010-0695** NC
815-817 Ohio	045-3010-0517** NC
816 Ohio	045-3010-0696** NC
819 Ohio	045-3010-0518 **NC
820 Ohio	045-3010-0697** NC
821 Ohio	045-3010-0519**
824 Ohio	045-3010-0698**
825 Ohio	045-3010-0520**
828 Ohio	045-3010-0699 **NC
829 Ohio	045-3010-0418**
830 Ohio	045-3010-0700**
832 Ohio	045-3010-0701**
833 Ohio	045-3010-0419** NC
847 Ohio	045-3010-0420 **NC

600 Louisiana (Seaver House)	045-3010-0042
601 Louisiana (Town Manor Apartments)	045-3010-0029
607 Louisiana	045-3010-0468
608 Louisiana	045-3010-0469
612 Louisiana	045-3010-0470
615 Louisiana (R. Johnston House)	045-3010-0064
620 Louisiana	045-3010-0472
621 Louisiana	045-3010-0473
624 Louisiana	045-3010-0474
627 Louisiana	045-3010-0475
628 Louisiana	045-3010-0477
631 Louisiana	045-3010-0479
638 Louisiana (Johnson House)	045-3010-0063
641 Louisiana	045-3010-0481 NC
642 Louisiana	045-3010-0482
646 Louisiana	045-3010-0483 NC
701 Louisiana (Funk House)	045-3010-0016
702 Louisiana (Shumway House)	045-3010-0061
712 Louisiana	045-3010-0486
713 Louisiana (Pozdo House)	045-3010-0015
716 Louisiana	045-3010-0487
720 Louisiana	045-3010-0488
723 Louisiana (Lewis House)	045-3010-0005

** OLD WEST LAWRENCE RESURVEY AREA, NOT ON NR

OLD WEST LAWRENCE HISTORIC DISTRICT

726 Louisiana	045-3010-0043
731 Louisiana (Bonner House)	045-3010-0062
736 Louisiana	045-3010-0490
740 Louisiana	045-3010-0491
743 Louisiana	045-3010-0012
746 Louisiana	045-3010-0492
800 Louisiana	045-3010-0493 NC
801 Louisiana	045-3010-0448
804 Louisiana	045-3010-0494
809 Louisiana	045-3010-0449 **
812 Louisiana (Apartments)	045-3010-0030
813 Louisiana	045-3010-0450 **
817 Louisiana	045-3010-0451 NC **
818 Louisiana	045-3010-0496 NC **
820 Louisiana	045-3010-0497 **
821 Louisiana	045-3010-0452 **
824 Louisiana	045-3010-0498 NC **
825 Louisiana	045-3010-0453 **
828 Louisiana	045-3010-0499 **
831 Louisiana	045-3010-0454 NC **
832 Louisiana	045-3010-0423 **
835 Louisiana	045-3010-0455 **
838 Louisiana	045-3010-0421 **
841 Louisiana	045-3010-0456 NC **
842 Louisiana	045-3010-0422 NC **

603 Tennessee (Dr. Kimbrough House)	045-3010-0040
615 Tennessee (Wickberg House)	045-3010-0011
621 Tennessee	045-3010-0715
637 Tennessee	045-3010-0037
639 Tennessee (M.M. Penny House)	045-3010-0069
641-645 Tennessee (Penny House)	045-3010-0009
701 Tennessee	045-3010-0720
705 Tennessee	045-3010-0721
707 Tennessee	045-3010-0722
715 Tennessee	045-3010-0723
721 Tennessee	045-3010-0724
727 Tennessee	045-3010-0726
731 Tennessee	045-3010-0729
733 Tennessee	045-3010-0730
741 Tennessee	045-3010-0732
745 Tennessee	045-3010-0733
801 Tennessee (Rankin House)	045-3010-0070
815 Tennessee	045-3010-0736
817 Tennessee	045-3010-0737
821 Tennessee	045-3010-0738
827 Tennessee	045-3010-0740

** OLD WEST LAWRENCE RESURVEY AREA, NOT ON NR

OLD WEST LAWRENCE HISTORIC DISTRICT

831 Tennessee	045-3010-0741**
833 Tennessee	045-3010-0742**
837-839 Tennessee	045-3010-0743** NC
847 Tennessee	045-3010-0744**NC
601-601 ½ Mississippi	045-3010-0591**
615 Mississippi	045-3010-0594**
621 Mississippi	045-3010-0597**
631 Mississippi	045-3010-0599**NC
632 Mississippi	045-3010-0600**
636 Mississippi	045-3010-0601**
639 Mississippi	045-3010-0602**
644 Mississippi	045-3010-0603**
645 Mississippi	045-3010-0604**
700 Mississippi	045-3010-0605**
705 Mississippi	045-3010-0606**NC
708 Mississippi	045-3010-0607**
709 Mississippi	045-3010-0608**
711 Mississippi	045-3010-0609**
714 Mississippi	045-3010-0611**
716 Mississippi	045-3010-0612**
717 Mississippi	045-3010-0613**
720 Mississippi	045-3010-0614**
721 Mississippi	045-3010-0615**
725 Mississippi	045-3010-0616**NC
726 Mississippi	045-3010-0617**
730 Mississippi	045-3010-0619**NC
733 Mississippi	045-3010-0620**
734 Mississippi	045-3010-0622**
736 Mississippi	045-3010-0625**NC
739-741 Mississippi	045-3010-0623**NC
740 Mississippi	045-3010-0624**
746 Mississippi	045-3010-0626**
800-802 Mississippi	045-3010-0627**NC
801 Mississippi	045-3010-0628**
805 Mississippi	045-3010-0629**
808 Mississippi	045-3010-0630**
812 Mississippi	045-3010-0631**
815 Mississippi	045-3010-0632**NC
816 Mississippi	045-3010-0633**
817 Mississippi	045-3010-0634**
820 Mississippi	045-3010-0635**
821 Mississippi	045-3010-0636**
824 Mississippi	045-3010-0637**NC
827 Mississippi	045-3010-0638**
828 Mississippi	045-3010-0639**NC

** OLD WEST LAWRENCE RESURVEY AREA, NOT ON NR

OLD WEST LAWRENCE HISTORIC DISTRICT

829 Mississippi	045-3010-0640**
839 Mississippi	045-3010-0641**
845 Mississippi	045-3010-0642**NC
615 W 8th	045-3010-0550
411 W 6th	045-3010-0553**
800-802 W 8th	045-3010-0560**NC
708 W 9th	045-3010-0561**NC
715 W 8th	045-3010-0559**

** OLD WEST LAWRENCE RESURVEY AREA, NOT ON NR

Boundaries for Old West Lawrence Historic District

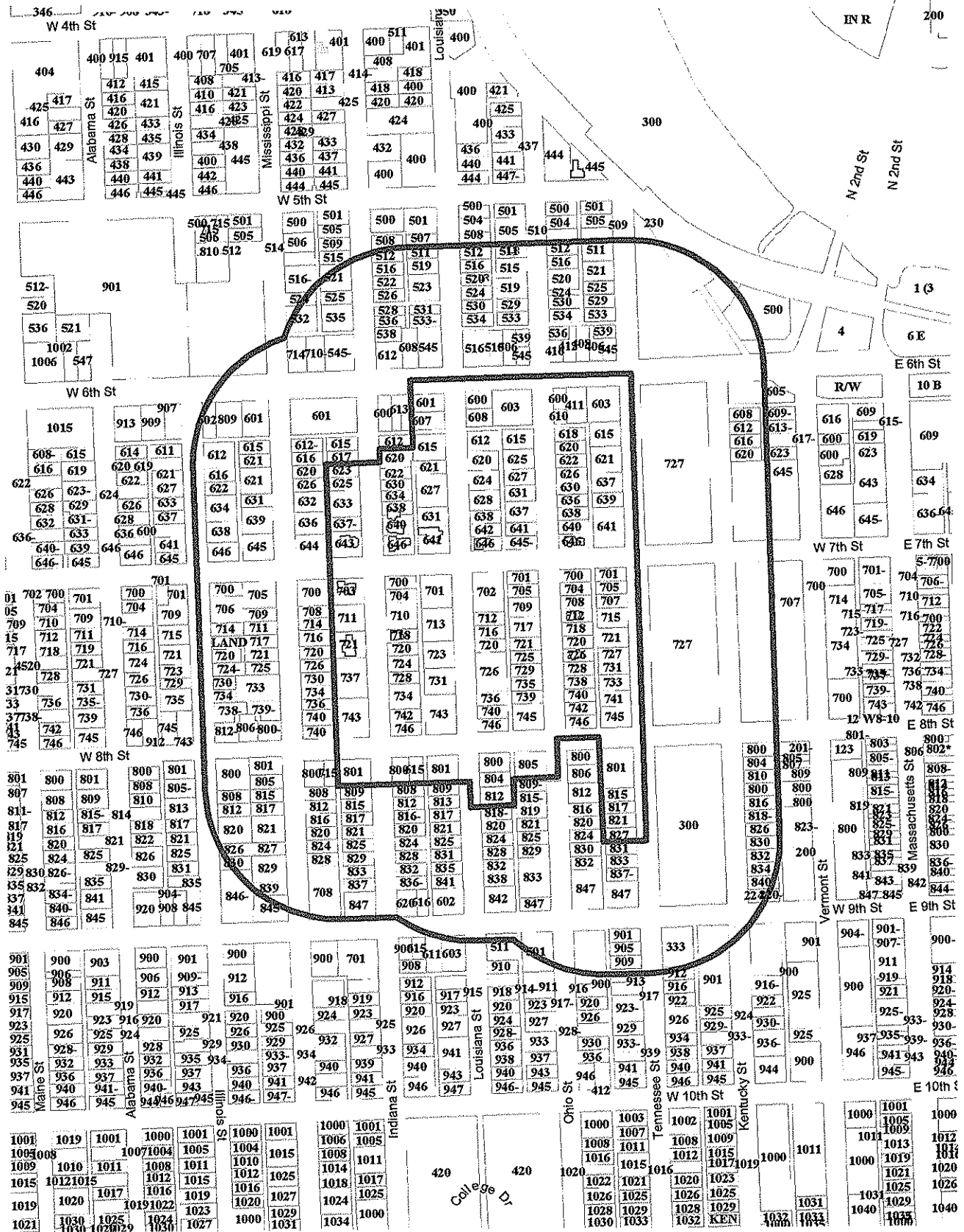

SR Kansas Register of Historic Places
 LR Lawrence Register of Historic Places
 NR National Register of Historic Places

14

Old West Lawrence Historic District

Douglas County

620 Indiana (Frank W. Cutter Residence) (C);
622 Indiana (R.C. Grittle Residence) (C);
623 Indiana (Henry Saunders Residence) (C);
625 Indiana (Jerry G Simmons Residence) (C);
630 Indiana (Charles W. Sparr House) (C);
633 Indiana (Lanning House) (C);
634 Indiana (P. Waldo Durr Residence) (NC);
637 Indiana (James Frank Wilder Residence) (C);
638 Indiana (Martz Residence) (NC);
640 Indiana (C.H. Cutter Residence) (NC);
643 Indiana (Clark House) (C);
646 Indiana (Wagner Residence) (NC);
700 Indiana (Charles Starkweather Residence) (C);
703 Indiana (Friedo Barteldes Residence) (NC);
704 Indiana (Alfred Athay Residence) (C);
710 Indiana (Herbert Bullene Residence) (C);
711 Indiana (Samuel Moore Residence(hist)/Piller Residence(common) (C);
718 Indiana (Louisa Barnes House) (NC);
720 Indiana (Frank Vaughn Residence) (C);
721 Indiana (Weakley Residence) (NC);
724 Indiana (Albert Fischer Residence) (C);
728 Indiana (Ada Kunkel Residence) (C);
734 Indiana (Dodds Residence) (C);
737 Indiana (Arthur D Weaver Residence) (C);
742 Indiana (J.S. McKay House) (C);
743 Indiana (Hiram Towne/Fischer Residence) (C);
746 Indiana (Joseph Windsor Residence) (C);
800 Indiana (W. Herbert Beatty Home) (C);
801 Indiana (Anderson Home) (C);
600 Ohio (H.N. Phelps Residence) (C);
603 Ohio (William T. Sinclair Home) (C);
610 Ohio (Anna Rowlands Residence) (C);
615 Ohio (Phillip Reed House) (C);
618 Ohio (Abe Levy Residence) (C);
620 Ohio (Wilder Metcalf Home) (C);
622 Ohio (Smith Residence) (C);
625 Ohio (David Robinson Residence) (C);
626 Ohio (Thomas Fitch Residence) (C);
627 Ohio (Wyatt House(common)/Henry Martin Residence(hist.) (C);
630 Ohio (Charles W Sparr Residence) (C);
631 Ohio (Francis W Jaedicke Home) (C);
636 Ohio (Lemuel King Residence) (C);
637 Ohio (Frank Webster Residence) (C);
638 Ohio (Francis W Jaedicke Residence) (C);

640 Ohio (James A. Flint Residence) (C);
641 Ohio (George Osborn Home) (C);
645-645 ½ Ohio (Elizabeth Simmons Residence) (C);
646 Ohio (Taylor Residence) (NC);
700 Ohio (F. Eggert Residence) (C);
701 Ohio (William Shale Residence) (C);
704 Ohio (Ridley Pearson Residence) (C);
705 Ohio (William E Spalding Residence) (C);
708 Ohio (J.G. Jeffries Home) (C);
709 Ohio (Samuel J. Churchill Residence) (C);
712 Ohio (NC);
717 Ohio (Hiram Towne Residence (hist.)/Waid Apartments(common) (C);
718 Ohio (Rankin Residence) (C);
720 Ohio (Charles Worthington Residence) (C);
721 Ohio (W.G. Melville Residence) (C);
725 Ohio (Wesley Callahan Residence) (C);
726 Ohio (NC);
728 Ohio (W.H. Nichols Residence) (C);
729 Ohio (Henry Martin Residence (hist.)/McMahon-Peterson Residence (common) (C);
735 Ohio (Early F. Huddleston Residence) (C);
738 Ohio (John Carlson Residence) (NC);
739 Ohio (David Watt Residence) (C);
740 Ohio (A.H. Whitcomb Residence) (C);
742 Ohio (Joseph McConnell Residence) (C);
745 Ohio (Theodore Poehler Residence (hist.)/Bess Stone Activity Center(common) (C);
746 Ohio (R.S. Griffith Residence) (C);
800 Ohio (Phillip H. Pierce Residence) (C);
805 Ohio (Jacob House Residence (hist.)/Ragle House(common) (C);
600 Louisiana (Nelson Stevens Residence (hist.)/Seaver House(common) (C);
601 Louisiana (Otto B. Gufler Residence) (C);
607 Louisiana (Max Wihelmi Jr. Residence) (C);
608 Louisiana (Myron Manley Residence) (C);
612 Louisiana (Isabella Osborn Residence) (C);
615 Louisiana (W.H. Abrams Residence (hist.)/R. Johnston House (common) (C);
620 Louisiana (Ross Residence)(C);
621 Louisiana (H.J. Taylor Residence) (C);
624 Louisiana (Ira Brown Residence) (C);
628 Louisiana (William H. Fleisher Residence) (C);
631 Louisiana (Elmer B Pearson Residence) (C);
638 Louisiana (Albert Knittle Residence) (C);
641 Louisiana (Samuel Pearson Residence) (NC);
642 Louisiana (Alonzo Young Residence) (C);
646 Louisiana (NC);
701 Louisiana (George Innes House) (C);
702 Louisiana (Alexander Marks Residence/Shumway Home) (C);
712 Louisiana (M.G. Beach Residence) (C);

713 Louisiana (Albert Henley Residence/Pozdo House) (C);
716 Louisiana (Frank W. Anderson Residence) (C);
720 Louisiana (Edward Jennings Residence) (C);
723 Louisiana (Lewis House) (C);
726 Louisiana (Solomon Marks Residence) (C);
731 Louisiana (William Bigger Residence/Bonner House) (C);
736 Louisiana (Hon. Samuel D Bishop Residence) (C);
740 Louisiana (William McKee Residence) (C);
743 Louisiana (John Sultiff Residence) (C);
746 Louisiana (Henry Rushner Residence) (C);
800 Louisiana (A.J. Anderson Residence) (C);
801 Louisiana (John Henley Residence) (C);
804 Louisiana (Edward R. Keith Residence) (C);
812 Louisiana (William S. Dick House) (C);
603 Tennessee (James Mitchell/Dr. Kimbrough House) (C);
615 Tennessee (Wickberg/Fuller House) (C);
621 Tennessee (Protsch Residence) (C);
637 Tennessee (James W. Green House) (C);
639 Tennessee (M.M. Penny House) (C);
641-645 Tennessee (Penny House) (C);
701 Tennessee (Jacob House Residence) (C);
705 Tennessee (William E. Spalding Residence) (C);
707 Tennessee (Willis E. Maynerd Residence) (C);
715 Tennessee (Gertrude & Janet Welch Residence) (C);
721 Tennessee (Fredrick H. Smithmeyer Residence) (C);
727 Tennessee (C);
731 Tennessee (C);
733 Tennessee (Frank Hester Residence) (C);
741 Tennessee (Mary Helen Harrison Residence) (C);
745 Tennessee (C);
801 Tennessee (Rankin House) (C);
815 Tennessee (C);
817 Tennessee (C);
821 Tennessee (C);
827 Tennessee (C);
615 W 8th St. (C);

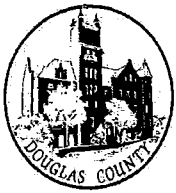

JAMIE SHEW
DOUGLAS COUNTY CLERK
1100 Massachusetts
Lawrence, KS 66044

Marni Penrod-Chief Deputy Clerk
Benjamin Lampe-Deputy Clerk Elections

December 10, 2015

A CERTIFIED PROPERTY OWNERSHIP LIST WITHIN 250 FT OF 643 INDIANA ST
(U04642A). 12/10/2015. REQUESTED BY LINDSAY CRICK.

JOHN R. NICHOLS
DOUGLAS COUNTY CLERK'S OFFICE
1100 MASSACHUSETTS ST
LAWRENCE, KS 66044

785-832-5147

jnichols@douglas-county.com

Douglas County Real Estate Division
County Clerk's Office. I do hereby certify
the Property Ownership listed hereto, to be
true and accurate.

JOINPIN	SYSCALACRE	owner1	owner2	address	city	state	zip	plate	PID	Quickrefid	situs
067-25-0-40-28-005.00-0	0.24173616	MILLER TIMOTHY A	DUTTON TAMARA L	620 INDIANA ST	LAWRENCE	KS	66044	U02237A	023-067-25-0-40-28-005.00-0	R4866	620 INDIANA ST
067-25-0-40-27-012.00-0	0.13432937	SWANSON MARK R	SWANSON KATHLEEN A	617 INDIANA ST	LAWRENCE	KS	66044	U02236	023-067-25-0-40-27-012.00-0	R4860	617 INDIANA ST
067-25-0-40-27-003.00-0	0.13431349	DETTBARN AUGUST J C	DETTBARN CANDACE E	PO BOX 1175	LAWRENCE	KS	66044	U02270	023-067-25-0-40-27-003.00-0	R4849	616 MISSISSIPPI ST
067-25-0-40-27-011.00-0	0.13434310	CARSON MARY F		623 INDIANA ST	LAWRENCE	KS	66044	U02238	023-067-25-0-40-27-011.00-0	R4859	623 INDIANA ST
067-25-0-40-27-004.00-0	0.13432702	SUTTON GRANT G		620 MISSISSIPPI ST	LAWRENCE	KS	66044	U02272	023-067-25-0-40-27-004.00-0	R4850	620 MISSISSIPPI ST
067-25-0-40-26-011.01-0	0.26861933	DETTBARN AUGUST J C Jr	DETTBARN CANDACE E	PO BOX 1175	LAWRENCE	KS	66044	U02271A	023-067-25-0-40-26-011.01-0	R4844	621 MISSISSIPPI ST
067-25-0-40-28-006.00-0	0.11129201	MILLER TIMOTHY A	DUTTON TAMARA L	620 INDIANA ST	LAWRENCE	KS	66044	U02241	023-067-25-0-40-28-006.00-0	R4867	622 INDIANA ST
067-25-0-40-28-012.00-0	0.33647217	ARENSBERG TOM	LARSON ANITA F	627 LOUISIANA ST	LAWRENCE	KS	66044	U02102	023-067-25-0-40-28-012.00-0	R4875	627 LOUISIANA ST
067-25-0-40-27-010.00-0	0.13435728	MASSAD JOHN P		1506 PARK AVE APT 1	BALTIMORE	MD	21217	U02240	023-067-25-0-40-27-010.00-0	R4858	625 INDIANA ST
067-25-0-40-27-005.00-0	0.13434146	STEWART MARY E	STEWART CLARENCE R JR	626 MISSISSIPPI ST	LAWRENCE	KS	66044	U02274	023-067-25-0-40-27-005.00-0	R4851	626 MISSISSIPPI ST
067-25-0-40-28-007.00-0	0.11296646	SEDLOCK CHARLES M	MESHEL LEDA C	1101 WAGON WHEEL RD	LAWRENCE	KS	66049	U02241-01A	023-067-25-0-40-28-007.00-0	R4868	630 INDIANA ST
067-25-0-40-27-009.00-0	0.26877058	ARNOLD THOMAS E	ARNOLD FRANCES A	633 INDIANA ST	LAWRENCE	KS	66044	U02242	023-067-25-0-40-27-009.00-0	R4857	633 INDIANA ST
067-25-0-40-27-006.00-0	0.20152584	KOUNAS NICK		787 E 1300 RD	LAWRENCE	KS	66046	U02276A	023-067-25-0-40-27-006.00-0	R4852	632 MISSISSIPPI ST
067-25-0-40-26-010.00-0	0.13433747	WEBB DEBRA R	WEBB ROSE E	910 RAYMOND PL	COLORADO SPRINGS	CO	80905	U02275	023-067-25-0-40-26-010.00-0	R4843	631 MISSISSIPPI ST
067-25-0-40-28-008.00-0	0.11218774	CARLSON HAROLD E JR	CAMPBELL LYNN M	2132 LEARNARD AVE	LAWRENCE	KS	66046	U02244A	023-067-25-0-40-28-008.00-0	R4869	634 INDIANA ST
067-25-0-40-26-009.00-0	0.26871580	LEHMANN MARK E	LEHMANN DIANA L	PO BOX 442200	LAWRENCE	KS	66044	U02277A	023-067-25-0-40-26-009.00-0	R4841	639 MISSISSIPPI ST
067-25-0-40-28-011.00-0	0.18561784	PINE DEBORAH J	ELDRIDGE MARK G	631 LOUISIANA ST	LAWRENCE	KS	66044	U02107-01A	023-067-25-0-40-28-011.00-0	R4873	631 LOUISIANA ST
067-25-0-40-28-009.00-0	0.13725373	MILLER TIMOTHY A	DUTTON TAMARA L	620 INDIANA ST	LAWRENCE	KS	66044	U02247A	023-067-25-0-40-28-009.00-0	R4870	638 INDIANA ST
067-25-0-40-27-007.00-0	0.22853978	WILSON JEFFREY T	STOCKETT MARIE L	636 MISSISSIPPI ST	LAWRENCE	KS	66044	U02278B	023-067-25-0-40-27-007.00-0	R4853	636 MISSISSIPPI ST
067-25-0-40-27-008.00-0	0.14515179	DILL MELANIE A	DILL RODNEY S	637 INDIANA ST	LAWRENCE	KS	66044	U02248A	023-067-25-0-40-27-008.00-0	R4855	637 INDIANA ST
067-25-0-40-28-010.00-0	0.13457365	KELLY JOHN H	KELLY SANGEETHA L	640 INDIANA ST	LAWRENCE	KS	66044	U02249-01A	023-067-25-0-40-28-010.00-0	R4871	640 INDIANA ST
067-25-0-40-28-011.01-0	0.28494126	HEDGES BLAKE A	HEDGES KRISTIN V	1037 VERMONT ST	LAWRENCE	KS	66044	U04638A	023-067-25-0-40-28-011.01-0	R4874	641 LOUISIANA ST
067-25-0-40-27-008.01-0	0.25807016	WATKINS DANIEL L	WATKINS PHYLLIS A	643 INDIANA ST	LAWRENCE	KS	66044	U04642A	023-067-25-0-40-27-008.01-0	R4856	643 INDIANA ST
067-25-0-40-26-009.01-0	0.26873375	FRYDMAN JOHN	MARTIN-FRYDMAN LAURIE	645 MISSISSIPPI ST	LAWRENCE	KS	66044	U04646A	023-067-25-0-40-26-009.01-0	R4842	645 MISSISSIPPI ST
067-25-0-40-27-007.01-0	0.24184472	RUPP GREGORY A	ROTH JENNIFER C	644 MISSISSIPPI ST	LAWRENCE	KS	66044	U04644A	023-067-25-0-40-27-007.01-0	R4854	644 MISSISSIPPI ST
067-25-0-40-28-010.01-0	0.19884226	WOLFE ESTHER		646 INDIANA ST	LAWRENCE	KS	66044	U04640A	023-067-25-0-40-28-010.01-0	R4872	646 INDIANA ST
067-36-0-10-16-001.00-0	0.33682319	LOOMIS BURDETT A	LOOMIS MICHEL T	701 LOUISIANA ST	LAWRENCE	KS	66044	U04690A	023-067-36-0-10-16-001.00-0	R7372	701 LOUISIANA ST

JOINPIN	SYSICALACRE	owner1	owner2	address	city	state	zip	plate	PID	Quickrefid	situs
067-36-0-10-16-002.00-0	0.13476044	WOLFE CONSTANCE	NOVOSEL JOHN JR	700 INDIANA ST	LAWRENCE	KS	66044	U04713	023-067-36-0-10-16-002.00-0	R7373	700 INDIANA ST
067-36-0-10-15-001.00-0	0.26936685	KRAHN JOSEPH		703 INDIANA ST	LAWRENCE	KS	66044	U04665	023-067-36-0-10-15-001.00-0	R7356	703 INDIANA ST
067-36-0-10-15-002.00-0	0.26932824	MORLEY MICHAEL T	CANDELA ANGELA C	700 MISSISSIPPI ST	LAWRENCE	KS	66044	U04688-01A	023-067-36-0-10-15-002.00-0	R7357	700 MISSISSIPPI ST
067-36-0-10-14-001.00-0	0.28723465	MURPHY HONORA C TRUSTEE		705 MISSISSIPPI ST	LAWRENCE	KS	66044	U04650A	023-067-36-0-10-14-001.00-0	R7335	705 MISSISSIPPI ST
067-36-0-10-16-003.00-0	0.13470540	CLARK STEVEN J	CLARK ELIZABETH B	704 INDIANA ST	LAWRENCE	KS	66044	U04712	023-067-36-0-10-16-003.00-0	R7374	704 INDIANA ST
067-36-0-10-16-004.00-0	0.26938558	TATE BRADFORD L	TATE SUSAN F	710 INDIANA ST	LAWRENCE	KS	66044	U04710A	023-067-36-0-10-16-004.00-0	R7375	710 INDIANA ST
067-36-0-10-15-017.00-0	0.26935958	PILLER LYNN	PILLER SALLY F	711 INDIANA ST	LAWRENCE	KS	66044	U04667A	023-067-36-0-10-15-017.00-0	R7371	711 INDIANA ST
067-36-0-10-15-004.00-0	0.11848478	GREEN LYNNE		708 MISSISSIPPI ST	LAWRENCE	KS	66044	U04688	023-067-36-0-10-15-004.00-0	R7358	708 MISSISSIPPI ST
067-36-0-10-15-005.00-0	0.12386459	KIRKENDALL ERIC D	KIRKENDALL MARY E	714 MISSISSIPPI ST	LAWRENCE	KS	66044	U04686	023-067-36-0-10-15-005.00-0	R7359	714 MISSISSIPPI ST
067-36-0-10-15-006.00-0	0.16155208	DOERCK ZABRINA	DOERCK JASON	716 MISSISSIPPI ST	LAWRENCE	KS	66044	U04684	023-067-36-0-10-15-006.00-0	R7360	716 MISSISSIPPI ST

POL WITHIN 250 FT OF 643 INDIANA ST (U04642A)

