

FHWA REG. NO.	STATE	PROJECT NO.	YEAR	SHEET NO.	TOTAL SHEETS
7	KANSAS	59-23 U-7777-??	2017	10	33

59-23 U-0318-01/PW1501

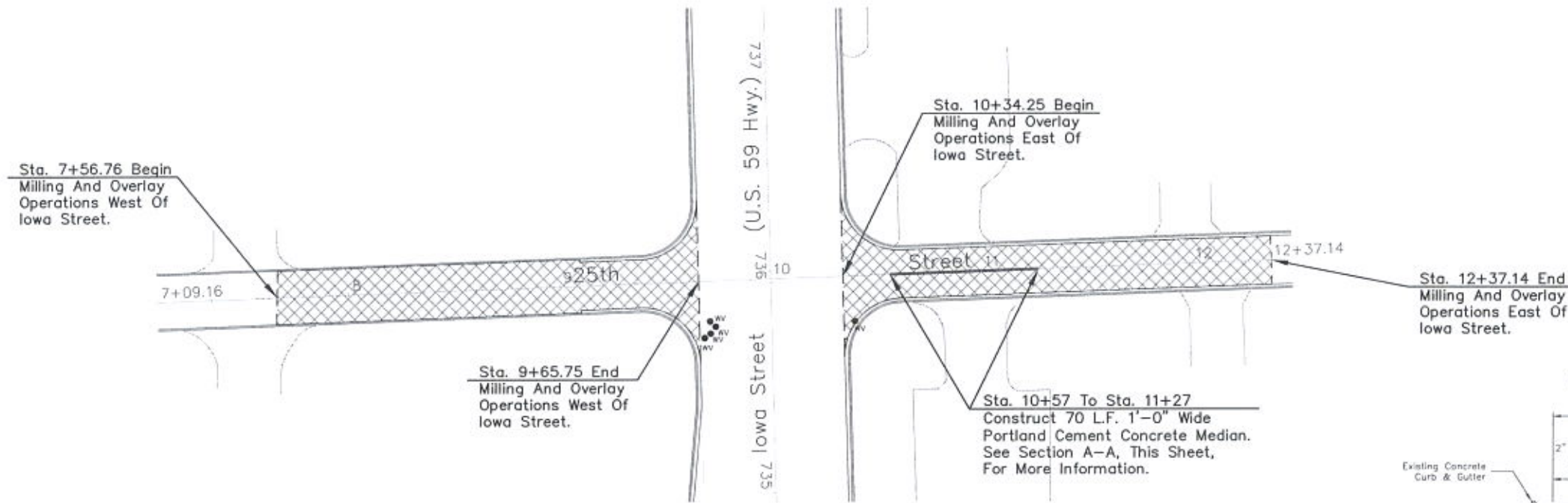

25TH STREET—EAST AND WEST OF IOWA STREET

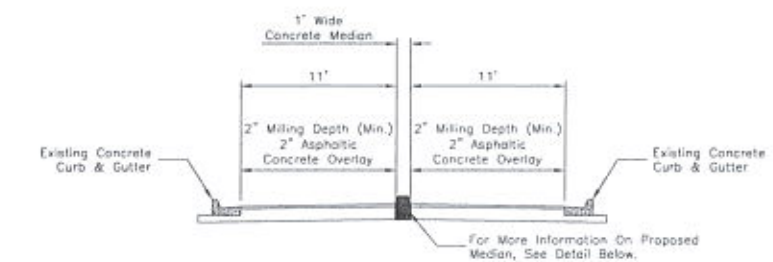

25TH STREET—EAST OF IOWA STREET
SECTION A-A

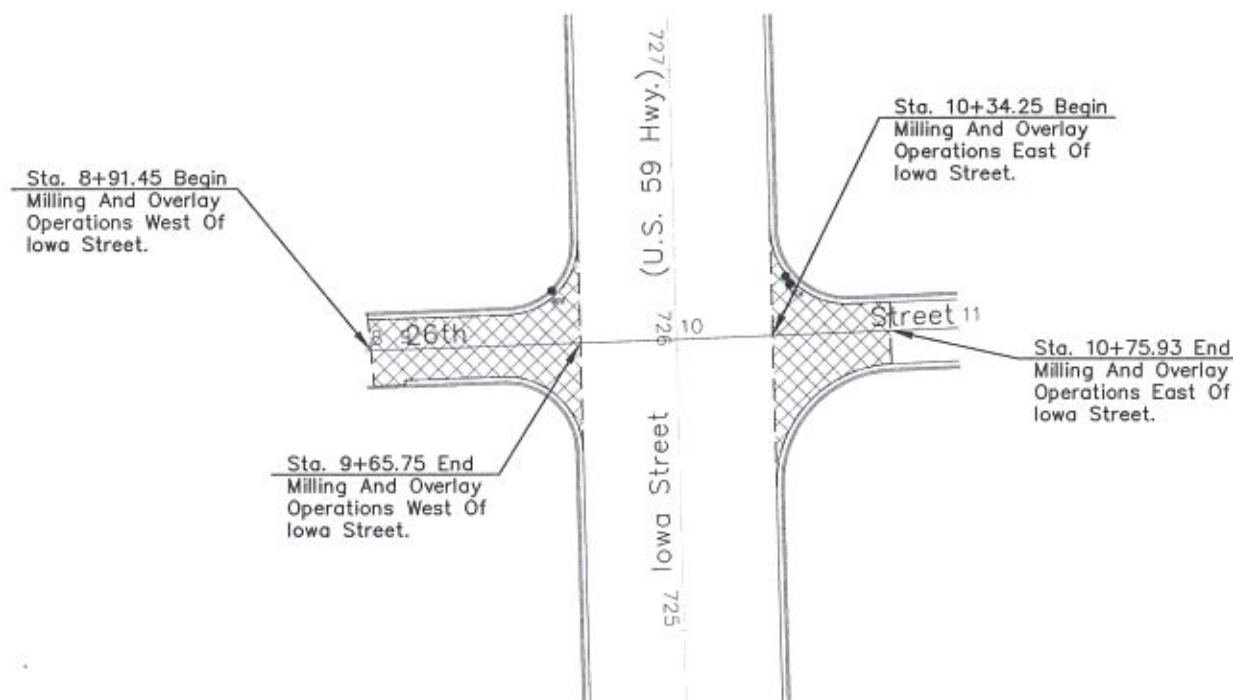

26TH STREET—EAST AND WEST OF IOWA STREET

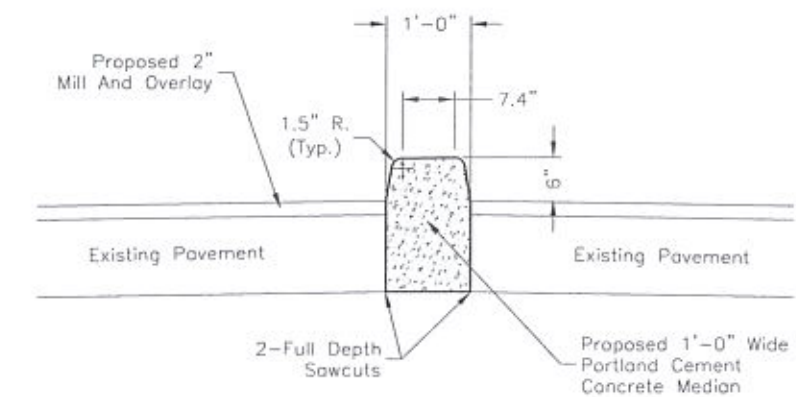

PROPOSED CONCRETE
MEDIAN DETAIL

NOTE: Pavement Dimensions Reflect Back Of Curb To Back Of Curb Widths

City Project No. PW1501

Milling and Overlay Location Map
25th Street and 26th Street
East and West Of Iowa Street

EXHIBIT A