



CITY OF LAWRENCE

REQUEST FOR QUALIFICATIONS (RFQ)

RFQ # Q1204

Purpose of RFQ: Public Art for the Lawrence Public Library Expansion Project

RFQ Description: The City of Lawrence, Kansas, is seeking an artist or art group to work collaboratively within the design process to develop innovative, original art for the Lawrence Public Library Expansion Project. The selection process will be in two phases, beginning with the submission of qualifications and a preliminary sketch and narrative outlining the artist's approach to the project. A group of finalists will be selected and invited to submit detailed proposals. All finalists will come to the Library for a site visit, interview, and presentation of their proposal. A selection will then be made for the final commission.

Department: City Manager's Office

Contacts: Diane Stoddard, Assistant City Manager

e-mail: dstoddard@lawrenceks.org

Phone: 785-832-3413

Site Visit Requirements: None. However, artists are encouraged to familiarize themselves with the Public Library Expansion Project and attend an informational meeting to be held on Thursday, August 30, 2012 at 7 pm at the Lawrence Public Library Auditorium, 707 Vermont Street. The informational meeting will provide a background on the project, current designs for the expansion, how art has been incorporated into other library projects and a review of the process to select the art for the project. The presentations from this meeting will be archived and available for viewing a few days after the meeting for those unable to attend in person.

Submit to: One electronic response to the RFQ will be required to be submitted via the City's website at: <http://lawks.us/percent-for-art>.

Due Date & Time: Friday, October 5, 2012 at 4 pm

Background on Library Expansion Project:

Lawrence has a strong public library tradition, and Lawrence's public library is one of the most well-used public services in the City of Lawrence. In an average year, over one million materials are checked out, and 30,000 to 40,000 people attend cultural events and programs. The current library was built in 1972, and the rate of growth in library use can no longer be contained in the current structure. In 2010, the citizens of Lawrence voted to expand the Library and increase the adjacent parking. Architectural renderings of the planned expansion are available at: <http://www.lawrence.lib.ks.us/just-for/renovation-construction/project-drawings/>

Design highlights:

- Expand the current facility by 20,000 square feet
- The building will utilize modern proportions: long, low horizontal forms. The exterior uses terracotta to retain the red brick nature of downtown
- Create a green space/civic plaza area outside the library for events and community gatherings. It may incorporate a water feature, seating.
- Provide more public meeting spaces, including study rooms, meeting rooms, and a larger auditorium for community programs
- Add a creative center with sound and video equipment and other technologies to support film, music, and other content creation by the public
- Double the size of the children's room, providing a space for children's classes
- Add 100 computers to support need for public access to computers and to provide more digital literacy training for the community
- A reading room that follows the perimeter of the building, envisioned as a reading zone for all ages that will utilize natural light from windows. Add a drive-up book drop and service window for customer convenience
- Make the library facility more energy- efficient to save money on utilities.
- Add a parking structure that increases the number of parking spaces from 126 to 250 to serve the library, pool, senior center, and downtown

Library Vision for Art: Lawrence Public Library exhibits artwork at every level of experience; the library provides space where local artists and groups can share their creative expression in a public venue, from school groups to senior clubs to renowned professional artists. The library will continue to serve this purpose by incorporating exhibit area into the renovated building.

In contrast, the purpose of the percent for art purchase is to commission a permanent public artwork that will serve as a showcase piece to inspire the public imagination. This piece should stretch beyond a traditional interpretation of libraries and speak broadly to our mission to build community, share stories, and instill a love of learning and creative pursuits.

The library is attracted to concepts that include non-visual or non-traditional elements, such as sound, light, wind, suspension. The library also interested in interactive elements that can be used, moved, and manipulated by the public.

The library is attracted to concepts in which the artwork is incorporated into a highly visible area such as:

- outdoor public plaza
- library entryway
- atrium / stairwell
- facade of parking garage

The library is attracted to concepts that include use of reclaimed materials; for instance, natural elements from library grounds that would otherwise be lost during construction.

Library Expansion Project Schedule: Design and construction documents are being finalized currently. Construction is expected to begin on the project in late 2012 and will continue through 2014.

Budget:

The City has allocated \$75,000 for the search, design, materials, fabrication, installation, artist fee, and other associated project costs.

Depending on the final concept, the artist may have the opportunity to augment this budget with construction materials. If the art is incorporated into the architecture, materials costs that have been budgeted for architectural components may be available to the artist to supplement his/her materials budget. Other opportunities may also be envisioned by the artist, but the following spaces have been identified as having potential to benefit from the leveraging of building materials costs:

- Outdoor public plaza
- Library entryway
- Atrium/ stairwell
- Façade of parking garage

Drawings by the project architects are attached in Appendix A to assist in the artist in envisioning the potential of these spaces for art integration. Ultimately, a commission amount will be the subject of an agreement between the City and the artist and will be within the overall project budget.

Commission and Agreement:

Artwork for this project will be commissioned through the City of Lawrence, Kansas. Artists will coordinate work with City staff, Library representatives and the Expansion Project Design team.

An agreement between the City and the Artist/Artistic Team will formalize budget, schedule and art design.

Eligibility:

The opportunity to compete for this project is open to all established, professional artists residing in the United States. Artists who currently live in Kansas or who have lived in Kansas are preferred. The City of Lawrence does not discriminate on the basis of race, sex, religion, color, national origin, age, ancestry, disability, or gender identity. Submissions by City or Library employees, and members of the Percent for Art Committee, Artist Selection Panel, or Lawrence Cultural Arts Commission or their relatives will not be considered. Experience with public art projects, especially in relation to capital projects, is preferred. Applicants must be able to work effectively within the project timeline and collaborate with the design team and multiple government agencies.

Selection process:

The selection panel includes artists and arts professionals familiar with the field of public art, citizens, Library representatives, design professionals, and Library staff. The panel will select a small group of finalists who will be asked to develop final proposals.

The criteria used by the panel will include:

- The artist's professional credentials as evidenced by the submitted materials
- Ultimate achievement of the Library's vision for public art
- Strength of past artworks
- Experience working in public settings
- Experience fabricating and installing permanent artwork
- Artist has worked with comparable sized budgets and artist's previous work is durable, maintainable, safe, and appropriate for a public space

The City of Lawrence is not required to make selections from these submissions, if, in their opinion, qualifications and concepts are not appropriate.

Submissions:

Interested artists should submit the following by 4:00 PM Central Time on Friday, October 5, 2012 to: <http://lawks.us/percent-for-art> . In order to avoid technical problems, artists are encouraged to submit well in advance of the deadline. Late submittals will not be accepted.

Artists interested in this project must prepare and submit the following set of documents (PDF Documents are preferred.)

1. **A letter of interest** outlining your approach to public art as well as providing the panel with insights regarding your interest in making art for the City of Lawrence, the Library, and the public realm in general; what you bring to the project as an artist; experience with other projects with a similar scope; your connection with Kansas and Lawrence (if applicable), challenges and/or sources of inspiration presented by the project; any previous experience you have had incorporating art into architecture; and any other comments that might help to differentiate you as a candidate for this program. Please also provide your name, address, phone number and e-mail address. Not to exceed one page.
2. **A professional resume/CV** (limit 3 pages front to back). Artists working collaboratively must submit a resume/CV for each collaboration member.
3. **A sketch or other appropriate visual representation of your conceptual approach to the project and a descriptive narrative** that explains your aspirations and vision for the project. Narrative is not to exceed one page.
4. **An annotated image list in one PDF with a limit of 15 images** of past works that clearly indicates the title, dimensions, materials, date of work, and locations, as well as project budget and commissioning entity, if applicable. If the artist needs to submit movie clips or audio files, they must not be any greater than 3 minutes in length. Movie clips must be formatted in Windows Media Player or Quick Time only. Audio files must be formatted in WAV or MP3.
5. **References:** A list of at least three professional references from past projects. The list must include complete addresses and telephone numbers.

Submittal delivery:

Submittals must be submitted electronically by the deadline of Friday, October 5, 2012, by 4:00 PM Central Time on the City's website at : <http://lawks.us/percent-for-art>

Artists are highly encouraged to submit well in advance of the deadline to avoid any technical difficulties.

Anticipated Art Project Selection Timeline:

RFQ distributed: Week of August 20

Informational meeting at the Lawrence Public Library Auditorium: Thursday, August 30, 7:00 PM Central Time. More information is available at:

<http://www.lawrence.lib.ks.us/2012/08/public-art-commission/>

Qualifications and preliminary concept sketch and narrative due: Friday, October 5, 2012 by 4:00 PM Central Time

Panel Review: October, 2012

Notification to finalists: Late October, 2012

Finalist presentations, artists chosen: Late 2012. Finalists will be required to make a site visit to view the location, present their detailed project proposal, and discuss expectations.

Estimated Building Project Completion Date: April 2014

Contact information:

Diane Stoddard, Assistant City Manager, City Liaison for Lawrence Cultural Arts Commission:

dstoddard@lawrenceks.org

Phone: 785-832-3413

Additional information about the Lawrence Cultural Arts Commission is available at

http://www.lawrenceks.org/advisory_boards/lac/

Additional information about the Lawrence Public Library is available at

<http://www.lawrence.lib.ks.us/>

lawrence public library art integration map

key type

- A GALLERY : interior gallery distributed around building core for display of 3-D or 2-D media
- B SCULPTURE GARDEN : 60'x40' exterior location at library entry.
- C ATRIUM DISPLAY: a 14' wide two-story volume available for suspended media. pending coordination with the architect and contractor, the construction materials in this area may be utilized by the artist
- D COMMUNITY PLAZA : the exterior plaza, south of the library will have a variety of display and site integration opportunities
- E PARKING STRUCTURE FAÇADE : the parking structure will have an approximately 200' x 20' perforated metal skin. this has the potential to be utilized by the artist, pending coordination with the architect and contractor.

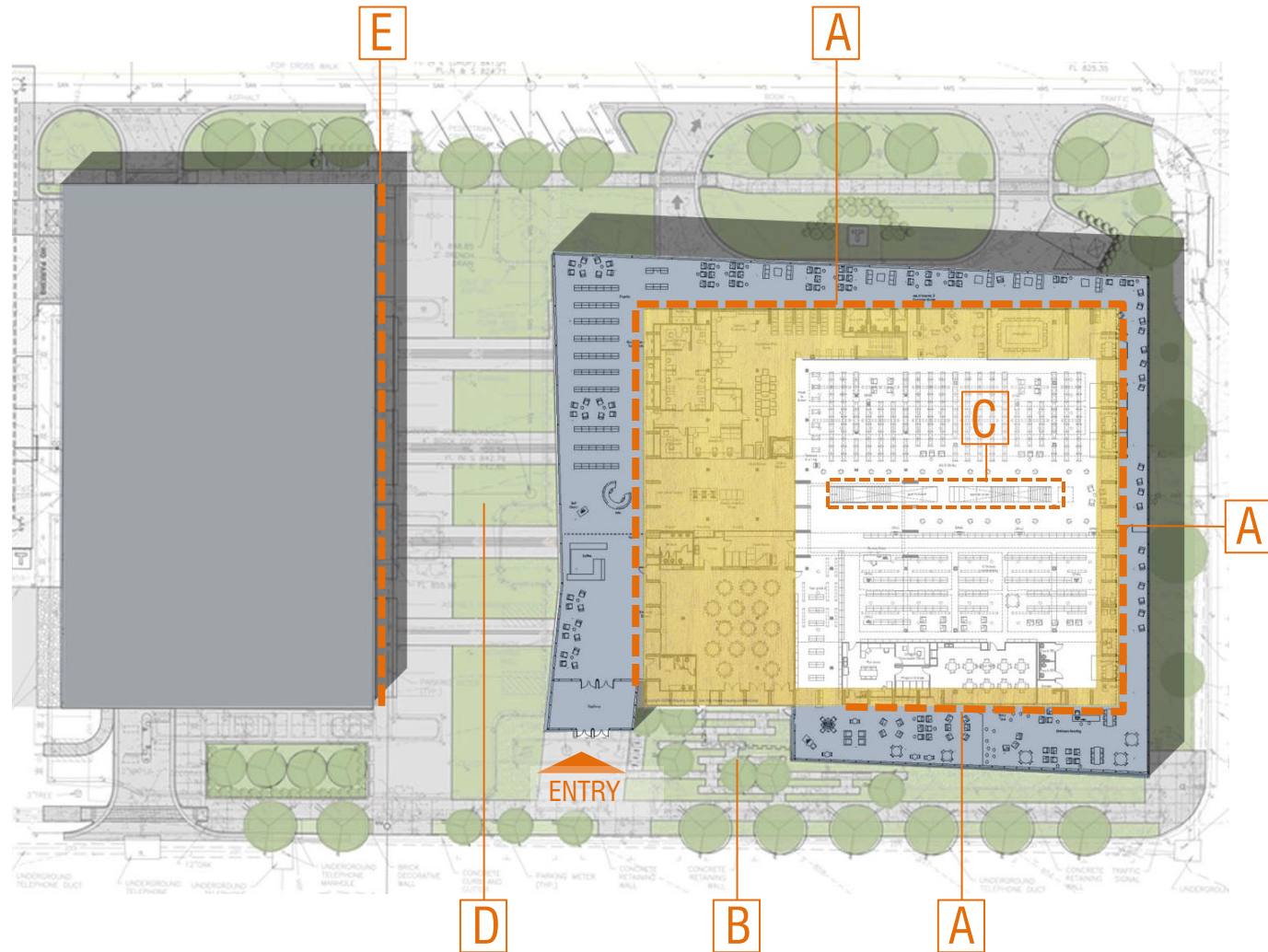

note : the locations listed above are potential locations and are not intended to limit the opportunities within the facility. other locations may be offered for consideration as part of the review process.

