

**Name \***

Dierk Van Keppel

**Address \***



6801 Farley

Merriam, Kansas 66203

United States

**Email \***

[info@rockcottageglassworks.com](mailto:info@rockcottageglassworks.com)

**Phone Number \***

(913) 262-1763

---

**Dierk Van Keppel**

6801 Farley, Merriam, Kansas 66203

P. 913-262-1763

[info@RockCottageGlassworks.com](mailto:info@RockCottageGlassworks.com)

[www.RockCottageGlassworks.com](http://www.RockCottageGlassworks.com)

**References**

**Louis Gehring**

Shawnee Mission Medical Center

7312 Antioch Road

Shawnee Mission, Kansas 66203

913-676-2057

[Louis.Gehring@ShawneeMission.org](mailto:Louis.Gehring@ShawneeMission.org)

**Bill Zahner**

A. Zahner Company

1400 East 9th Street

Kansas City, Missouri 64108

816-474-8882

[BZahner@AZahner.com](mailto:BZahner@AZahner.com)

**Bruce Yarnell**

Yarnell Associates

12616 West 71st Street

Shawnee, Kansas 66216

913-384-2801

[Bruce@YarnellAssociates.com](mailto:Bruce@YarnellAssociates.com)

Artist Team: Dierk Van Keppel and John Shreve

**DIERK VAN KEPPEL**

6801 Farley, Merriam, Kansas 66204 P. (913) 262-1763

[info@RockCottageGlassworks.com](mailto:info@RockCottageGlassworks.com)

[www.RockCottageGlassworks.com](http://www.RockCottageGlassworks.com)

**Study, Training, Founding**

Upon graduation from the University of Kansas in 1985 with a BGS in Sociology, Dierk studied Art Glass at the same university from 1983 to 1987, assisting with lectures and demonstrations with renowned artists including Dale Chihuly, Stephen D. Edwards, Ken Carder, Fritz Driesbach and Wes Hunting.

In 1984, Dierk studied under Richard Marquis and Thermon Statom at Pilchuck Glass Studio in Stanwood, Washington then joined the Pilchuck staff himself in 1985. Soon after, in 1986, Dierk founded his first private glass studio, Free State Glass, in Lawrence, Kansas. By 1991, the artist moved closer to his hometown area near Kansas City and established Rock Cottage Glassworks in Merriam, Kansas. Today, working in his eighty-year old stone cottage studio with a skilled team, he continues to handcraft extraordinary works of art. In 2010, Dierk became an Associate Professor of Art for Park University, Parkville, Missouri.

**Commissions/Collections (*representative, not all-inclusive*)**

Faultless Starch, Kansas City, MO

Shawnee Mission Medical Center, Overland Park, KS

Capital One, Plano Town Center, Plano, TX

Fogo De Chao Restaurant, Houston, TX, Chicago, IL

H&R Block World Headquarters, Kansas City, MO

Helzberg Jewelry Stores, Kansas City, MO

Hereford House, Leawood, KS

Hilton Hotels, Chicago, IL

Houston Marriot, Houston, TX

Jaspers Restaurant, Kansas City, MO

Lidias Restaurant, Kansas City, MO

Nazarene Publishing House, Kansas City, MO

Northwest Airlines World Club, Detroit, MI

Overland Park Convention Center, Overland Park, KS

Pierponts Restaurants, Kansas City, MO

Sprint World Headquarters, Overland Park, KS

Union Station Café, Kansas City, MO

Warwick Restaurant, Seattle, WA

Yia Yia's Restaurants, Denver, CO, Kansas City, MO, Memphis, TN, St. Louis, Mo

# Artist Team: Dierk Van Keppel and John Shreve

## BIOGRAPHICAL SKETCH

**John Shreve, AIA, AICP**

**Senior Vice President + Senior Urban Designer**

HOK  
2300 Main Street  
Suite 900  
Kansas City, MO 64108

Phone: 314.754.4297  
Fax: 816.448.3805  
E-Mail: [john.shreve@hok.com](mailto:john.shreve@hok.com)

## EDUCATION

University of Kansas - PhD Student, American Studies; Concentration: Biomimetic Design Methodologies in Coupled Human-Natural Systems; Expected Completion: May, 2014

University of Kansas – Masters of Arts, American Studies, 2012.

Harvard University – Graduate School of Design; Master of Architecture in Urban Design, 1992

University of Notre Dame - Bachelor of Architecture, 1986; Bachelor of Art History, 1986

## ACADEMIC ACTIVITIES

University of Kansas – Student Fellow, Aging in the Built Environment; Co-founder, Boomer Futures Lecture Series; Co-founder, New Cities Initiative; Associate, NSF-funded Integrative Graduate Education and Research Traineeship (IGERT); Visiting Critic, School of Architecture, Design and Planning, 2010 - Present

Kansas State University – College of Architecture, Planning and Design, Visiting Critic, 2009 – Present

Harvard University – Graduate School of Design, Alumni Council, 2007 – Present

## PROFESSIONAL MEMBERSHIPS

American Institute of Architects; Registered Architect: Texas, Puerto Rico  
American Institute of Certified Planners  
National Council of Architectural Registration Boards (NCARB)  
American Planning Association  
Urban Land Institute

## AWARDS

- Leonard Kagan Design Fellowship, New York and Tokyo: Civic Spaces
- National Urban Design Award, Sasltillo Government Center Master Plan
- Dallas Visions Award, Center City TIF Art & Streetscapes Project
- AIA Florida Honor Award, Orlando Events Center
- ASLA National Honor Award, Lavasa-Mugaon New Town Master Plan
- Dallas AIA & ASLA Awards, Troia, Portugal Eco-Resort
- First Prize, Shimao International Competition, Changshu, China Master Plan

## PROJECTS

- Center City TIF Art & Streetscapes Project, Dallas, Texas – 20-block CBD streetscape & public art plan.
- Fort Worth Convention Center and Plaza – integrated with Phillip Johnson's water fountain project.

## Artist Team: Dierk Van Keppel and John Shreve

- Jacksonville Sports/Entertainment District – collaborated with winning artist from public art competition for public spaces.
- University of Minnesota TCF Bank Stadium, Minneapolis, Minnesota – 80,000-seat collegiate stadium & public plaza with Native American tribal monuments.
- Tatanka Amphitheater & Museum, Deadwood, South Dakota – New amphitheater and museum expansion for Lakota Sioux Culture.
- Dubai 2020 World Expo – overall urban design and public spaces for country pavilions and art installations.
- Fort Myers Riverfront Redevelopment Plan, Fort Myers, Florida – 18-block mixed-use development plan/guidelines, including public sculpture promenade.
- Lavasa New Town, Pune India – 25,000-acre hill station development and town center developed along public waterfront.
- Charosa Winery, Nashik, India – 220-acre production/tourism facilities.
- Wenzhou CBD Master Plan, Wenzhou, China – 1,300-hectare industrial port & new town.
- COFCO Agricultural Eco-Valley Master Plan, Beijing, China – High-tech agricultural-theme model city.
- Augusta Civic Center Arena District Plan, Augusta, Georgia – Arena-anchored downtown redevelopment plan.
- Nueva Las Condes Urban Center, Santiago, Chile – Downtown park & high density mixed-use center.
- Dallas Historic West End District Plan, Dallas, Texas – Integrated development plan with Victory District.
- Kawasaki Center, Tokyo, Japan – 32-story commercial tower & symphony hall.
- Saltillo Government Center, Saltillo, Mexico – New civic center & central park.
- Troia Eco-Resort Master Plan, Troia, Portugal – 486-hectare Oceanside resort & preserve.
- Changshu Residential Master Plan, Changshu, China – 16-hectare riverfront high-density community.
- Galatyn Park Master Plan, Richardson, Texas – Nortel corporate campus & mixed-use center
- Chunnel Land Use Plan, Kent, UK and Pas-de-Calais, France – Development strategic plan for tunnel end points.
- AT&T Park District Plan, San Francisco, California – Wharf renovation plan adjacent to Giants ballpark.
- Pittsburgh Arena Master Plan, Pittsburgh, Pennsylvania – Sports-entertainment urban residential district.
- Louisiana Youth Recreation Training Center, New Orleans, Louisiana – Post-Katrina re-use plan for 6 Flags property.
- New York Mets CitiField Stadium, Queens, New York – New stadium & urban plan for Willets Point.
- 2012 Summer Olympics Master Plan, Queens, New York – New York bid master plan.
- 2014 Winter Olympics Master Plan, Sochi, Russia – Olympic Village and Black Sea development plan.
- Chargers Stadium District Plan, San Diego, California – New football stadium & adjacent development.
- University of Washington Athletics Master Plan, Seattle, Washington – Husky Stadium expansion & sports district plan.
- Indiana University Athletic Master Plan, Bloomington, Indiana – Stadium/arena expansions & campus integration.
- Dubai Sports City, Dubai, UAE – Ecological new town golf course community.
- Birmingham Entertainment District, Birmingham, Alabama – New stadium & convention center expansion.
- Tirana Eco-City Plan, Tirana, Albania – Expansion of capitol city with ecological development.

**Dierk Van Keppel**  
6801 Farley  
Merriam, Kansas 66203  
P. (913) 262-1763  
[info@rockcottageglassworks.com](mailto:info@rockcottageglassworks.com)  
[www.rockcottageglassworks.com](http://www.rockcottageglassworks.com)

Dear Lawrence Public Library Art Selection Committee:

My goal is to create sculptural forms that capture the beauty and mystery of natural earth and astronomical formations utilizing glass, metal and light.

I am striving for work that relates to the chaos and pattern in nature as reflected in sea shore erosion, cloud and geological formation, fire, astronomical patterns, as well as wind and weather patterns. I am particularly interested in creating visual imagery that connects our primitive self to the awesomeness of our universe. I believe that the resulting work creates an unspoken language that we all relate to, but we can't express verbally; form, color, transparency, opacity, and depth.

The important unspoken meaning is that we recognize that integrity allows a community to see the way to what is right, to value all life and help everyone in society unlock their own potential. Everything we encounter, as we progress from infancy through adolescence and adult hood and finally as we approach our own death, has some unknown puzzle that can only be solved by immersing ourselves completely in life and be open to our fate. Despite our physical or cultural differences all people recognize beauty in art and nature and that all people have potential for inspiration.

My work is collaborative in nature, in order to satisfy the client it is important to keep an open mind and respond to their needs. Our process is also collaborative. I work with John Shreve an architect and we comprise our efforts as an artist team. John and I have been working together for the last several years pushing the boundary of where art and architecture begin and end. I have an extensive portfolio of artworks using glass and complimentary materials at various scales. John brings an extensive portfolio of architectural and urban design projects that seamlessly integrate art and narrative. Together we aspire to elevate the meaning and beauty of art in civic and cultural places. The end result of this collaborative effort definitely reflects the positive contributions and care shown by the parties involved.

This proposal is envisioned not as a single art object, but as an integrated systematic approach that is seamless with the architecture. The primary palette will be glass, but more importantly it will be included within a larger family of materials. ( concrete, metal, plaster, plastics etc.) This proposal is a series of projects that will be explored and detailed together with the client and architect to prioritize and to decide the final outcome.

My company carries two million dollars in general liability insurance. I have produced projects similar in scope to this proposal. I could meet all conditions and install my project on time and within budget.

Thank you for your time and consideration. I would love to be a part of your project. I look forward to hearing from you on the possibilities of working with you.

Sincerely,  
Dierk Van Keppel



# Illuminating Manuscripts

## Public Art Proposal

### Lawrence Public Library Expansion Project

Dierk Van Keppel  
John Shreve

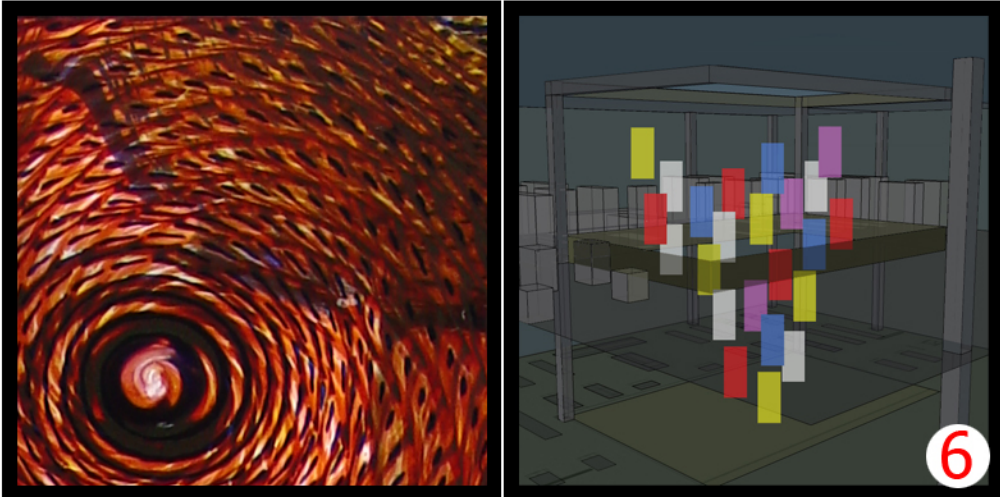

A flurry of color and light climax in the 2-story atrium, where panels of art glass are suspended into a dynamic sculpture that suggests pages of a book that have been recast into new form and meaning.

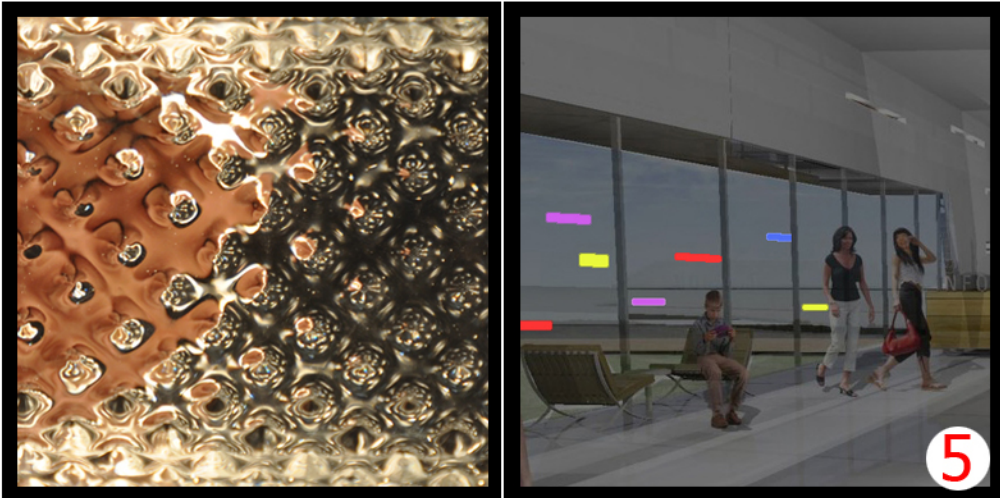

Small art glass are subtly layered into the windows of the reading room areas to echo the pattern of the light slots in the walls/ceilings; these also act as lenses for viewers to peer through into the landscape.

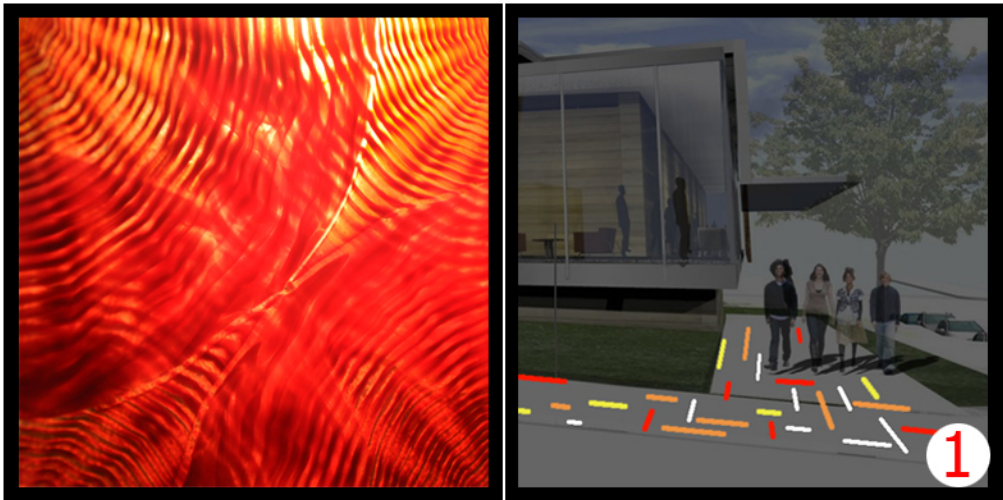

Slivers of glass embedded into concrete sidewalk signal the theme of color and light at a pedestrian scale; the amount/intensity of glass increases the closer one gets to the front entrance.

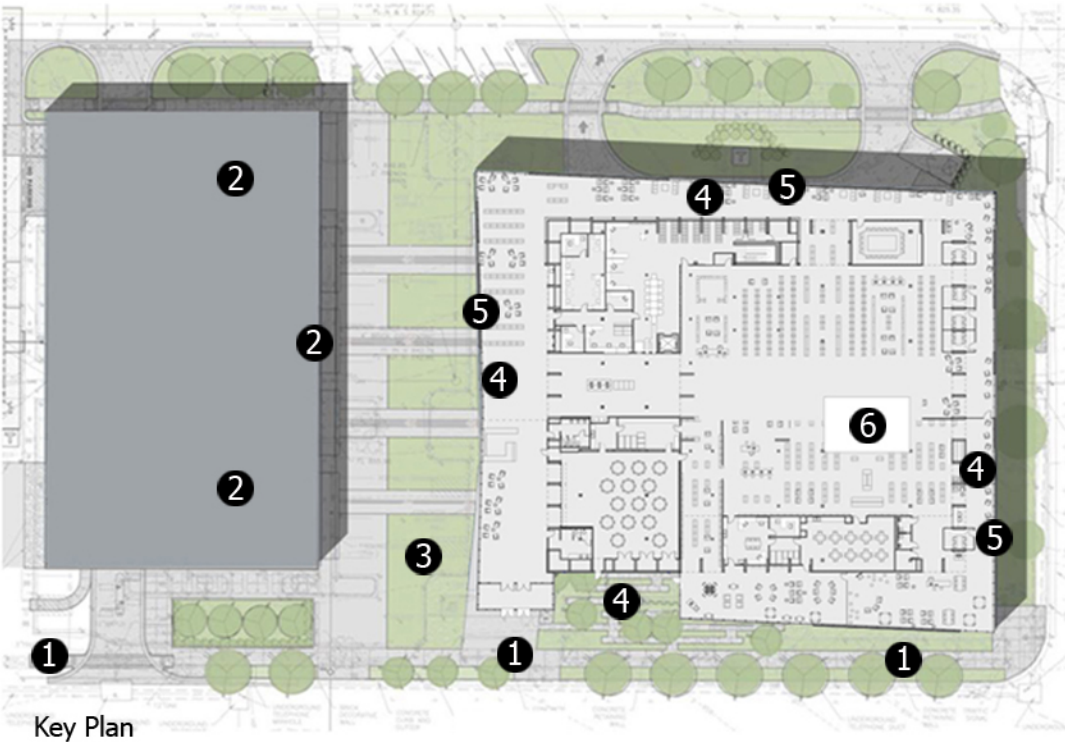

Key Plan

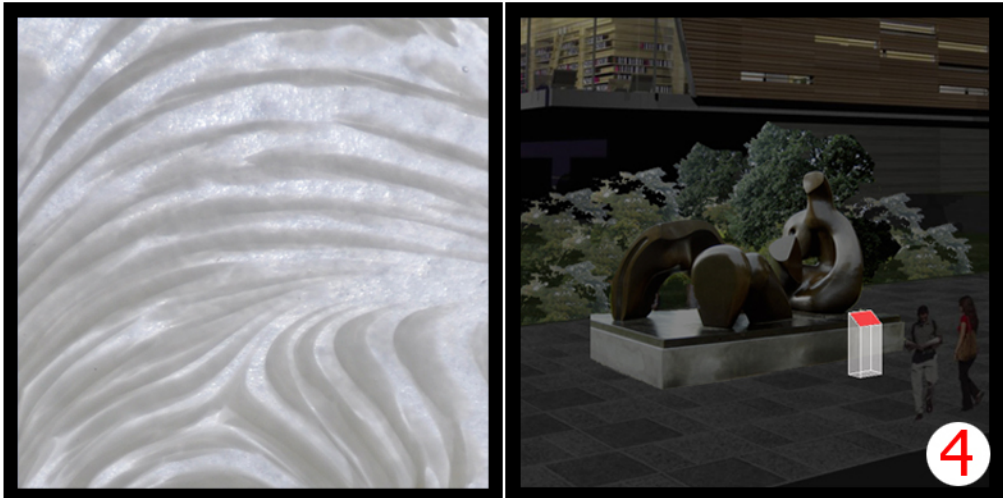

Local artwork inside and outside the library will be accompanied by simple glass panels to identify the artist and provide a code for visitors to scan or call to acquire additional information on the piece.



A layer of multi-colored art glass illuminates the copper tracery of the parking garage screen, providing a visual pattern or text that challenges visitors to "read" space, surface, and material in a different way.

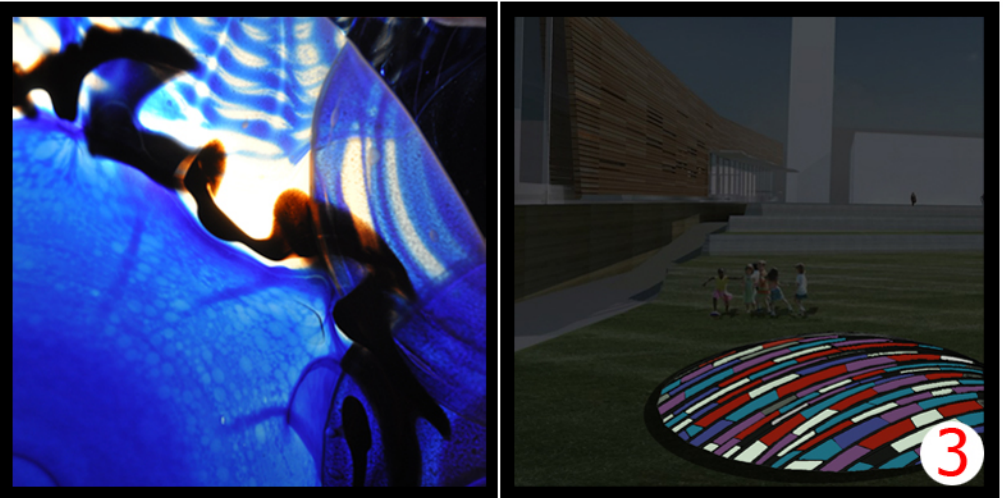

A climbable, sittable, and viewable fountain is envisioned near the plaza where vibrant art glass (with a protective layer) amalgamates into a punctuation point of the public space.



# Illuminating Manuscripts

## Public Art Proposal

### Lawrence Public Library Expansion Project

Dierk Van Keppel  
John Shreve

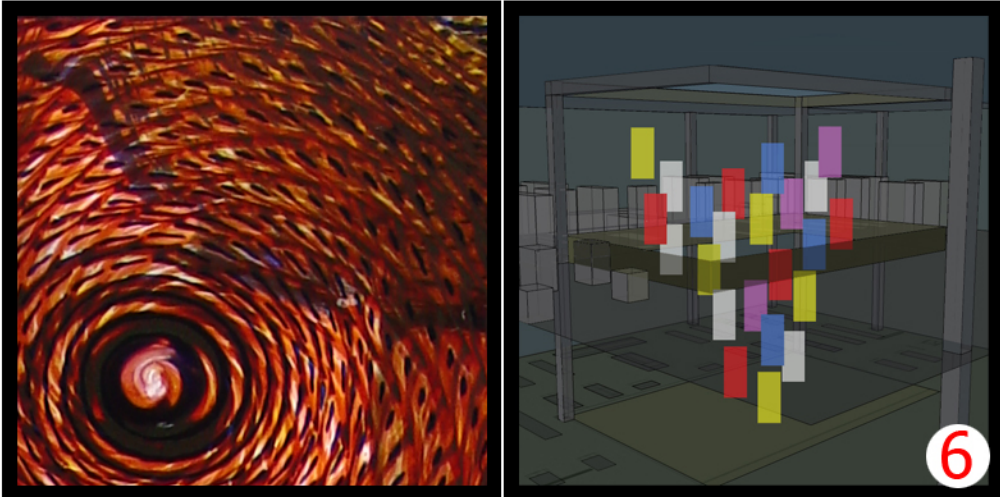

A flurry of color and light climax in the 2-story atrium, where panels of art glass are suspended into a dynamic sculpture that suggests pages of a book that have been recast into new form and meaning.

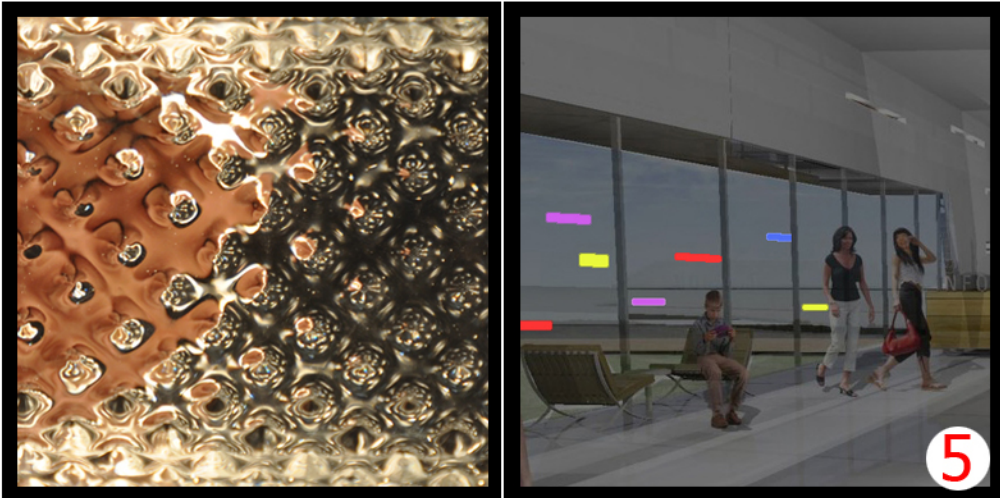

Small art glass are subtly layered into the windows of the reading room areas to echo the pattern of the light slots in the walls/ceilings; these also act as lenses for viewers to peer through into the landscape.

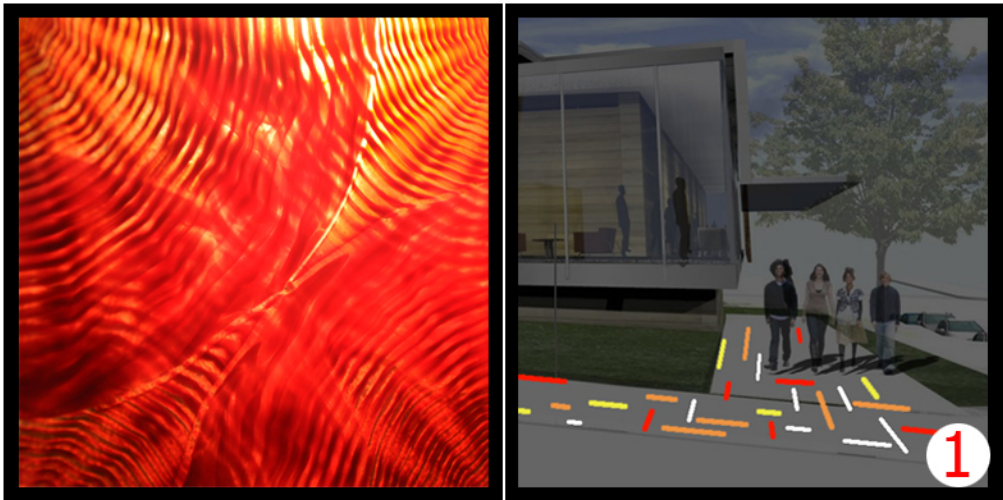

Slivers of glass embedded into concrete sidewalk signal the theme of color and light at a pedestrian scale; the amount/intensity of glass increases the closer one gets to the front entrance.

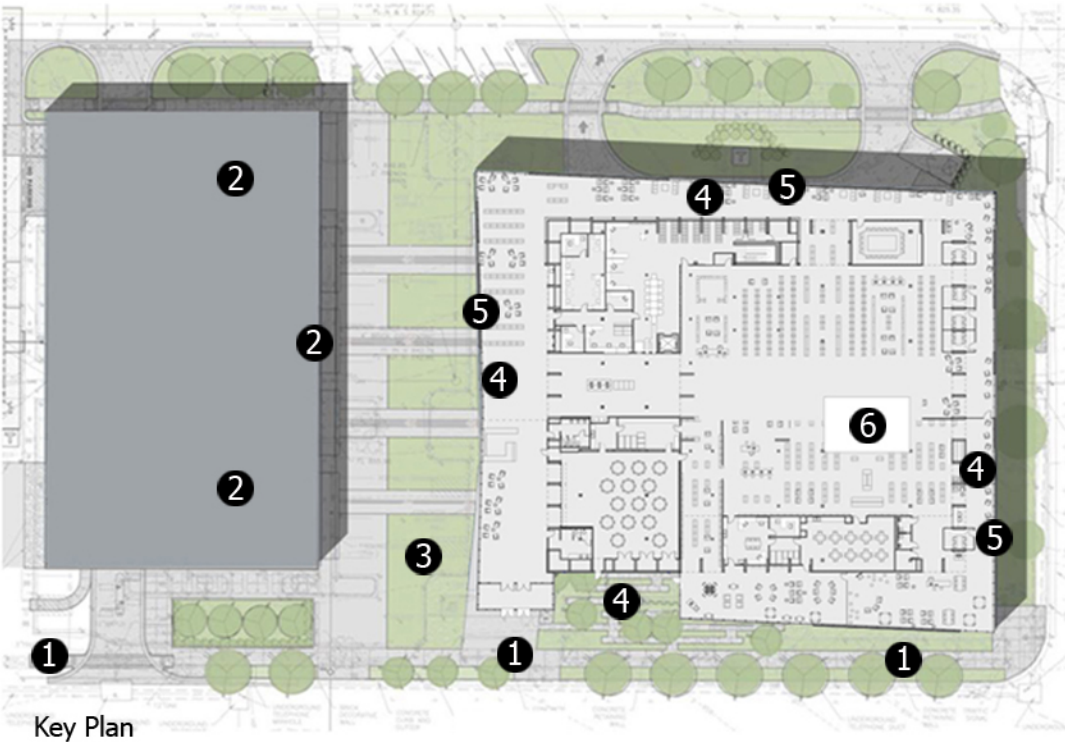

Key Plan

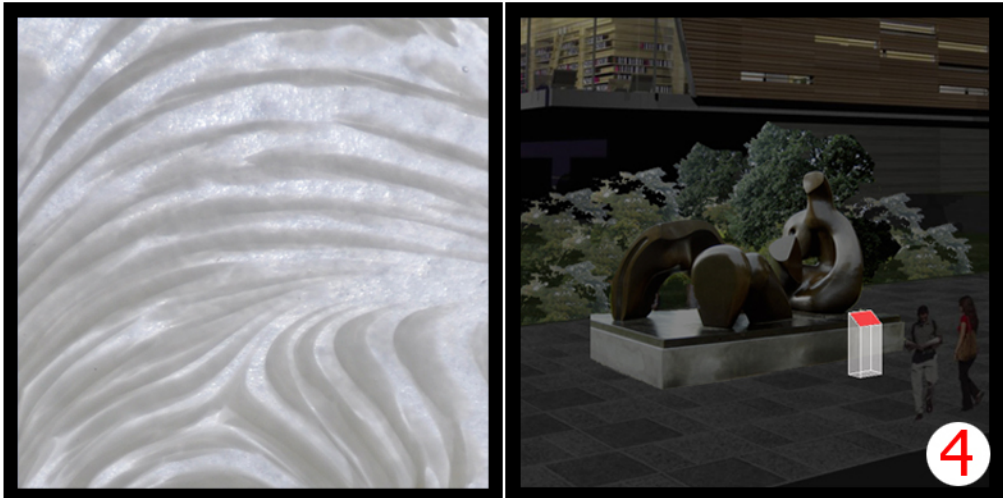

Local artwork inside and outside the library will be accompanied by simple glass panels to identify the artist and provide a code for visitors to scan or call to acquire additional information on the piece.



A layer of multi-colored art glass illuminates the copper tracery of the parking garage screen, providing a visual pattern or text that challenges visitors to "read" space, surface, and material in a different way.

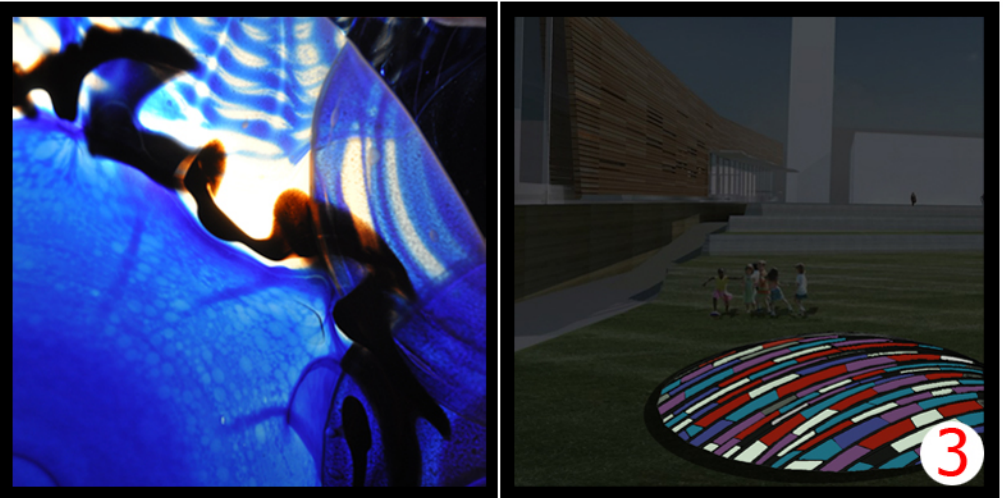

A climbable, sittable, and viewable fountain is envisioned near the plaza where vibrant art glass (with a protective layer) amalgamates into a punctuation point of the public space.



# Dierk Van Keppel

# John Shreve

---

*City Of Lawrence Public Library 2012*





**Title:** Flora

**Dimensions:** 48" x 72"

**Materials:** Blown-Fused Glass, Aluminum

**Date:** 2011

**Location:** Eiko LTD, Shawnee, Kansas

**Budget:** \$6,000.00

**Commissioning Agency:** Yarnell Associates



---

**Title:** Eden

**Dimensions:** 96" x 72" x 48"

**Materials:** Blown Glass, Stainless  
Steel, LED

**Date:** 2011

**Location:** Eiko LTD, Shawnee, Kansas

**Budget:** \$29,000.00

**Commissioning Agency:** Yarnell  
Associates





**Title:** Trinity

**Dimensions:** 384" x 276"

**Materials:** Blown-Fused Glass, Aluminum

**Date:** 2009

**Location:** Shawnee Mission Medical  
Center, Overland Park, Kansas

**Budget:** \$175,000.00

**Commissioning Agency:** Private Donor/  
Shawnee Mission Medical Center

---





**Title:** Sample

**Dimensions:** 25" x 42"

**Materials:** Blown-Fused Glass,

**Date:** 2009

**Location:** Shawnee Mission Medical Center/  
H&R Block

**Budget:** N/A

---

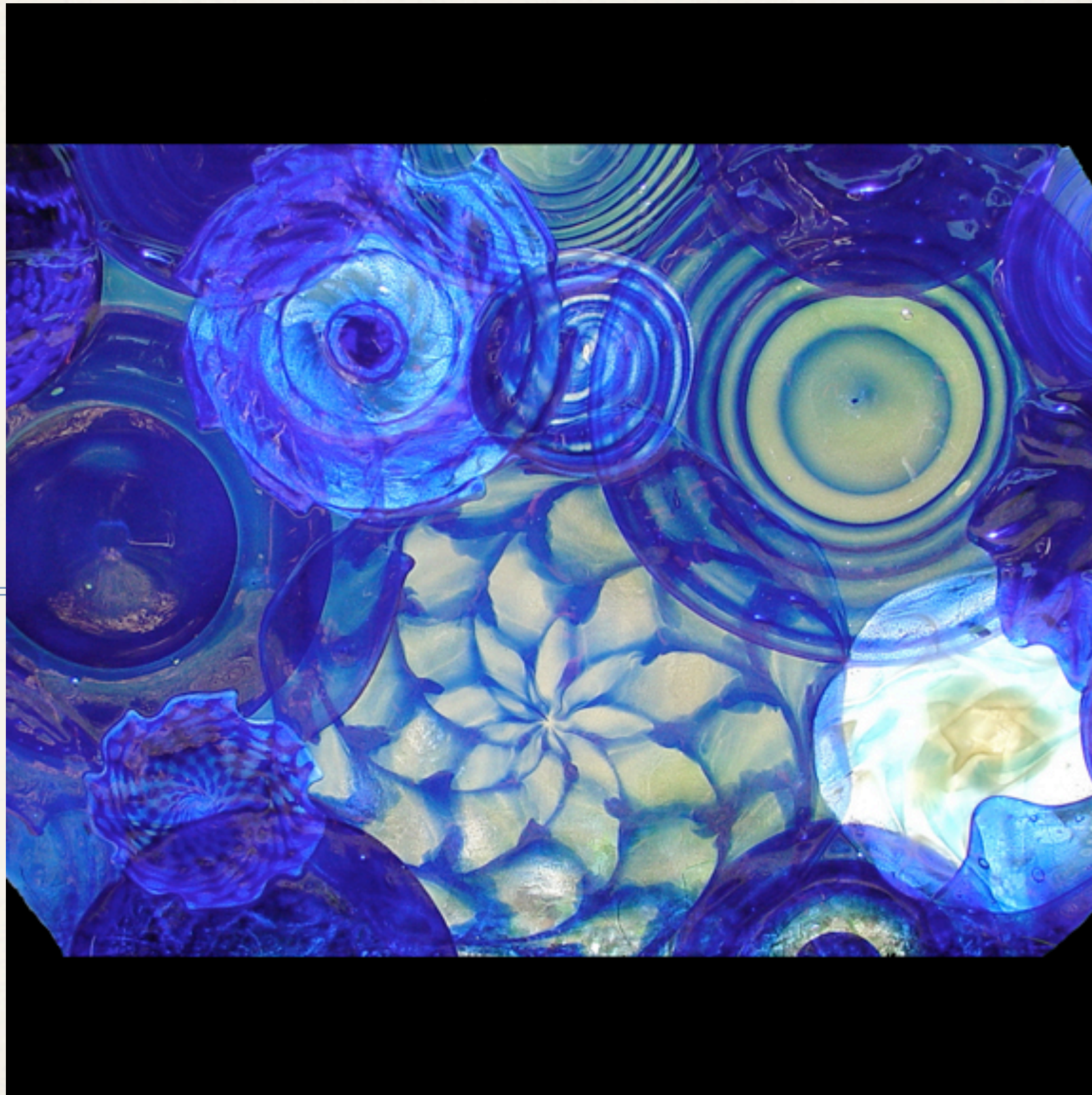



**Title:** Blue Sun

**Dimensions:** 17' x 9'

**Materials:** Blown-Fused Glass, Aluminum

**Date:** 2007

**Location:** H&R Block World Headquarters,  
Kansas City, Missouri

**Budget:** \$49,000.00

**Commissioning Agency:** H & R Block

---





**Title:** Compostela

**Dimensions:** 12' L x 70' H x 4'W

**Materials:** Blown Glass, Stainless Steel

**Date:** 2009

**Location:** Faultless Starch, Kansas City,  
Missouri

**Budget:** \$89,000.00

**Commissioning Agency:** Faultless Starch

---





**Title:** Helio Iris

**Dimensions:** 6 panels each measuring 30" x 40"

**Materials:** Blown-Fused Glass, Aluminum

**Date:** 2007

**Location:** Capitol One, Plano, Texas

**Budget:** \$24,000.00

**Commissioning Agency:** Capital One

---





**Title:** Detail of fused panel  
**Dimensions:** 30" x 40"  
**Materials:** Blown-Fused Glass  
**Date:** N/A  
**Location:** Capitol One  
**Budget:** \$3000.00

---

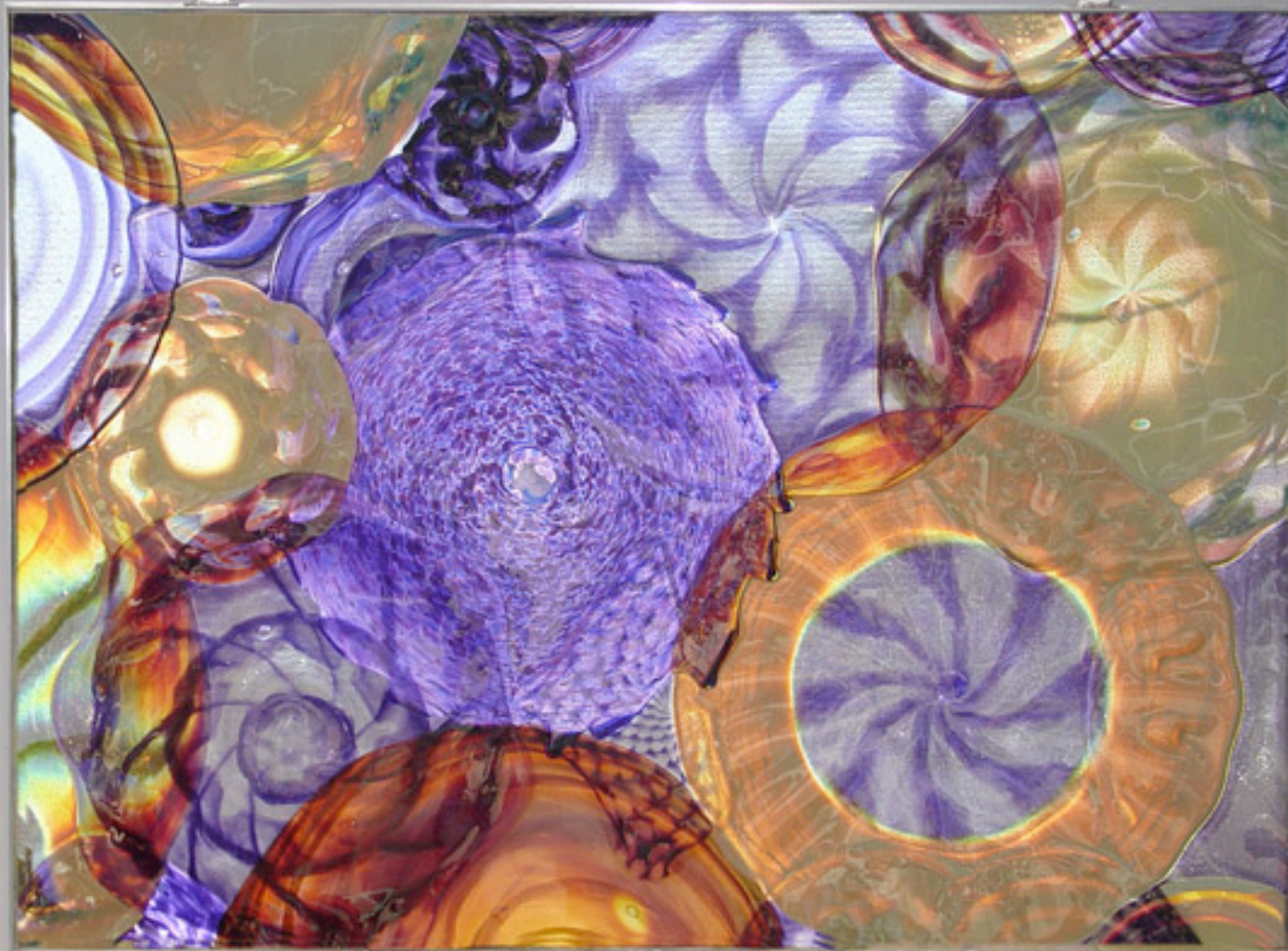



**Title:** Aurora

**Dimensions:** 30" x 40"

**Materials:** Blown-Fused Glass

**Date:** 2008

**Location:** Private Residence, Las Vegas, Nevada

**Budget:** \$12,000.00

**Commissioning Agency:** Karen Butera Design

---





**Title:** Tabernacle Wall

**Dimensions:** 12' H x 6' W

**Materials:** Cast Glass

**Date:** 2006

**Location:** St. Robert Catholic Church, Omaha,  
Nebraska

**Budget:** \$21,000.00

**Commissioning Agency:** Lambrecht Glass Design

---

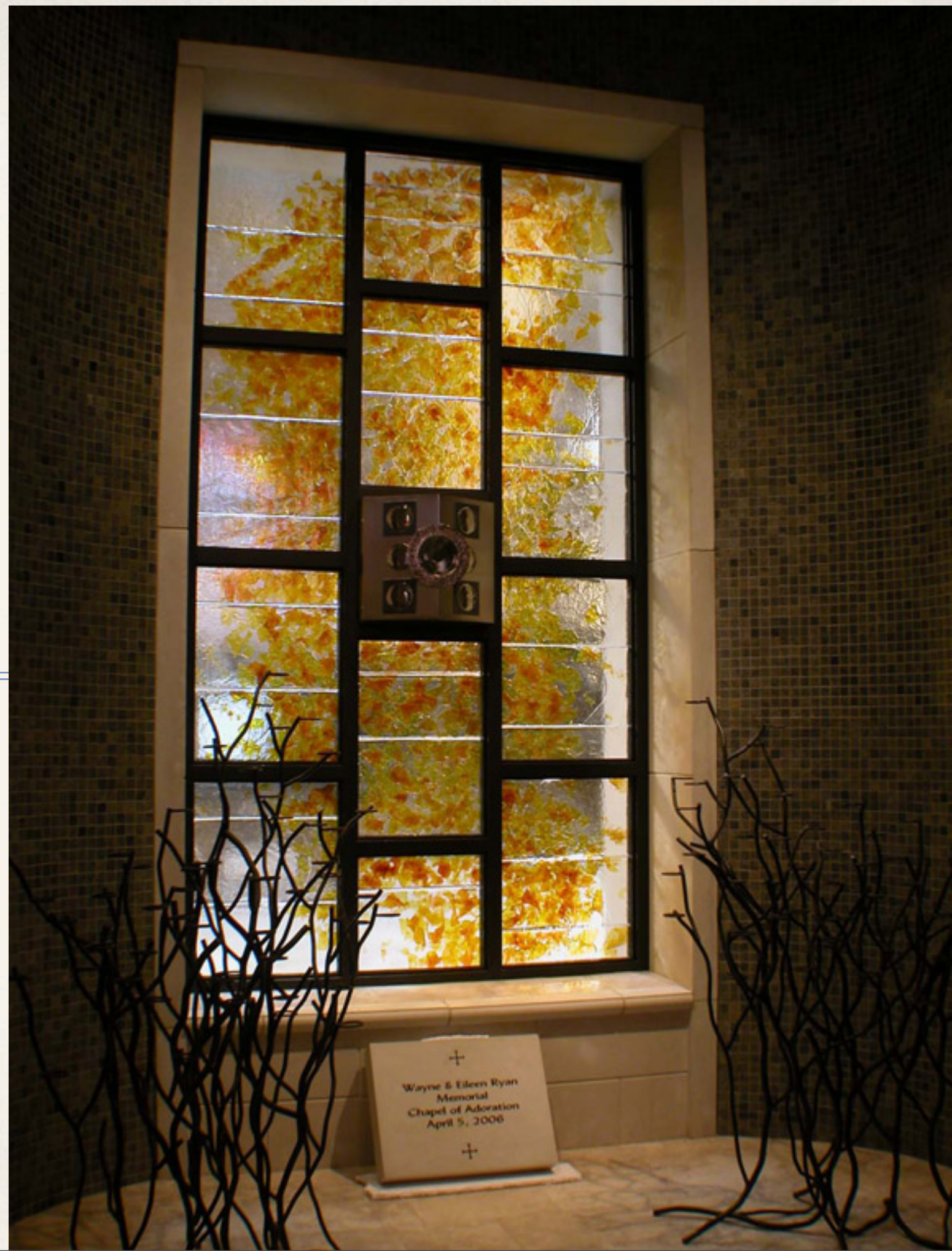



**Title:** Starlight

**Dimensions:** 9' Diameter

**Materials:** Cast Glass, STainless Steel

**Date:** 2009

**Location:** Starlight Theater, Kansas City, Missouri

**Budget:** \$19,000.00

**Commissioning Agency:** Gastinger Harding  
Walker Architects

---





**Title:** 1022 On The Lake

**Dimensions:** 72" h x 54" w

**Medium:** Cast Glass, Stainless Steel, Neon

**Date:** 2002

**Location:** Milwaukee, Wisconsin

**Budget:** \$24,000.00

**Commissioning Agency:** Katie Gingrass Gallery

---

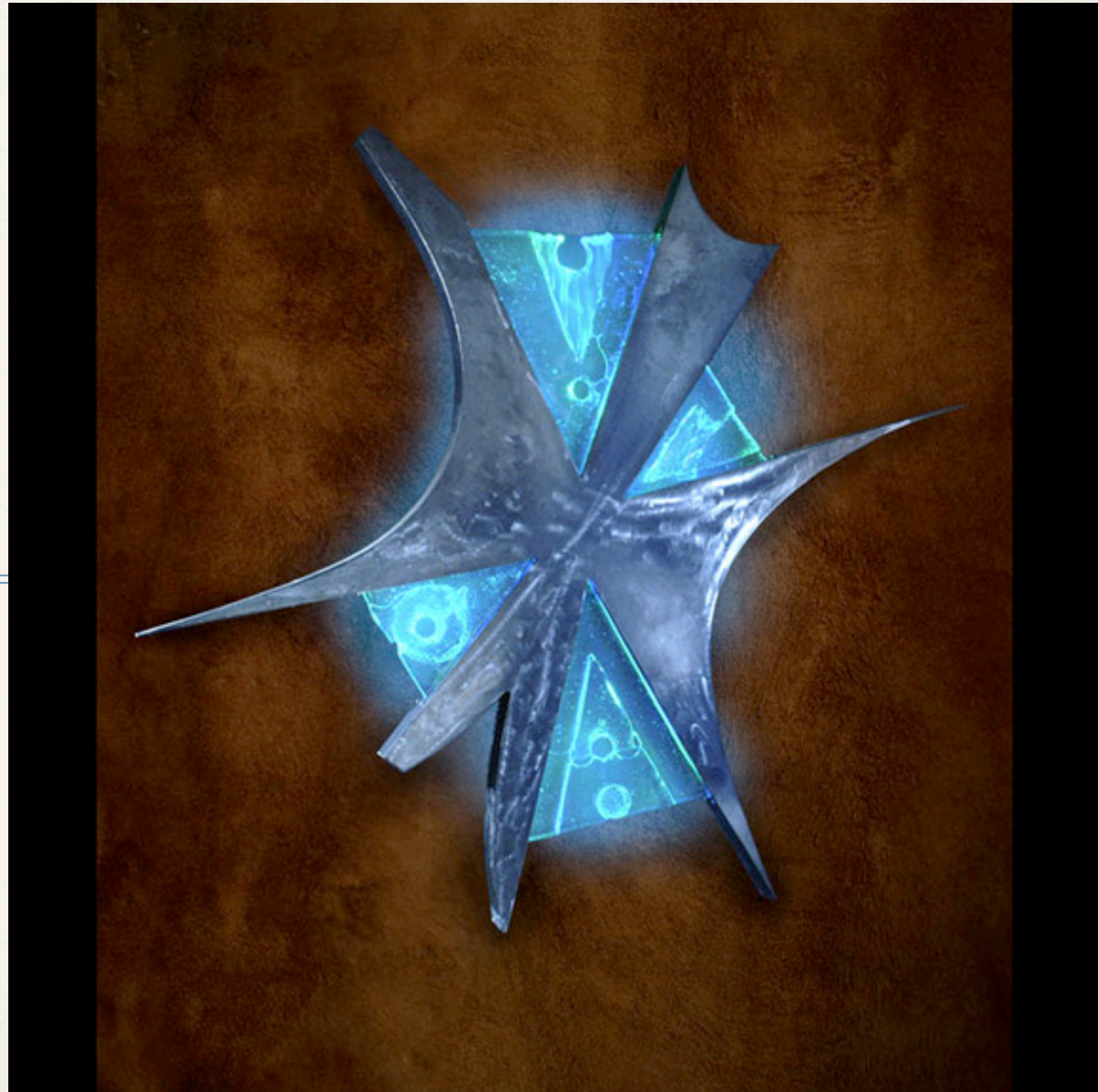



**Title:** Jasper's Window

**Date:** 2006

**Medium:** Blown Glass, Stainless Steel

**Location:** Jasper's, Leawood, Kansas

**Dimensions:** 36" H x 66" W

**Budget:** \$12,000.00

**Commissioning Agency:** Jasper's

---

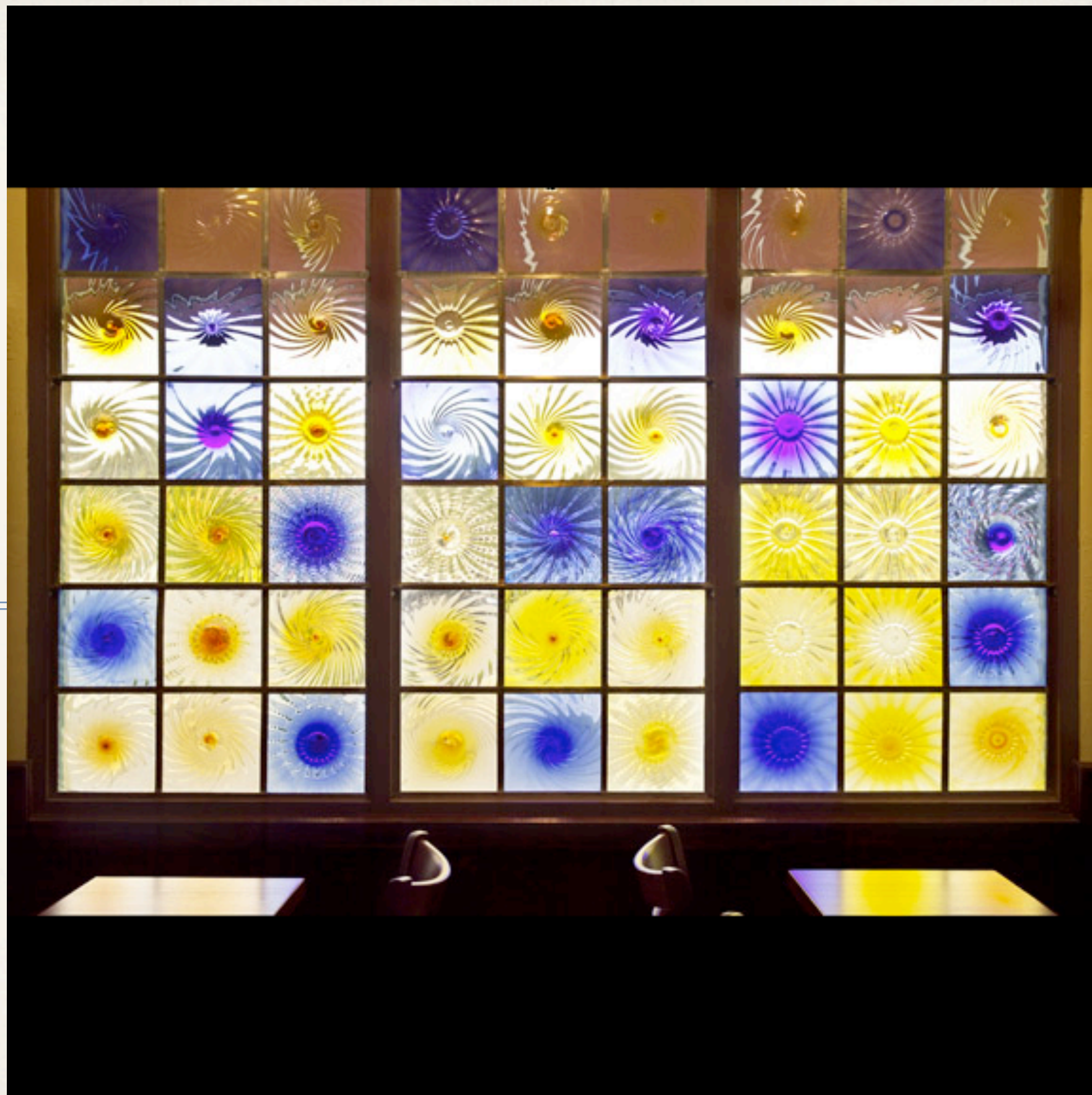



**Title:** Fleur de Mirabile  
**Dimensions:** 8' diameter  
**Medium:** Blown Glass, Stainless Steel  
**Date:** 2005  
**Location:** Private Residence  
**Budget:** \$21,000.00  
**Commissioning Agency:** Dr. James Mirabile

---

