

NOTES:

BEARING WALLS ARE HATCHED FOR EASY REFERENCE.

WALL TYPE TO BE WB UNLESS NOTED OTHERWISE.

SEE STRUCTURAL DRAWINGS FOR ADDITIONAL FRAMING INFORMATION.

SOFFITS SHOWN FOR WORSE CASE

1A IOBC TYPE FIRE EXTINGUISHERS TO BE PROVIDED AT A REASONABLY ACCESSIBLE LOCATION ON EACH FLOOR.  
EACH BATHROOM TO INCLUDE (2) 24" WIDTH TOWEL BARS AND A TOILET PAPER HOLDER.

DENSGUARD ITO BE USED IN PLACE OF TYPICAL GYPSUM BD. OR CEMENT BOARD IN ALL BATHROOMS AND SHOWERS.

USE RECESSED DRYERBOX AT ALL DRYER LOCATIONS.

BALLOON CONSTRUCTION IS NOT PERMITTED. FIRE BLOCKING WILL BE LOCATED AS REQUIRED.

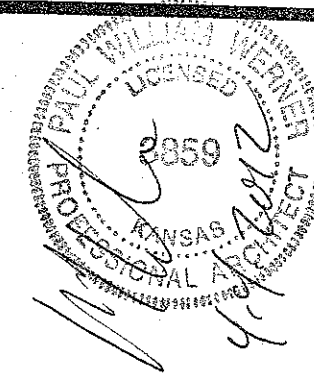
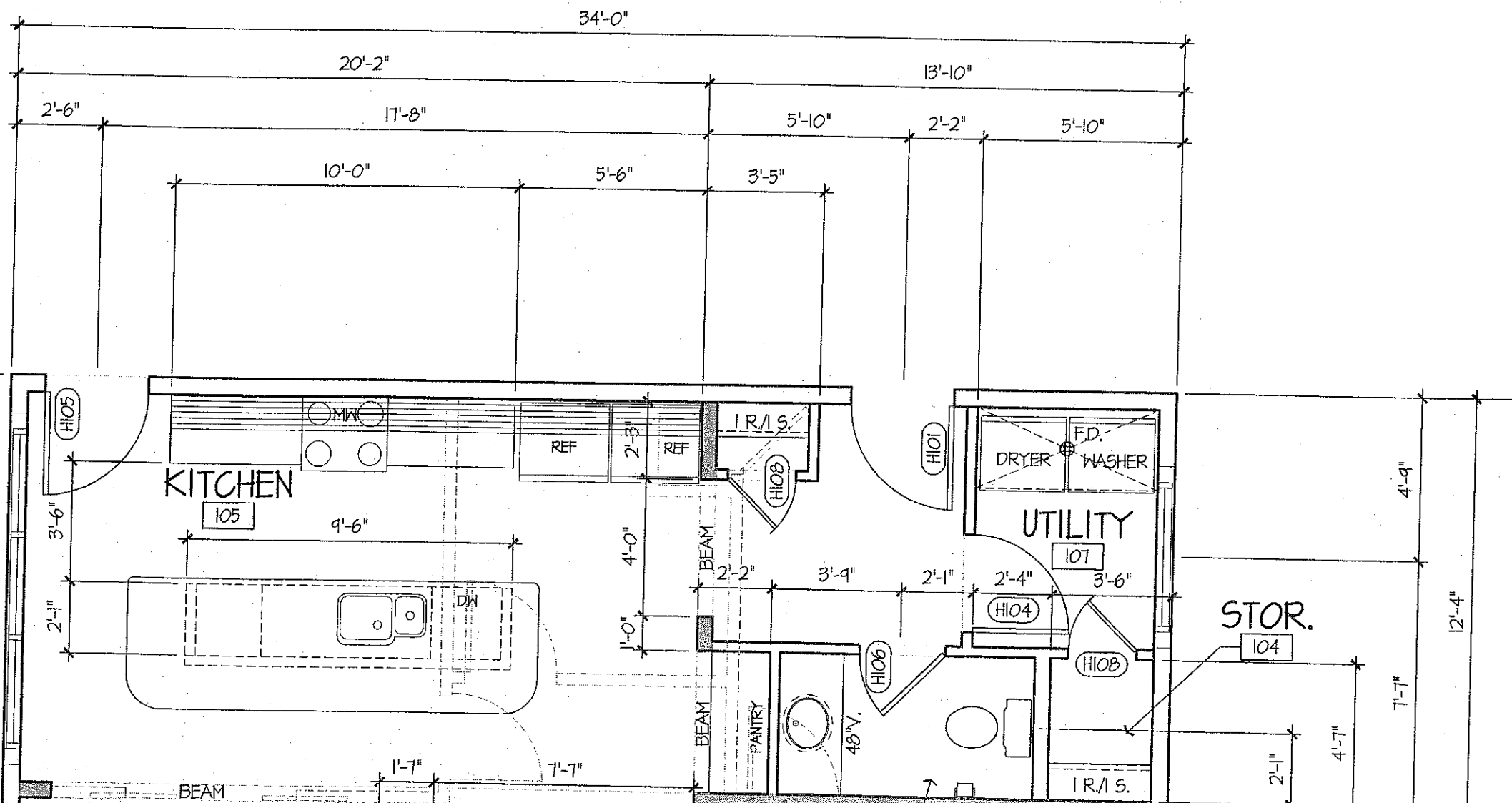

**paulwerner**  
ARCHITECTS

123 W. 8TH STREET  
SUITE B2  
LAWRENCE, KS 66044

OFFICE: 785.832.0804  
FAX: 785.832.0890  
INFO@PAULWERNERARCHITECTS.COM

BUILDER:  
DFC CO. OF LAWRENCE  
643 MASSACHUSETTS  
SUITE 300  
LAWRENCE, KS 66044  
OFFICE: 785.841.6346  
FAX: 785.841.6342