

AGENDA – TSC 11/2/09

ITEM NO. 3: Consider request to establish NO PARKING along one side of Wimbledon Drive between Inverness Drive & Turnberry Drive.

Facts:

1. Wimbledon Drive is classified as a local street in a residential area and is paved 26 feet wide.
2. Parking is currently permitted along both sides of the street.
3. There have been no reported crashes along this portion of Wimbledon Drive during the past three (3) years.

MINUTES – TSC 11/2/09

ITEM NO. 3:

Consider request to establish NO PARKING along one side of Wimbledon Drive between Inverness Drive & Turnberry Drive.

David Woosley presented the information provided in the staff report.

Public comment:

Pete Peterson, 4712 Wimbledon Drive: The need for NO PARKING would only exist between Inverness & Rodeo where the apartments are, if there is going to be NO PARKING on one side of the street; from Rodeo to Turnberry there is not a problem, there is seldom any parking there.

Commissioner Hagen: I think if you start removing parking, you will turn in into a race track.

MOTION BY COMMISSIONER MILLER, SECONDED BY COMMISSIONER HECKLER, TO RECOMMEND DENYING THE REQUEST TO ESTABLISH NO PARKING ALONG ONE SIDE OF WIMBLEDON DRIVE BETWEEN INVERNESS DRIVE & TURNBERRY DRIVE; THE MOTION CARRIED 8-0.

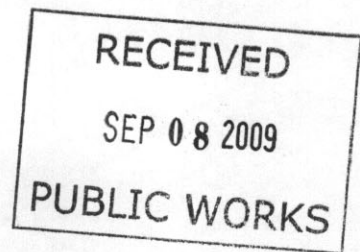

September 3, 2009

Traffic Safety Commission
Attn: David Woosley
P.O. Box 708
Lawrence, KS 66044

I have an apartment at 4800 Hallbrook Dr. and drive on either Wimbledon or Carmel most of the time. That is a pretty narrow street and when cars are parked on one side of the street, it is safer to slow down and wait for an approaching car to clear those cars.

When cars are parked on both sides of the street and there is an approaching car in the opposite direction that I am going, it is necessary to stop until that car comes through. It would be much safer if parking was limited to one side of the street only. It would be appreciated if the city would allow parking on only one side.

Mary Remus

Mary Remus
1621 Edgehill Road (mailing address)
Lawrence, KS 66044
785-331-2789

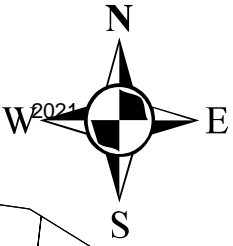
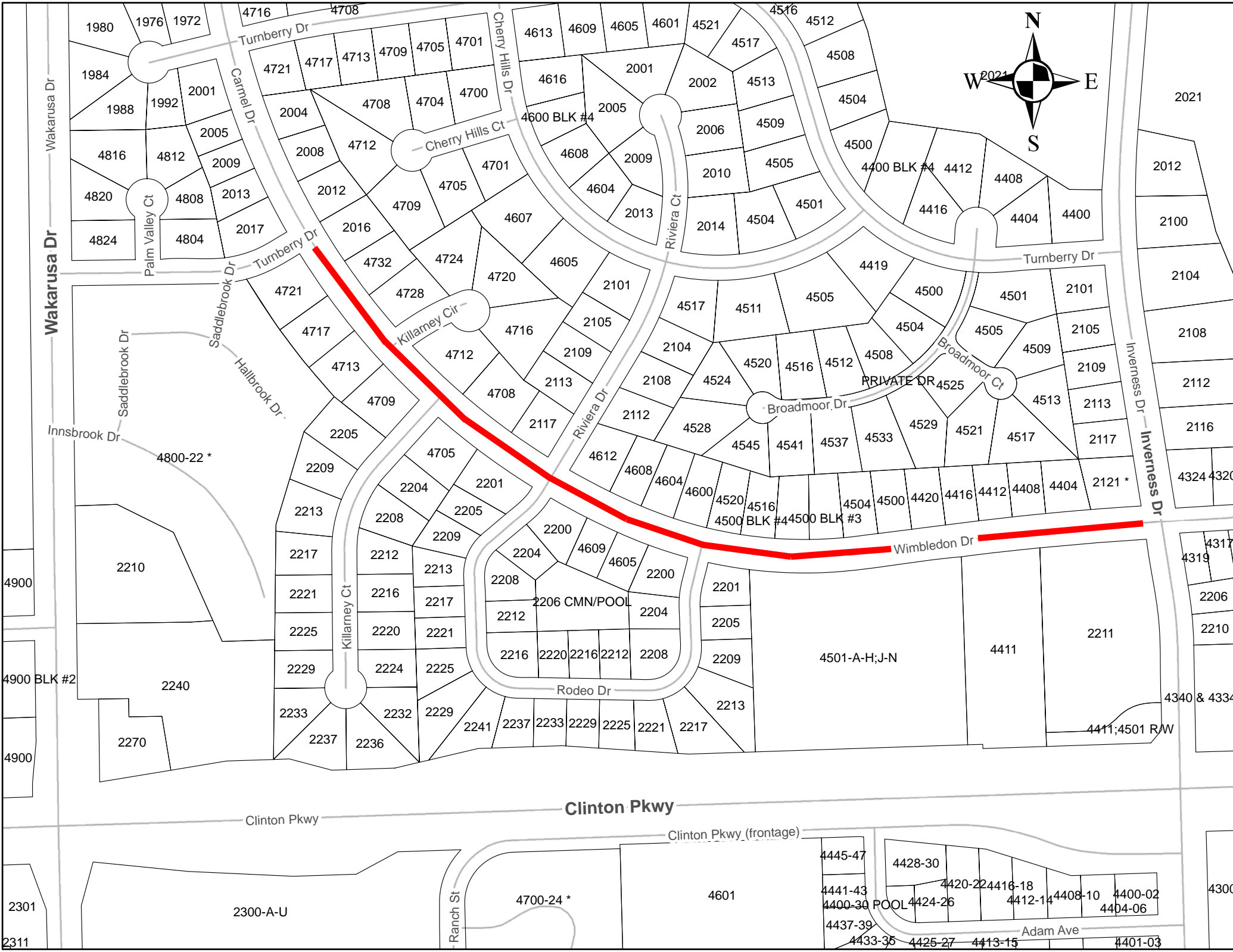

Wakarusa Dr

Turnberry Dr

Cammel Dr

Palm Valley Ct

Saddlebrook Dr

Hallbrook Dr

Innsbrook Dr

Killarney Cir

Killarney Ct

Riviera Dr

Riviera Ct

Broadmoor Dr

Broadmoor Ct

Inverness Dr

Rodeo Dr

Wimbledon Dr

Clinton Pkwy

Clinton Pkwy

Clinton Pkwy (frontage)

Ranch St

Adam Ave

2311

2301

4900

4900 BLK #2

4900

4800-22 *

2210

2240

2270

2237

2233

2229

2225

2221

2217

2213

2209

2205

2201

2208

2204

2209

2212

2216

2220

2224

2229

2232

2236

2237

2241

2249

2255

2261

2268

2232

2233

2237

2241

2249

2255

2261

2268

2274

2280

2286

2292

2298

2304

2310

2316

2322

2328

2334

2340

2346

2352

2358

2364

2370

2376

2232

2233

2237

2241

2249

2255

2261

2268

2274

2280

2286

2292

2298

2304

2310

2316

2322

2328

2334

2340

2346

2352

2358

2364

2370

2376

2232

2233

2237

2241

2249

2255

2261

2268

2274

2280

2286

2292

2298

2304

2310

2316

2322

2328

2334

2340

2346

2352

2358

2364

2370

2376

2232

2233

2237

2241

2249

2255

2261

2268

2274

2280

2286

2292

2298

2304

2310

2316

2322

2328

2334

2340

2346

2352

2358

2364

2370

2376

2232

2233

2237

2241

2249

2255

2261

2268

2274

2280

2286

2292

2298

2304

2310

2316

2322

2328

2334

2340

2346

2352

2358

2364

2370

2376

2232

2233

2237

2241

2249

2255

2261

2268

2274

2280

2286

2292

2298

2304

2310

2316

2322

2328

2334

2340

2346

2352

2358

2364

2370

2376

2232

2233

2237

2241

2249

2255

2261

2268

2274

2280

2286

2292

2298

2304

2310

2316

2322

2328

2334

2340

2346

2352

2358

2364

2370

2376

2232

2233

2237

2241

2249

2255

2261

2268

2274

2280

2286

2292

2298

2304

2310

2316

2322

2328

2334

2340

2346

2352

2358

2364

2370

2376

2232

2233

2237

2241

2249

2255

2261

2268

2274

2280

2286

2292

2298

2304

2310

2316

2322

2328

2334

2340

2346

2352

2358

2364

2370

2376

2232

2233

2237

2241

2249

2255

2261

2268

2274

2280

2286

2292

2298

2304

2310

2316

2322

2328

2334

2340

2346

2352

2358

2364

2370

2376

2232

2233

2237

2241

2249

2255

</