

Memorandum

City of Lawrence

Planning & Development Services

TO: Sandra Day
FROM: David Guntert
CC: Sheila Stogsdill; Scott McCullough; John Miller

Date: April 6, 2010
RE: Calculations for SUP-01-03-10 Protest Petition

The protest petition filed in the City Clerk's Office on April 2, 2010 pertaining to the referenced request for a special use permit has enough signatures of the record owners of property in the required notification area to constitute a valid protest petition. The property owner notification area covers the parcels lying within 200' of the special use permit request.

The total area of the real property represented by the six (6) parcels captured within the required 200 feet notification distance of the property in the request is 367,646.4 square feet (8.44 acres). The protest petition was signed by owners of 4 parcels. A fifth parcel was identified on the protest petition, but the signature on the petition does not match the owner information shown on the property owner notification list from the Douglas County Clerk's Office so it was not included in the calculations to determine validity of the petition.

The total area represented by the 4 parcels counted in the petition is 206,690.75 square feet (4.74 acres) or approximately 56.2% of the real property within the notification area. The protest petition is valid because it bears sufficient signatures of owners within the 200 feet notification area to meet or exceed the minimum 20% of the real property required by Code to constitute a valid protest petition.

The attached map illustrates the properties within the protest area whose owners are protesting this rezoning request.

The calculations for determining the validity of the petition are shown below:

Total Area of all Parcels w/in 200' of the Property in the Rezoning Request	367,646.4 sq. ft
Total Area of Parcels inside the Buffer Whose Owners are Protesting the Rezoning Request (4 Parcels)	206,690.75 sq. ft
Percent of Total Parcel Area in Protest Petition	$206,690.75 \text{ sq ft} / 367,646.4 \text{ sq ft} = 56.2\%$

SUP-01-03-10 Protest Petition

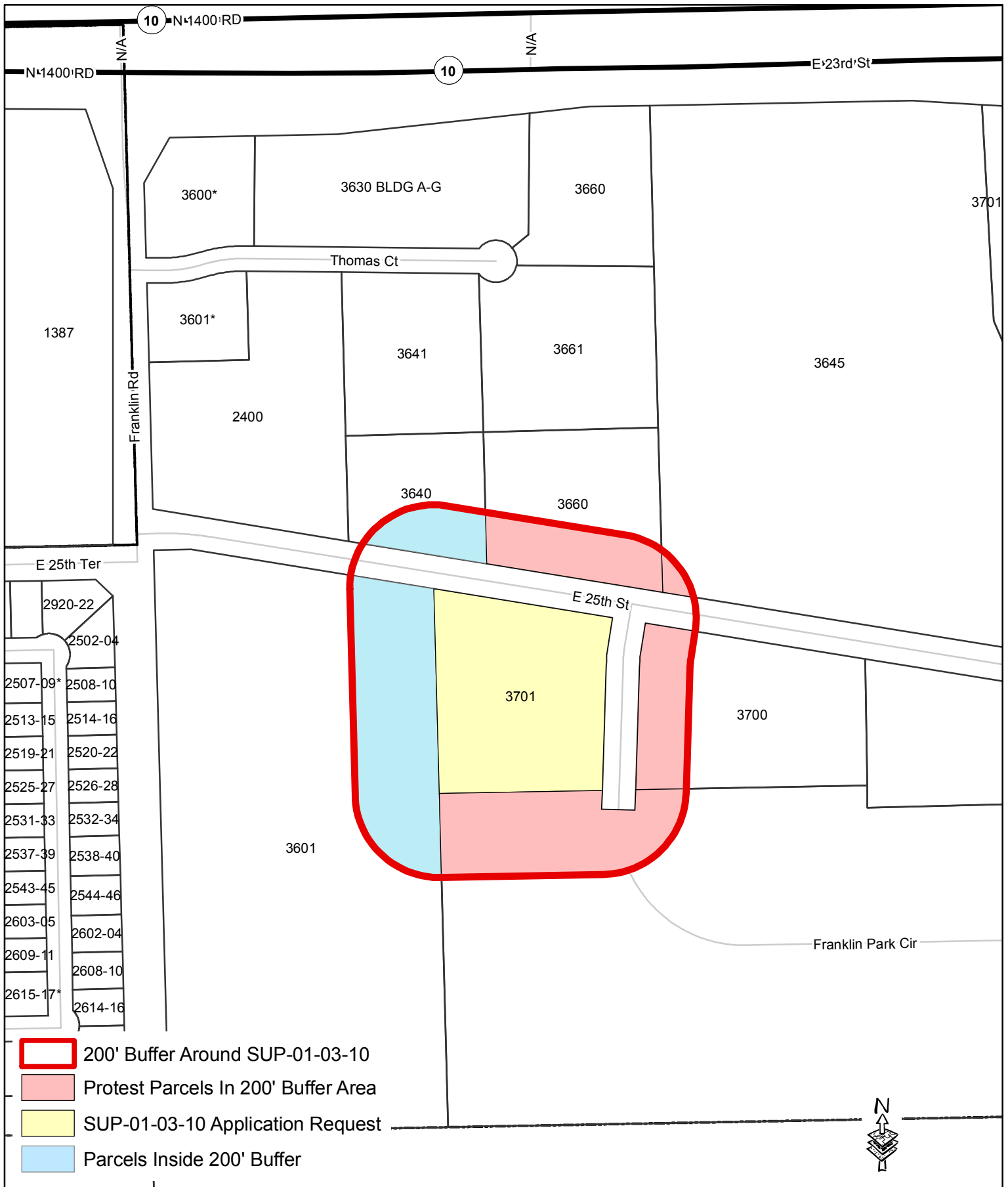

DISCLAIMER NOTICE

The map is provided "as is" without warranty or any representation of accuracy, timeliness or completeness. The burden for determining accuracy, completeness, timeliness, merchantability and fitness for or the appropriateness for use rests solely on the requester. The City of Lawrence makes no warranties, express or implied, as to the use of the map. There are no implied warranties of merchantability or fitness for a particular purpose. The requester acknowledges and accepts the limitations of the map, including the fact that the map is dynamic and is in a constant state of maintenance, correction and update.

City of Lawrence, Kansas
 Planning and Development Services Department
 April 6, 2010

RECEIVED

APR 02 2010

CITY CLERK
LAWRENCE, KANSAS**SPECIAL USE PERMIT PROTEST PETITION**

Protest Petition against SUP-01-03-10

We, the undersigned property owners, do hereby protest the SUP for the establishment of a Temporary Shelter by the Lawrence Community Shelter on the following described property:

Approximately 4.15 acres, located at 3701 Franklin Park Circle in Lawrence.

We, the undersigned, are owners of real property located within the statutory area of notification related to the area for which the SUP is sought. See K.S.A. 12-757(f).

Note: Print name legible below or beside signature. All owners of the property must sign.

PRINTED NAME AND
SIGNATURE OF OWNER

DESCRIPTION OF
PROPERTY WITHIN
NOTIFICATION AREA

RESIDENCE
ADDRESS
(IF DIFFERENT)

DATE

P.D.O. INVESTORS, L.L.C.

Unplatted 36.6 acre tract in
Section 9, Township 13,
Range 20, located directly
south and east of 3701
Franklin Park Cir.
Plate #U18550G

4705 Cherry Hills Ct.
Lawrence, KS 66047

April 1, 2010

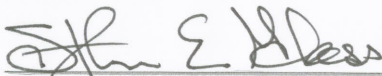

By: Stephen E. Glass, Manager

3700 Franklin Park Circle
Plate #U18550GA

2605 W 27th Ter.
Lawrence, KS 66047

March 31, 2010

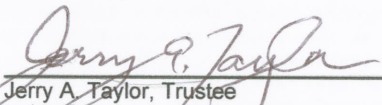

Jerry A. Taylor, Trustee

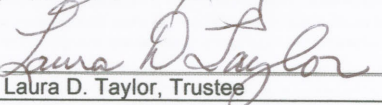

Laura D. Taylor, Trustee

Mt. Blue, L.C.

3640 East 25th Street
Plate #U18549G

4100 W. 6th Street
Lawrence, KS 66049

April 1, 2010

Bluejacket Ford, L.L.C., Manager

3660 East 25th Street
Plate #18549F

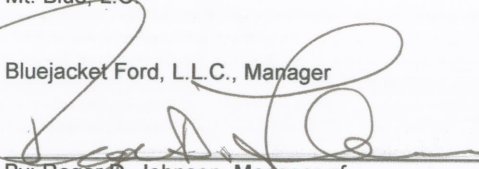
By: Roger D. Johnson, Manager of
Bluejacket Ford, L.L.C.

3660 East 25th Street
Plate #18549F

1705 N. 1399 Road
Lawrence, KS 66046

April 1, 2010

Roger D. Johnson

Lawrence Real Estate Subsidiary, L.L.C.

3645 East 23rd Street
Plate #18550

1705 N. 1399 Road
Lawrence, KS 66046

April 1, 2010



By: Roger D. Johnson, Manager

STATE OF KANSAS)
) ss:
COUNTY OF DOUGLAS)

I am the circulator of this Special Use Permit Protest Petition and a resident of the state of Kansas and possess the qualifications of an elector of the State of Kansas. I have personally witnessed the signing of the Protest Petition by each person whose name appears thereon.



Circulator Signature

Stephen E. Glass

Printed Name

Circulator's Residence and Address:
4705 Cherry Hills Ct., Lawrence, KS 66047

Date April 1, 2010

Signed and sworn to (or affirmed) before me on this 1st day of April, 2010, by Stephen E. Glass, circulator of this Protest Petition.



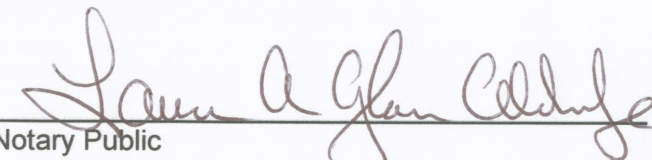

Notary Public

My appointment expires: 6/18/10