

[illegible]

NOTE: Foundation Plantings to be found on Sheet 2 of 2.

PLANT SCHEDULE

QTY	BOTANICAL NAME	COMMON NAME	SIZE	CONDITION	REMARKS
<i>Inverness Drive Street Trees</i>					
6	<i>Picea abies</i>	Norway Spruce	4'-5' Tall	B&B	Single Stem Only
3	<i>Pinus strobus</i>	White Pine	4'-5' Tall	B&B	Single Stem Only
11	<i>Platanus acerifolia</i>	London Plane Tree	3" Cal.	B&B	Single Stem Only
8	<i>Ulmus parvifolia</i>	Loebachr Elm	3" Cal.	B&B	Single Stem Only
<i>Other Street Trees and Interior Trees</i>					
24	<i>Acer rubrum</i> 'Red Sunset'	Red Sunset Maple	2.5" Cal.	B&B	Single Stem Only
5	<i>Quercus acutissima</i>	Sawtooth Oak	2.5" Cal.	B&B	Single Stem Only
5	<i>Quercus bicolor</i>	Swamp White Oak	2.5" Cal.	B&B	Single Stem Only
13	<i>Platanus acerifolia</i>	London Plane Tree	2.5" Cal.	B&B	Single Stem Only
5	<i>Pyrus calleryana</i>	Cleveland Select Pear	2.5" Cal.	B&B	Single Stem Only
5	<i>Tilia cordata</i> 'Greenspire'	Greenspire Linden	2.5" Cal.	B&B	Single Stem Only
6	<i>Ulmus parvifolia</i>	Loebachr Elm	2.5" Cal.	B&B	Single Stem Only

PLANT SCHEDULE

SYMBOL	QTY	BOTANICAL NAME	COMMON NAME	SIZE	CONDITION	REMARKS
		Open Space Trees				
		65 Cercis canadensis	Eastern Redbud	1.25' Cal.	B&B	Single Stem Only
	1	Platanus acerifolia	London Plane Tree	1.5' Cal.	B&B	Single Stem Only
	2	Quercus shumardii	Shumard Oak	1.5' Cal.	B&B	Single Stem Only
	78	Thuja occidentalis 'Smaragd'	Emerald Green Arborvitae	4'-5' Tall	B&B	Single Stem Only
	2	Ulmus parvifolia	Labebark Elm	1.5' Cal.	B&B	Single Stem Only
		Building / Foundation Trees				
		65 Juniperus chinensis	Keteleeri Chinese Juniper	3'-Gal.	Container	Full & Healthy
	88	Thuja occidentalis 'Smaragd'	Emerald Green Arborvitae	3'-Gal.	Container	Full & Healthy
		Shrubs				
	176	Euonymus alatus 'Compactus'	Compact Burning Bush	2'-Gal.	Container	Full & Healthy
	208	Rosa 'Radrazz'	Knock Out Rose	2'-Gal.	Container	Full & Healthy
	119	Spiraea x bumalda 'Anthony Waterer'	Anthony Waterer Spirea	2'-Gal.	Container	Full & Healthy
	66	Viburnum x burkwoodii	Burkwood Viburnum	2'-Gal.	Container	Full & Healthy

SITE LANDSCAPE PLAN

Scale 1"= 40'-0"

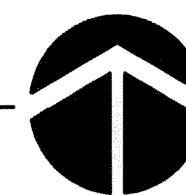

3

- 3 Revised 02.22.10
 2 Revised 02.12.10
 1 Revised 01.11.10

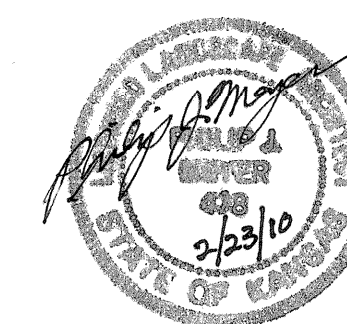

Baughman
ENGINEERING | SURVEYING | PLANNING
LANDSCAPE ARCHITECTURE

Baughman Company, P.A.
315 Ellis Wichita, KS 67211
P316-262-7271 F316-262-0149

CLINTON PARKWAY CASITAS
4300 W 24th PLACE, LAWRENCE, KS 66047

SITE PLAN

BG
CONSULTANTS
architects
engineers
planners
surveyors

Project No. 09-1196L
Date: Dec. 29, 2009
Revised:

SHEET NO.

1

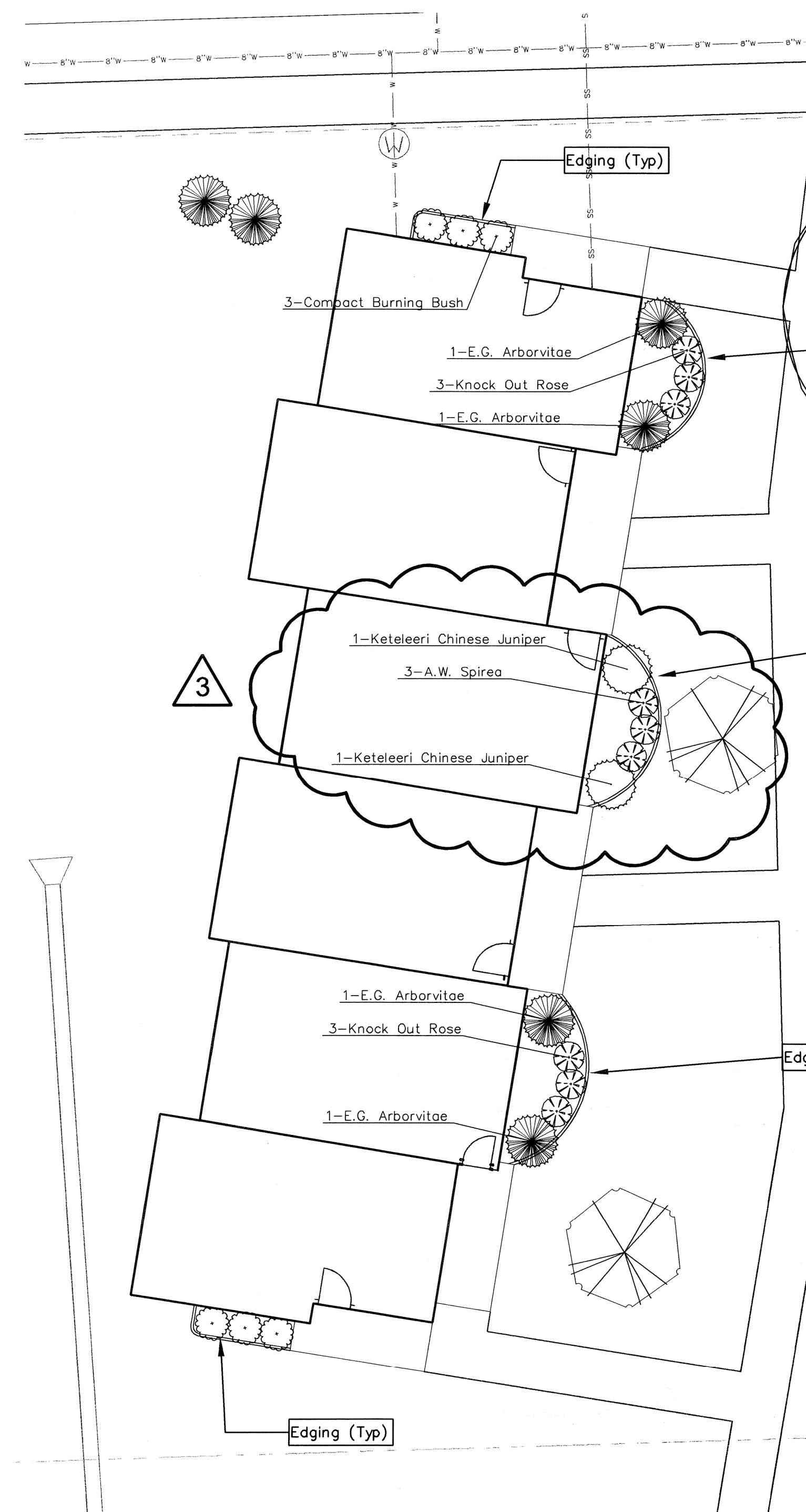

TYPICAL BUILDING PLAN
Scale 1"= 40'-0"

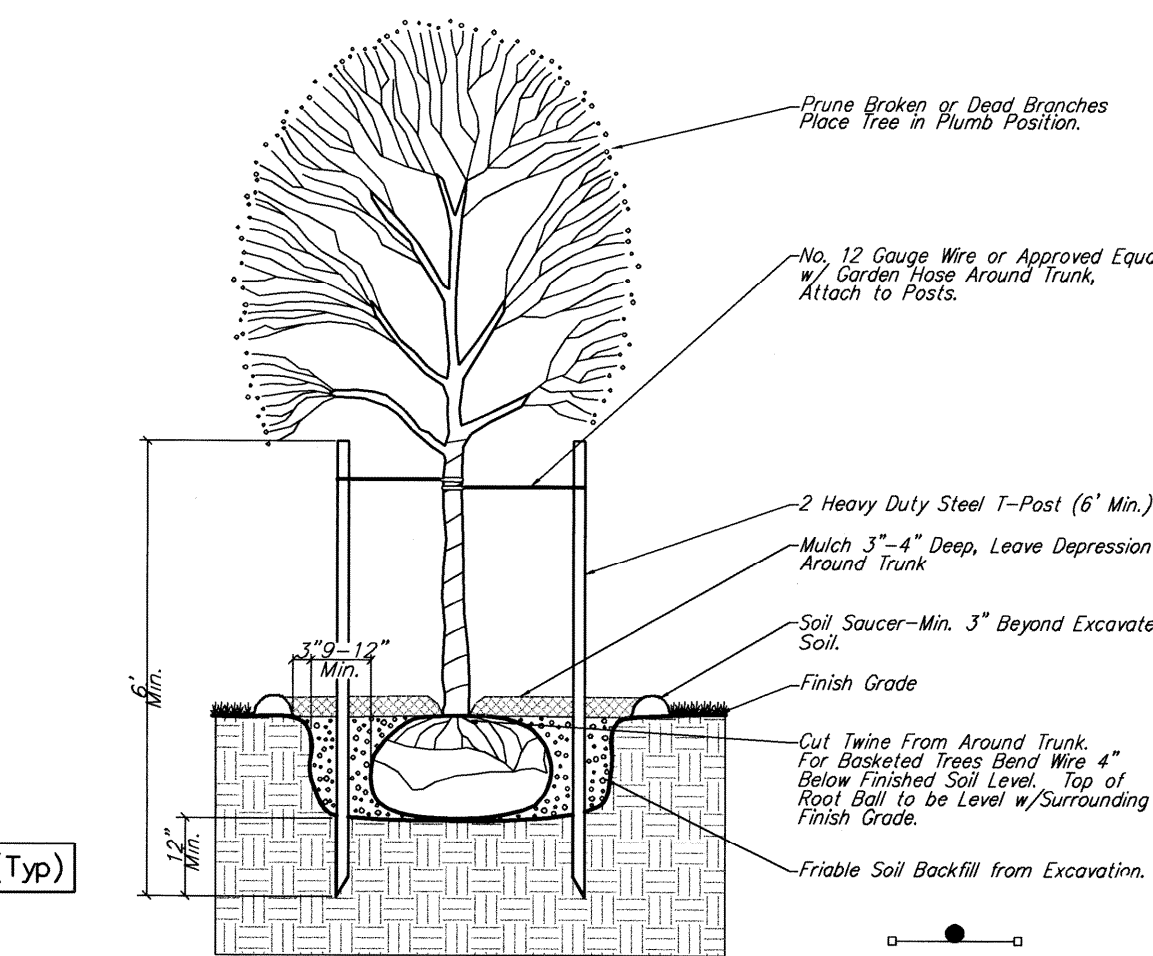

1 TREE PLANTING & STAKING DETAIL
Deciduous Trees Larger than 2" Cal.
Evergreen Trees Larger than 6' Height
No Scale

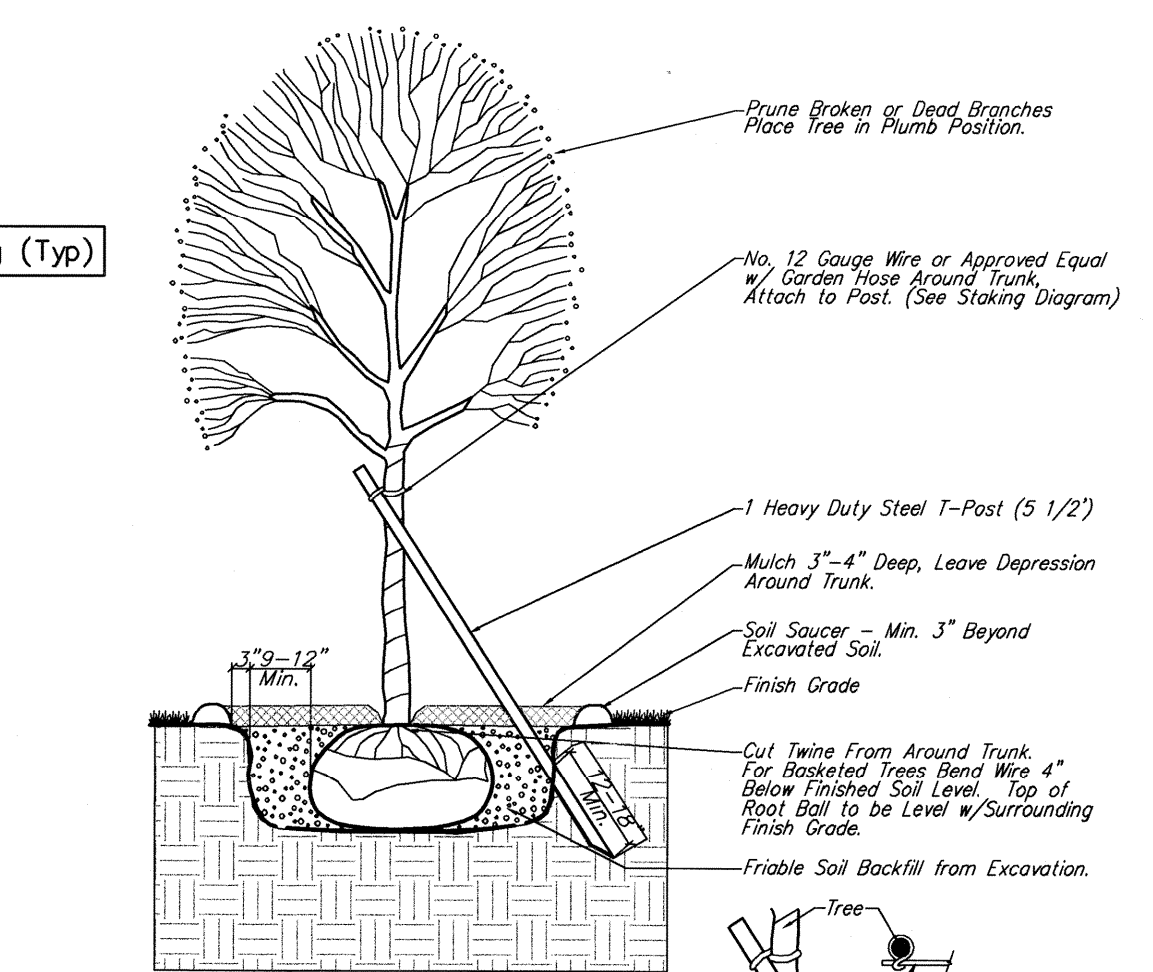

2 TREE PLANTING & STAKING DETAIL
Deciduous Trees 2" Cal. and Smaller
Evergreen Trees 6' Height and Smaller
No Scale

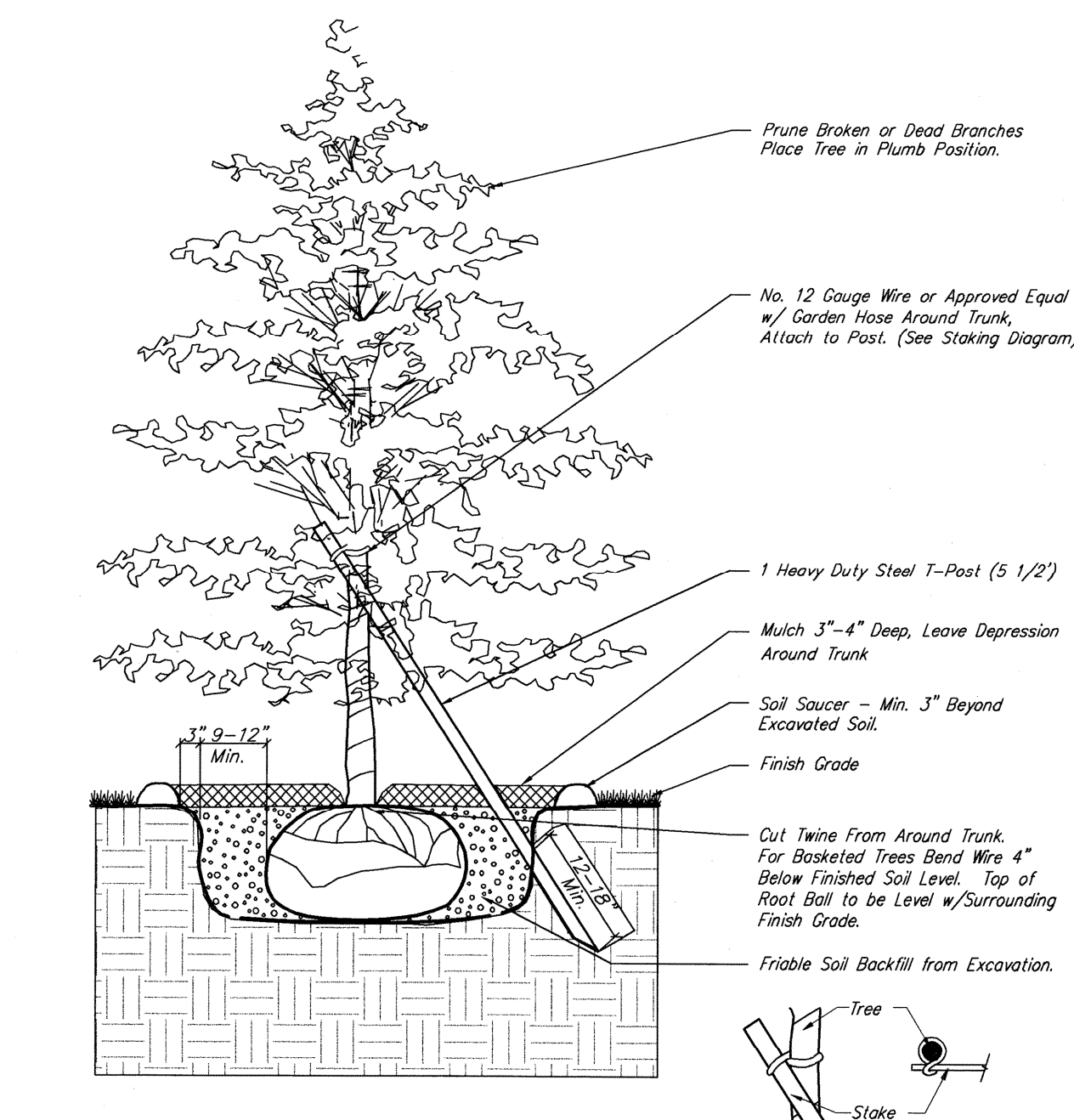

3 TREE PLANTING & STAKING DETAIL
Deciduous Trees 2" Cal. and Smaller
Evergreen Trees 6' Height and Smaller
No Scale

LANDSCAPE NOTES:

- All landscape work shall be done in accordance with industry standards.
- All areas called out on the plan as "Sod" or "Seed" shall be installed and fertilized as follows:
SOD--Kansas Premium Fescue Sod or Equal
SEED--Kansas Premium Fescue Seed or Equal
FERTILIZER--16-20-6 ratio 4#/1000 sq. ft. of Equal
- Trees with broken leaders or no central leader will not be accepted.
- All planting beds shall be prepared by killing all existing vegetation with Round-Up (or equal) according to label directions. A Pre-emergent herbicide such as Treflan (5%) (or equal) shall be applied per label directions. All planting beds to receive 2" organic matter (such as cotton bur mulch, compost, or humus) and shall be rototilled in to a depth of 10-12".
- Mulch all planting beds with min. 3" of mulch. Mulch all tree saucer wells with min. 3" of mulch. Mulch material to be gravel rock (or equal) of uniform consistency.
- Metal edging shall be used to separate all turf areas from planting beds. Edging shall be 10 gauge thickness, commercial grade, or approved equal.
- General Contractor to supply and place at a depth of 4", all topsoil on site.
- Topsoil hauled onto site shall be fertile, friable, natural loam topsoil, of uniform quality characteristic of representative local soils which produce heavy growth of crops, grass, or other vegetation. It shall be free of trash, or other matter toxic to plant growth.
- Topsoil shall be delivered in an unfrozen and non-muddy condition and shall be subject to approval by the Landscape Architect.
- Prior to any excavation for landscaping purposes the location of underground utilities shall be determined by calling Kansas One Call at 1-800-344-7233. Contractor shall be responsible for any damage done to existing utilities.
- Report any discrepancies in the planting plan to the Landscape Architect, prior to starting construction.
- The Landscape Contractor shall coordinate with the G.C. to gain site access to install the plants and maintain grounds, until final acceptance from owner. Upon final acceptance, the one (1) year guarantee period will begin.
- The Landscape Contractor shall coordinate with the G.C. to install the plants and maintain grounds, until final acceptance from owner.
- The Landscape Contractor shall submit bid with unit prices for all plants, including mulch, installation, 1 year guarantee, bed preparation, fertilizer, etc.
- The Landscape Contractor is responsible for any damage done to the exterior of the building or any part of the parking lot when installing or maintaining the plantings before final acceptance.
- General Contractor to coordinate with appropriate Local City Official to Remove/Transplant exist trees.
- Fall planting season shall be September 1 thru October 31. Spring planting season shall be April 1 thru June 30. For grass seeding, fall season shall be September 1 thru mid October. Spring season for seeding shall be from March 15 thru mid May.
- Landscape Contractor shall provide maintenance until final project acceptance including landscape maintenance and watering.
- This landscape project is to be irrigated by an automatic irrigation system. The entire site will be irrigated, except for the Right-Of-Way north of the existing hedgerow along Clinton Parkway.
- Secondary water supply to be available by an exterior hose bib on each building.
- Owner shall donate 3 trees to be placed in the Inverness Drive median. Species are two (2) Swamp White Oak, *Quercus bicolor* and one Snowdrift Crabapple, *Malus sp.*. All trees to be 3" Cal., B&B.

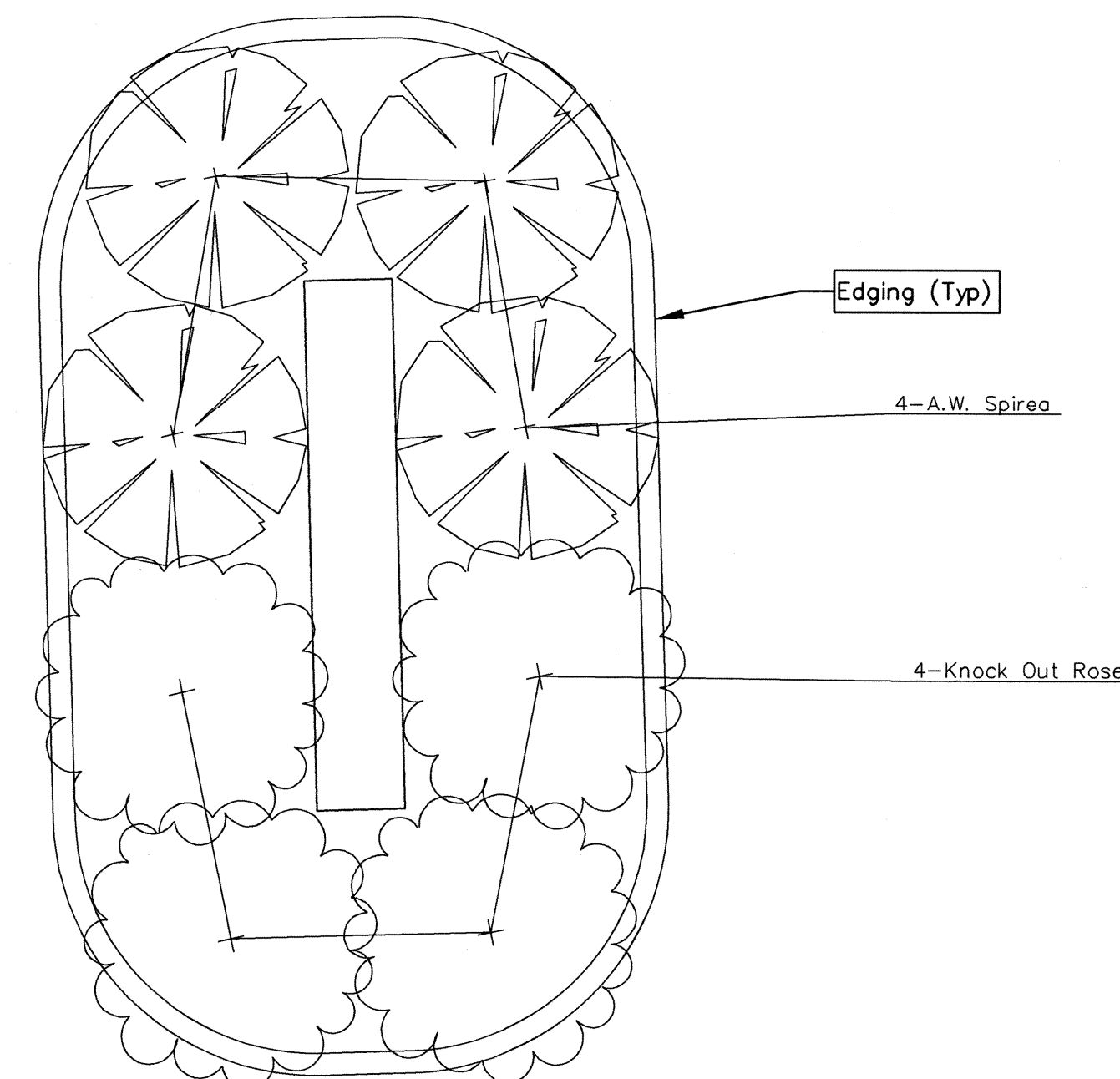

TYPICAL SIGNAGE PLAN
Not to Scale

- 3 Revised 02.22.10
- 2 Revised 02.12.10
- 1 Revised 01.11.10



Baughman Company, P.A.
315 Ellis Wichita, KS 67211
316-262-7271 F316-262-0149

CLINTON PARKWAY CASITAS
4300 W 24th PLACE, LAWRENCE, KS 66047

SITE PLAN

BG
CONSULTANTS
architects engineers planners surveyors

Project No. 09-1196L
Date: Dec. 29, 2009
Revised:

SHEET NO.

2

I N V E R N E S S D R I V E

C L I N T O N P A R K W A Y

2 4 T H P L A C E

2 4 T H P L A C E



Baughman Company, P.A.
315 Ellis Wichita, KS 67211
P316-262-7271 F316-262-0149



CLINTON PARKWAY CASITAS

