

AIRPORT WORK ITEM	Lawrence Municipal	LOCAL PRIORITY	UPDATED In what FY do you want to construct?	02/10
	CAPITAL IMPROVEMENT PROGRAM, FY2009 – FY2017			

SKETCH:

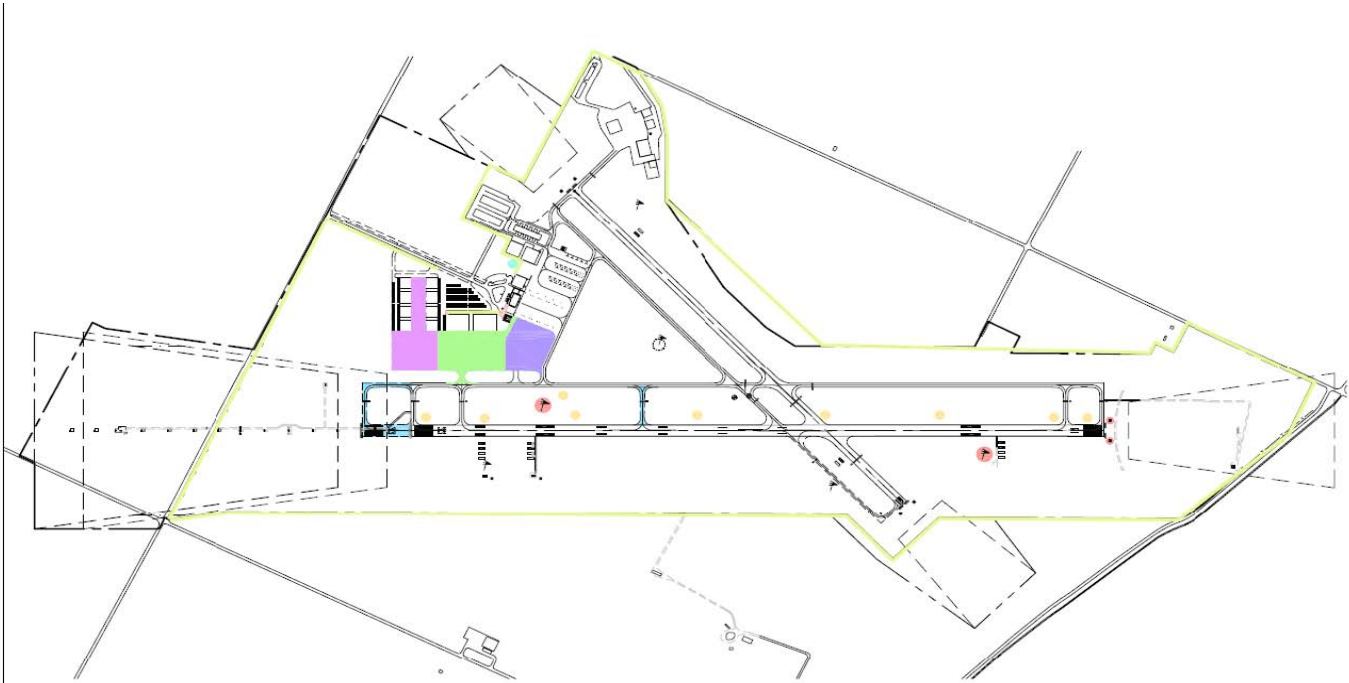

#### JUSTIFICATION:

Lawrence Municipal Airport is a general aviation facility located approximately three miles north of the central business district of Lawrence, Kansas. It is about one mile east of the Kansas River and one mile north of Interstate 70. Access to the airport is via U.S. Highway 24/40. The airport currently has approximately 85 based aircraft, two of which are business jets and six are multi-engine. Approximately 40,000 total annual aircraft operations occur at the airport. The airport currently has two paved runways. Primary Runway 15-33 is 5,700 feet long and 100 feet wide. It is served by a Category I precision instrument landing system (ILS) and medium intensity approach lighting system with runway alignment indicator lights (MALSR) on Runway 33. Secondary Runway 1-19 is 3,900 feet long and 75 feet wide. It has only visual approaches. The runways are served by taxiway systems leading to aircraft parking areas and the airport building area. To accommodate current and projected aviation demand in the Lawrence Municipal Airport's service area and upgrade the facility to current FAA design standards, the following Capital Improvements Plan is recommended

Sponsor Signature:

Date:

#### COST ESTIMATE:

2009	Acquire Land for Approaches	250,000
2010	Airport Master Plan Update	150,000
2011	Taxiway 1/19 Expansion/Completion (NE)	412,250
2011	Wildlife Assessment Plan	50,000
2012	Install REILS for Runway 15 and Wind Cones for Runway 15-33	65,000
2012	Install Airport Signage for Part 139 and Jet Operations	135,000
2013	Rehabilitate Runway 15/33	2,000,000
2014	East Apron Expansion Phase I (20,000 S.Y. +/-)	2,310,000
2015	Equipment Storage Building, SRE and ARFF Equipment	715,000
2016	East Apron Expansion, Phase II (15,000 S/Y. +/-)	1,910,000
2016	Environmental Assessment for Runway Extension	75,000
2017	Extend Runway 15-33 (400' x 100') and Taxiway A (400' x 35')	2,750,000
Future	Expand Aircraft Parking Apron (Phase III) (15,000 S.Y.)	1,925,000
Future	Install Airport Perimeter/Security Fencing	600,000

SKETCH:

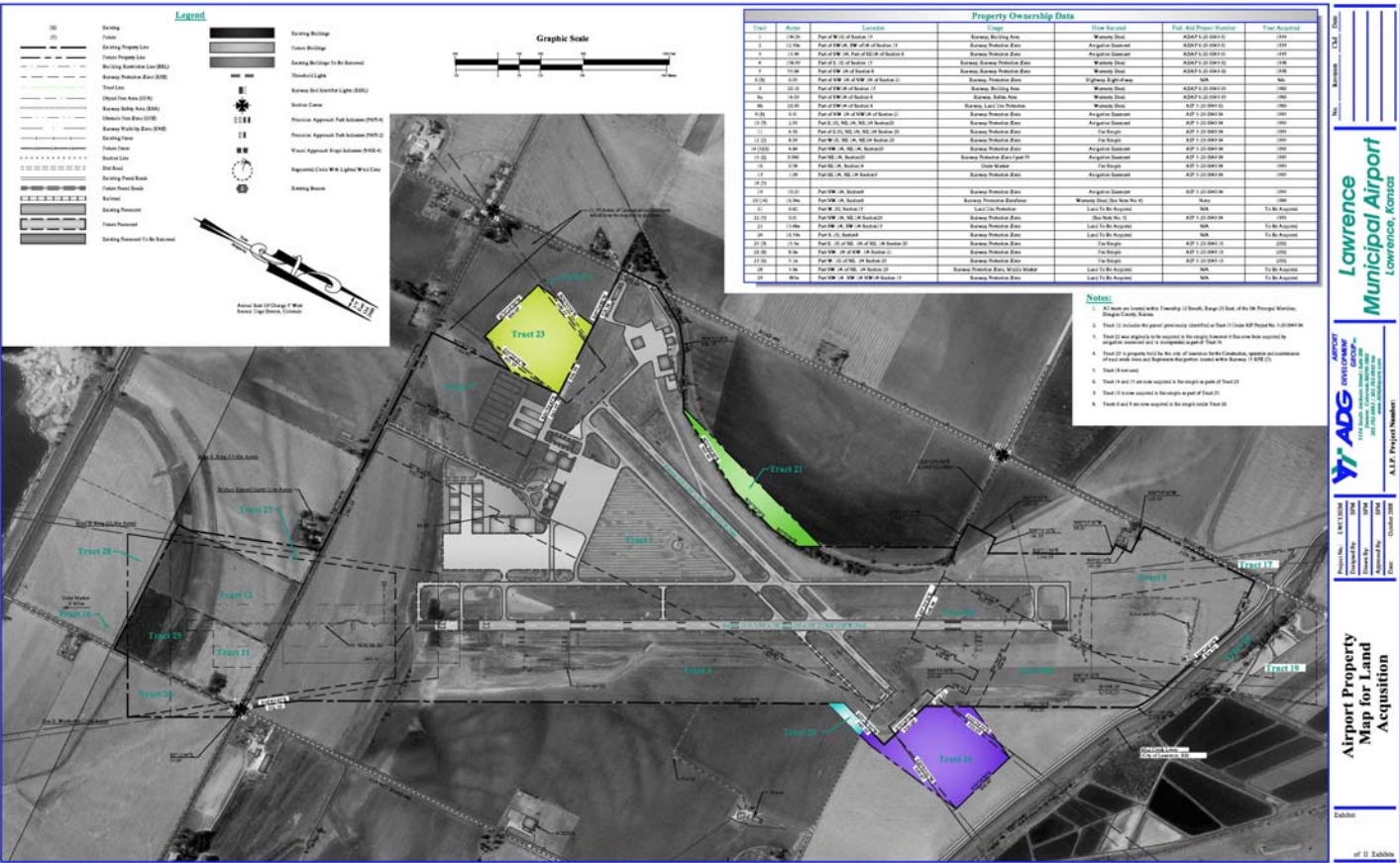

JUSTIFICATION:

Acquire property for runway protection zone. The tracts will be acquired in fee.

Sponsor Signature:			Date:	
COST ESTIMATE:				
Description	Quantity	Unit	Unit Cost	Est. Cost
Land	1	L.S.	\$200,000.00	\$200,000
Easements	1	L.S.	-0-	-0-
Land Acquisition Assistance	1	L.S.	20,000.00	\$20,000
Survey & Appraisals	1	L.S.	15,000.00	15,000
Administration	1	L.S.	10,000.00	10,000
Total			\$245,000.00	\$245,000

PREAPP NUMBER	GRANT NUMBER	NPIAS CODE	WORK CODE	FAA PRIORITY	FEDERAL \$

AIRPORT WORK ITEM	Lawrence Municipal	LOCAL PRIORITY	02	UPDATED In what FY do you want to construct?	02/10
	Airport Master Plan Update				2010

SKETCH:

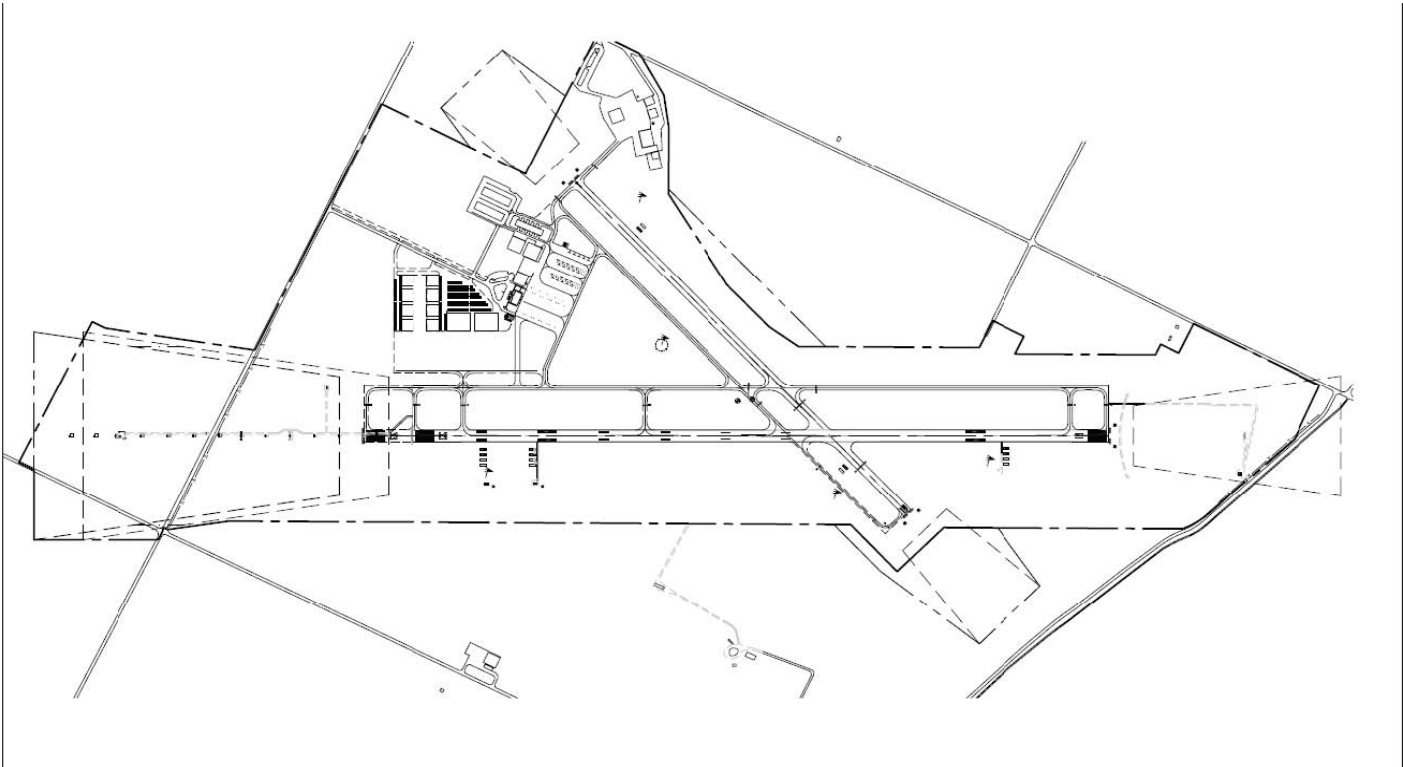

JUSTIFICATION:  
Update the Airport Master Plan to reflect new design standards as well as changes to the airport's utilization and future planning.

Sponsor Signature: _____			Date: _____		
COST ESTIMATE:					
<u>Description</u>		<u>Quantity</u>	<u>Unit</u>	<u>Unit Cost</u>	<u>Est. Cost</u>
Airport Master Plan Update		1	L.S.	\$ 150,000.00	\$ 150,000
					\$ 150,000

PREAPP NUMBER	GRANT NUMBER	NPIAS CODE	WORK CODE	FAA PRIORITY	FEDERAL \$

AIRPORT WORK ITEM	Lawrence Municipal	LOCAL PRIORITY	03	UPDATED In what FY do you want to construct?	02/10
	Construct Partial Parallel Taxiway to Runway 19				2011

SKETCH:

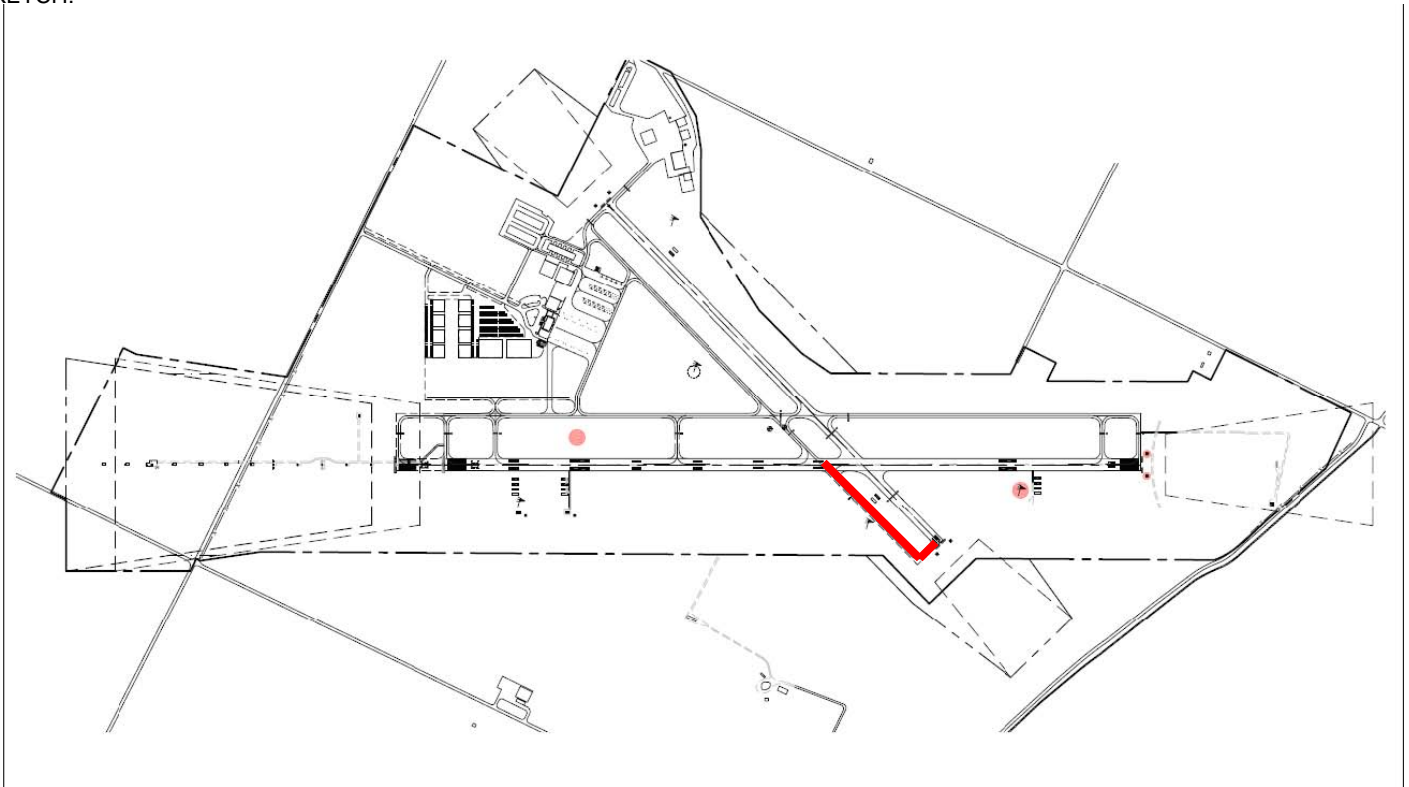

JUSTIFICATION:

To maintain a smooth flow of ground traffic, increase the airport's margin of safety for ground operations, and to increase runway capacity, a partial parallel taxiway to Runway 1-19 will be constructed. This taxiway will be located on the east side of the runway at a separation of 225 feet from the runway centerline and a width of 25 feet. Medium intensity taxiway edge lighting and airfield signage will be included in this item. Pavements will be designed to accommodate 12,500 lbs. SWG and marked in accordance with current standards.

Construction offset parallel taxiway to Runway 1-19 will eliminate the need to back taxi on the north end of the runway.

Sponsor Signature:

Date:

COST ESTIMATE:

Description	Quantity	Unit	Unit Cost	Est. Cost
Embankment	1	L.S.	50,000.00	\$ 50,000
Sub Base Course	6,000	S.Y.	10.00	60,000
Aggregate Base Course	6,000	S.Y.	8.00	48,000
Asphalt Paving	750	Ton	75.00	56,250
Drainage Improvements	1	L.S.	40,000.00	40,000
Marking & Obliteration	1	L.S.	5,000.00	5,000
Seeding	1	L.S.	3,000.00	3,000
Lighting & Signage	1	L.S.	75,000.00	75,000
Engineering and Testing	1	L.S.	75,000.00	75,000
Total				\$ 412,250

PREAPP NUMBER	GRANT NUMBER	NPIAS CODE	WORK CODE	FAA PRIORITY	FEDERAL \$

AIRPORT WORK ITEM	Lawrence Municipal	LOCAL PRIORITY	04	UPDATED In what FY do you want to construct?	02/10
	Wildlife Assessment and Mitigation Plan				2011

SKETCH:

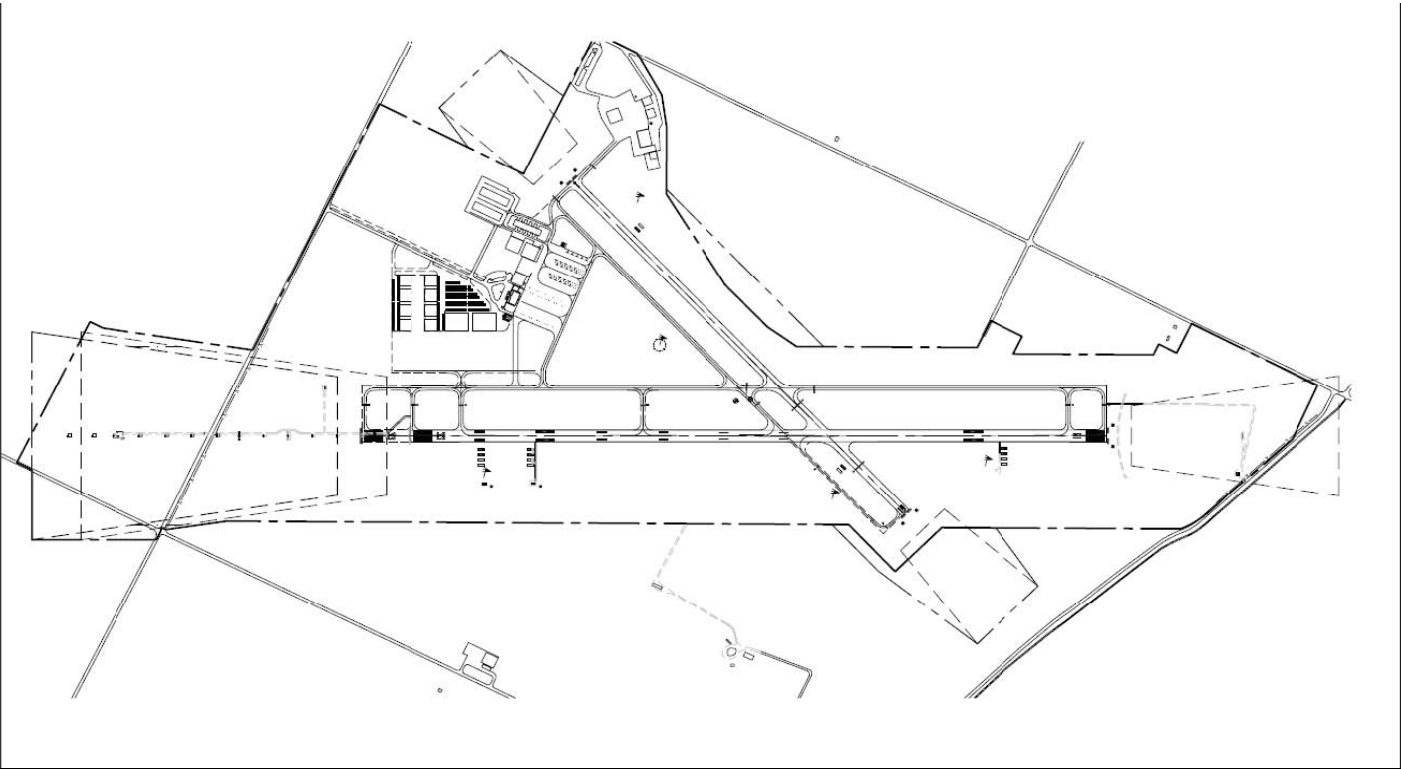

JUSTIFICATION:  
Development of wildlife assessment and mitigation plan.

Sponsor Signature: _____			Date: _____		
COST ESTIMATE:					
	<u>Description</u>	<u>Quantity</u>	<u>Unit</u>	<u>Unit Cost</u>	<u>Est. Cost</u>
	Wildlife Assessment Plan	1	L.S.	\$ 50,000.00	\$ 50,000
					\$ 50,000

PREAPP NUMBER	GRANT NUMBER	NPIAS CODE	WORK CODE	FAA PRIORITY	FEDERAL \$

<b>AIRPORT WORK ITEM</b>	Lawrence Municipal	<b>LOCAL PRIORITY</b>	05	UPDATED In what FY do you want to construct?	02/10
	Install Runway End Identifier Lights (REIL) on Runway 15, and Install Supplemental Wind Cone on Approach End of runway 15-33.				2012

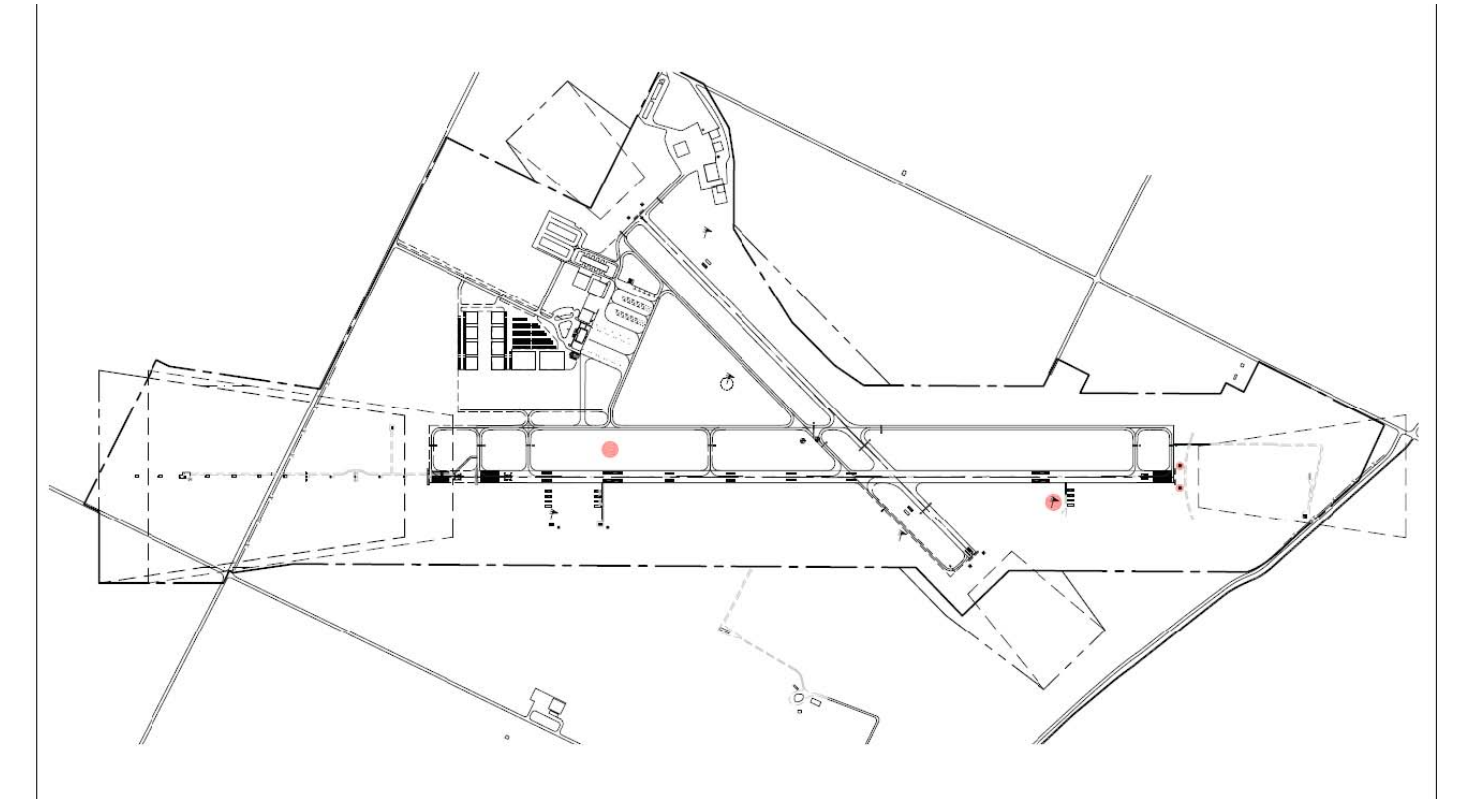

**JUSTIFICATION:**

To improve safety of all airfield operations, it is recommended that additional visual approach aids be installed on the airfield. All items will be installed in accordance with FAA specification requirements. The REILs will provide visual cues to pilots during their landing approach to the runway end at night and during times of reduced visibility. The supplemental wind cones for Runways 15 and 33 will provide more accurate wind direction and velocity information to pilots during their takeoff and landing approach.

Sponsor Signature: \_\_\_\_\_

Date \_\_\_\_\_

**COST ESTIMATE:**

Description	Quantity	Unit	Unit Cost	Est. Cost
Cable, 1/C #8, 5kV L-824C	2,000	L.F.	\$ 1.25	\$ 2,500
Direct Burial Duct	1,000	L.F.	4.00	4,000
Junction Box	2	Each	500.00	1,000
REIL System	1	Each	15,000.00	15,000
L-806 8' Wind Cone	2	Each	7,500.00	15,000
Power & Control Equipment	1	L.S.	10,000.00	10,000
Engineering and Testing	1	L.S.	17,500.00	17,500
<b>Total</b>				<b>\$ 65,000</b>

PREAPP NUMBER	GRANT NUMBER	NPIAS CODE	WORK CODE	FAA PRIORITY	FEDERAL \$

AIRPORT WORK ITEM	Lawrence Municipal	LOCAL PRIORITY	06	UPDATED	02/10
	Install Airfield Signage for Part 139 and Jet Operations			In what FY do you want to construct?	2012

SKETCH:

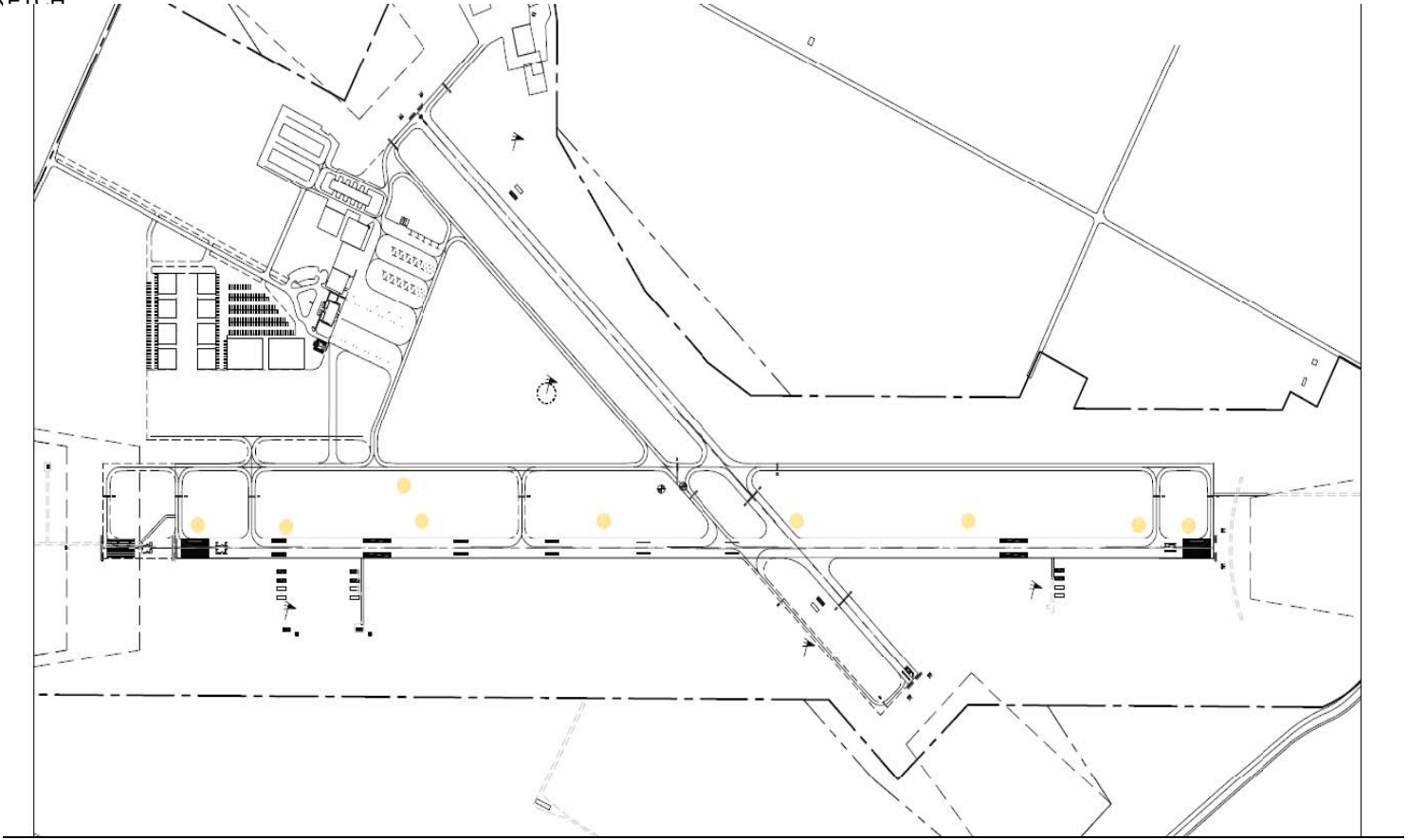

**JUSTIFICATION:**

The existing airfield signage along Runway 15-33 needs to be upgraded and improved to meet Part 139 standards. In addition, Runway Distance Remaining signs are recommended for all jet runways. Tasks include sign removal, installation, and grading to meet current standards.

Sponsor Signature \_\_\_\_\_

Date: \_\_\_\_\_

**COST ESTIMATE:**

Description	Quantity	Unit	Unit Cost	Est. Cost
Runway and Taxiway Signs	1	L.S.	\$ 90,000.00	90,000
Power and Control Equipment	1	L.S.	10,000.00	10,000
Engineering and Testing	1	L.S.	35,000.00	35,000
<b>Total</b>				<b>\$ 135,000</b>

PREAPP NUMBER	GRANT NUMBER	NPIAS CODE	WORK CODE	FAA PRIORITY	FEDERAL \$

AIRPORT WORK ITEM	Lawrence Municipal	LOCAL PRIORITY	07	UPDATED In what FY do you want to construct?	02/10
	Rehabilitate Runway 15/33				2013

SKETCH:

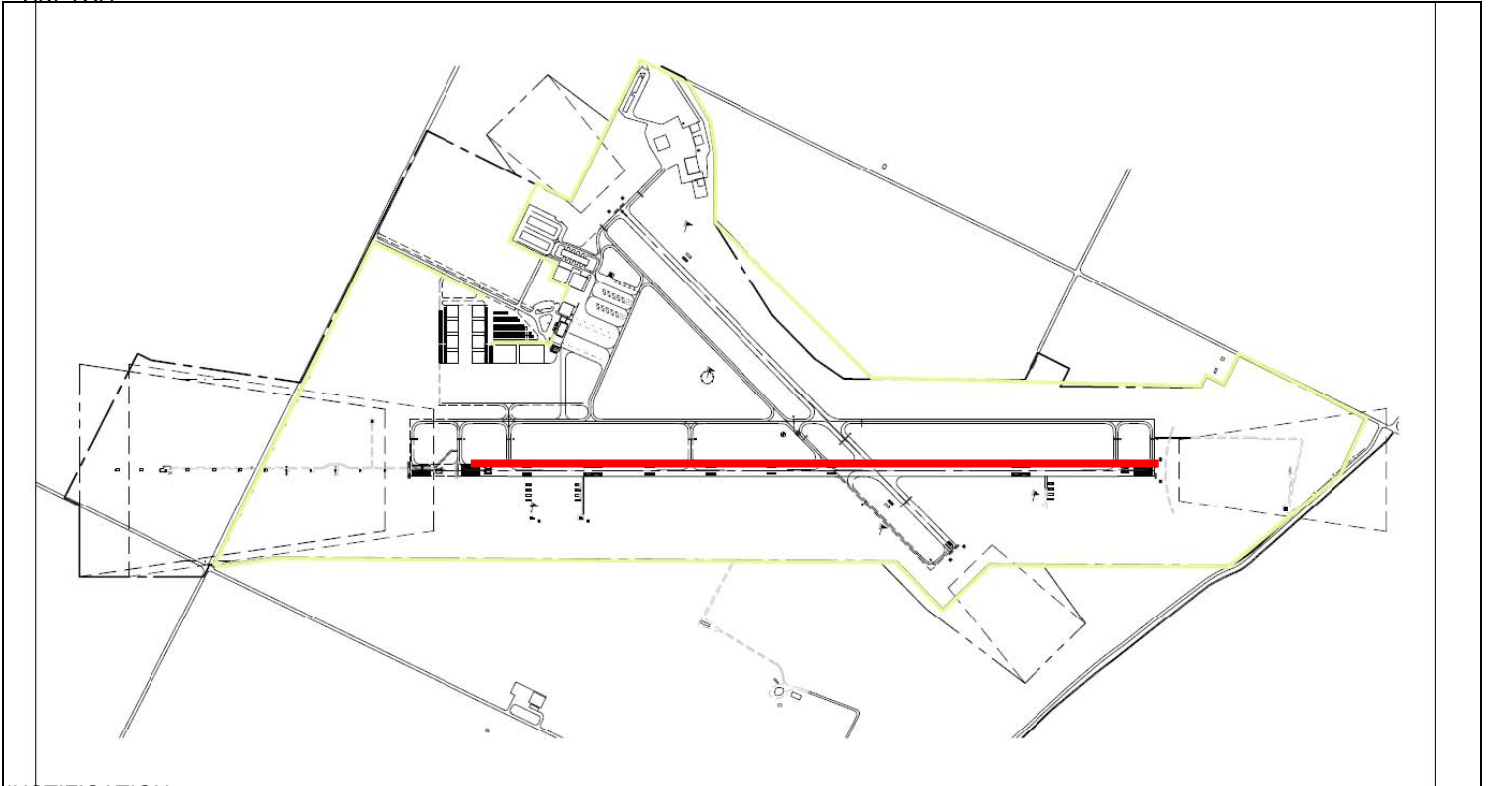

**JUSTIFICATION:**

To improve safety of all airfield operations. All items will be installed in accordance with FAA specification requirements. Runway 15/33 will need new surfacing.

Sponsor Signature: \_\_\_\_\_

Date: \_\_\_\_\_

**COST ESTIMATE:**

Description	Quantity	Unit	Unit Cost	Est. Cost
Mill & Overlay	2,200	S.Y.	\$80.00	\$ 1,760,000
Striping	1	L.S.	40,000.00	40,000
Engineering & Testing	1	L.S.	200,000.00	200,000
<b>TOTAL</b>				<b>\$ 2,000,000</b>

PREAPP NUMBER	GRANT NUMBER	NPIAS CODE	WORK CODE	FAA PRIORITY	FEDERAL \$



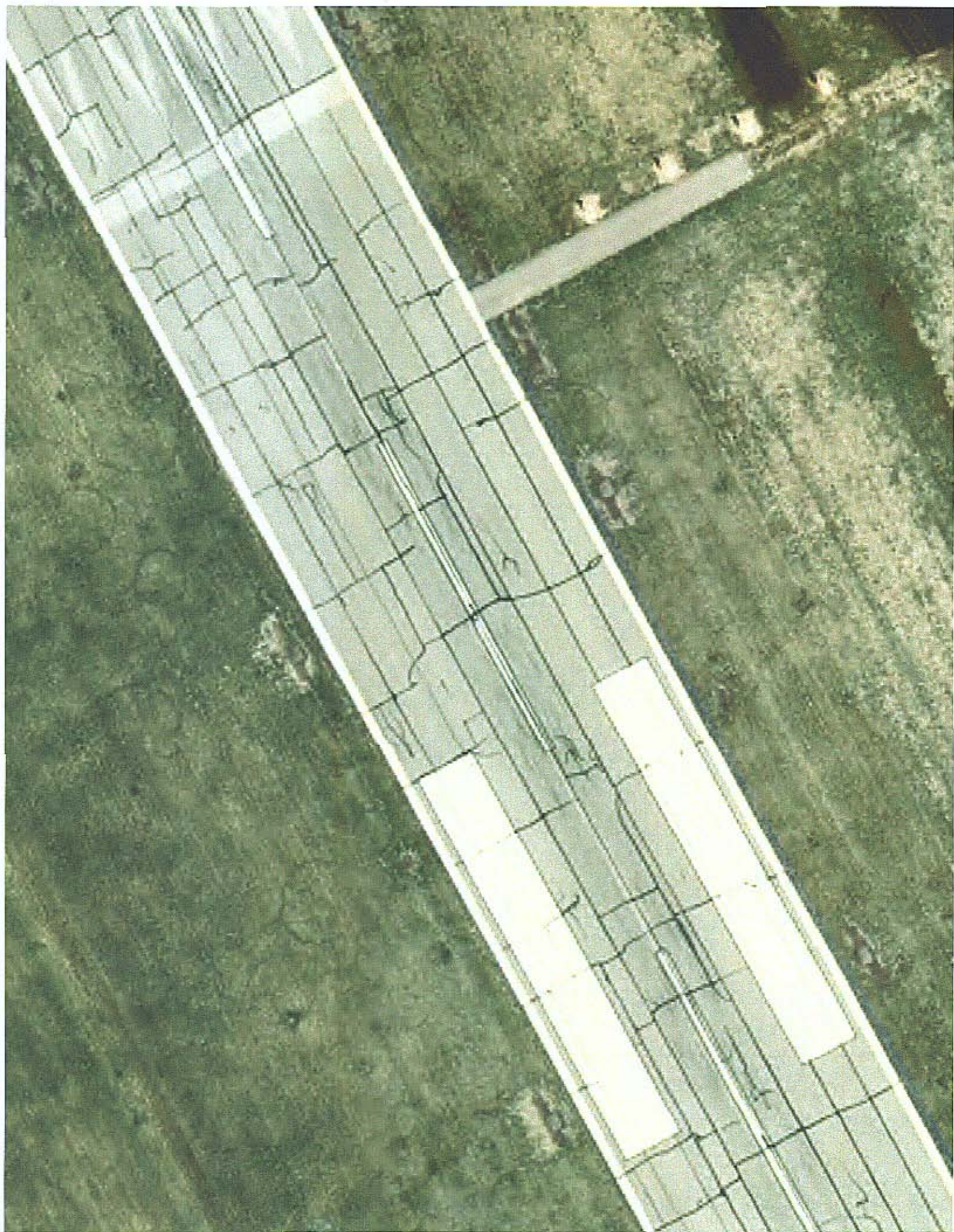

AIRPORT WORK ITEM	Lawrence Municipal	LOCAL PRIORITY	08	UPDATED In what FY do you want to construct?	02/10
	Expand Aircraft Parking Apron (Phase 1) (20,000 S.Y.)				2014

SKETCH:

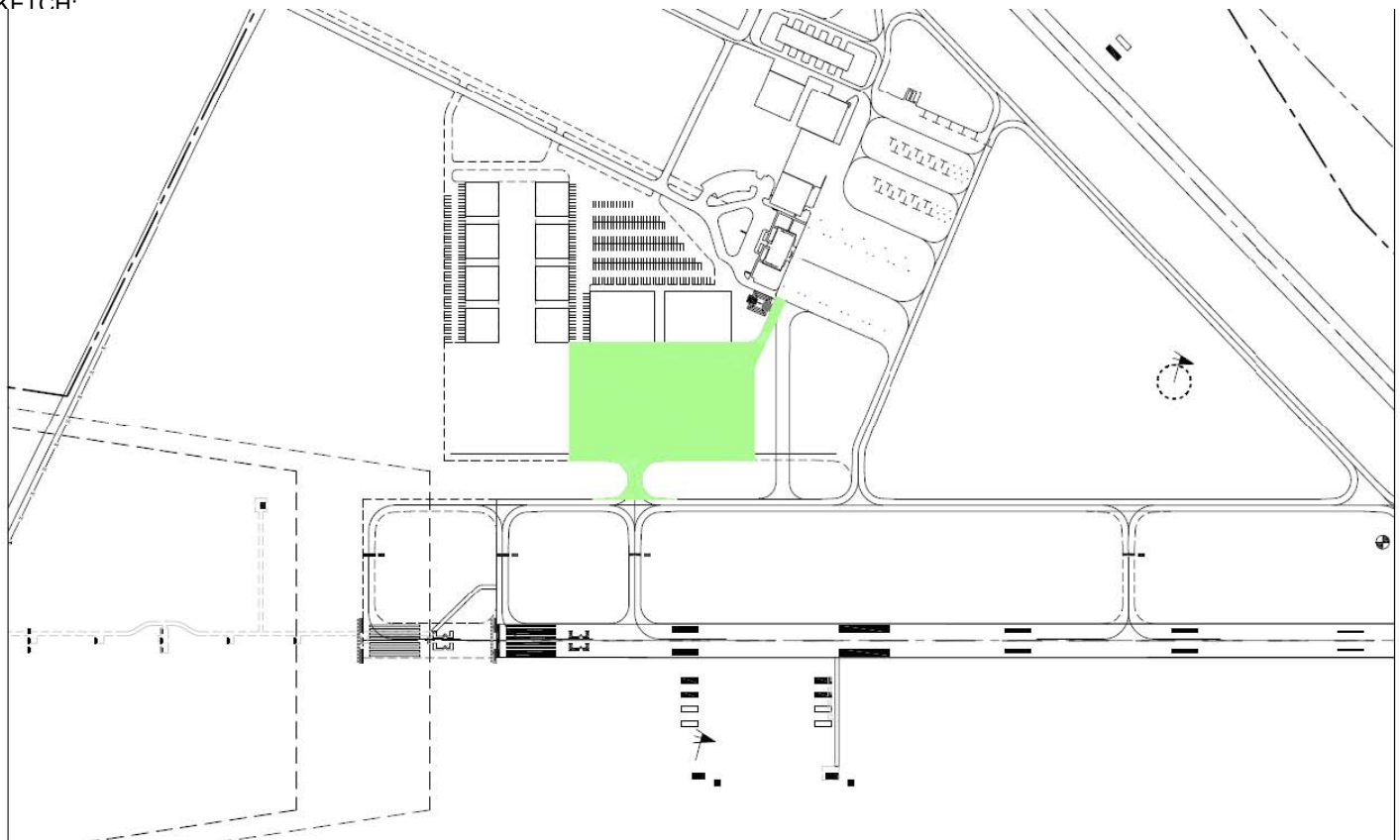

**JUSTIFICATION:**

Phase I Aircraft Parking Apron Expansion to meet forecast demand for airport operations, based and itinerant aircraft demands. Design loading 60,000 DWG.

Sponsor Signature: \_\_\_\_\_

Date: \_\_\_\_\_

**COST ESTIMATE:**

Description	Quantity	Unit	Unit Cost	Est. Cost
Mobilization	1	L.S.	\$75,000.00	\$ 75,000
Embankment	10,000	C.Y.	12.00	120,000
Subgrade Stabilization	20,000	S.Y.	8.00	160,000
Subbase Course	20,000	S.Y.	12.00	240,000
Asphalt Paving	9,500	Ton	130.00	1,235,000
Drainage Improvements	1	L.S.	80,000.00	80,000
Apron & Taxiway Marking	1	L.S.	10,000.00	10,000
Tiedowns	60	Each	400.00	24,000
Lighting & Signage	1	L.S.	60,000.00	60,000
Seeding	3	Acre	2,000.00	6,000
Engineering and Testing	1	L.S.	300,000.00	300,000
Total				\$ 2,310,000

PREAPP NUMBER	GRANT NUMBER	NPIAS CODE	WORK CODE	FAA PRIORITY	FEDERAL \$

AIRPORT WORK ITEM	Lawrence Municipal	LOCAL PRIORITY	09	UPDATED In what FY do you want to construct?	02/10
	Construct Equipment Storage Building, Acquire Snow Removal Equipment, and Index A ARFF Truck				2015

SKETCH:

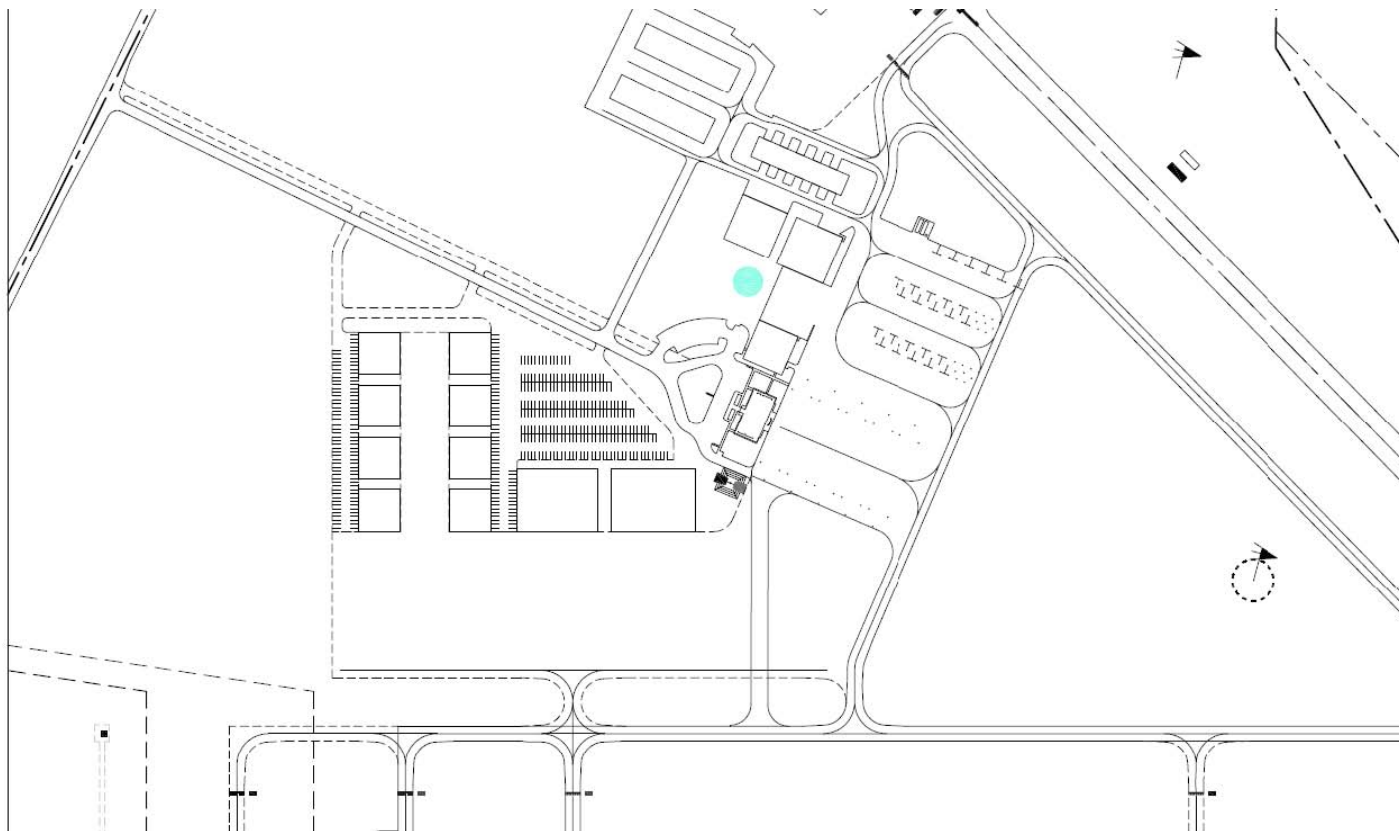

JUSTIFICATION:

A new equipment storage building is proposed to house snow removal equipment and ARFF Truck. The Airport will acquire its own snow removal equipment and an ARFF truck to help meet Part 139 requirements.

Sponsor Signature: \_\_\_\_\_

Date: \_\_\_\_\_

COST ESTIMATE:

Description	Quantity	Unit	Unit Cost	Est. Cost
Equipment Storage Building	1	L.S.	\$ 300,000	\$ 300,000
Dump Truck with Snow Plow	1	L.S.	130,000	130,000
Index A ARFF Truck	1	L.S.	150,000	150,000
ARFF Auxiliary Equipment	1	L.S.	80,000	80,000
Engineering and Testing	1	L.S.	55,000	55,000
Total				\$ 715,000

PREAPP NUMBER	GRANT NUMBER	NPIAS CODE	WORK CODE	FAA PRIORITY	FEDERAL \$

AIRPORT WORK ITEM	Lawrence Municipal	LOCAL PRIORITY	10	UPDATED In what FY do you want to construct?	02/10
	Expand Aircraft Parking Apron (Phase II) (15,000 S.Y.)				2016

SKETCH:

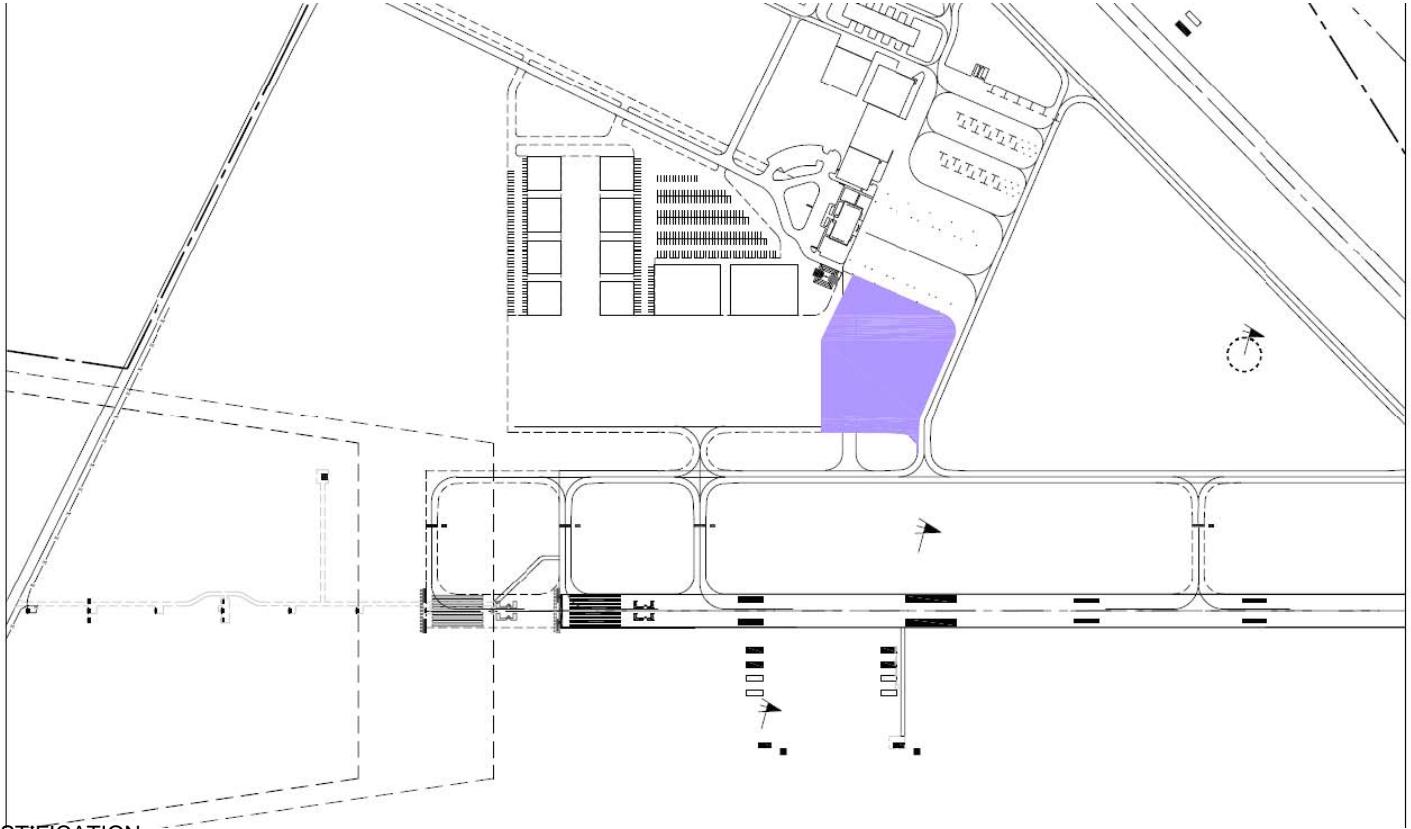

JUSTIFICATION:

Phase II Aircraft Parking Apron expansion to meet forecast demand for airport operations, based and itinerant aircraft demands. Design loading 60,000 DWG

Sponsor Signature:

Date:

COST ESTIMATE:

Description	Quantity	Unit	Unit Cost	Est. Cost
Mobilization	1	L.S.	\$60,000.00	\$ 60,000
Embankment	7,500	C.Y.	12.00	90,000
Subgrade Stabilization	15,000	S.Y.	8.00	120,000
Subbase Course	15,000	S.Y.	12.00	180,000
Asphalt Paving	7,400	Ton	130.00	962,000
Drainage Improvements	1	L.S.	90,000.00	90,000
Apron & Taxiway Marking	1	L.S.	15,000.00	15,000
Tiedowns	60	Each	400.00	24,000
Lighting & Signage	1	L.S.	75,000.00	75,000
Seeding	2	Acre	2,000.00	4,000
Engineering and Testing	1	L.S.	290,000.00	290,000
Total				\$ 1,910,000

PREAPP NUMBER	GRANT NUMBER	NPIAS CODE	WORK CODE	FAA PRIORITY	FEDERAL \$

AIRPORT WORK ITEM	Lawrence Municipal	LOCAL PRIORITY	11	UPDATED In what FY do you want to construct?	02/10
	Environmental Assessment for Runway Extension				2016

SKETCH:

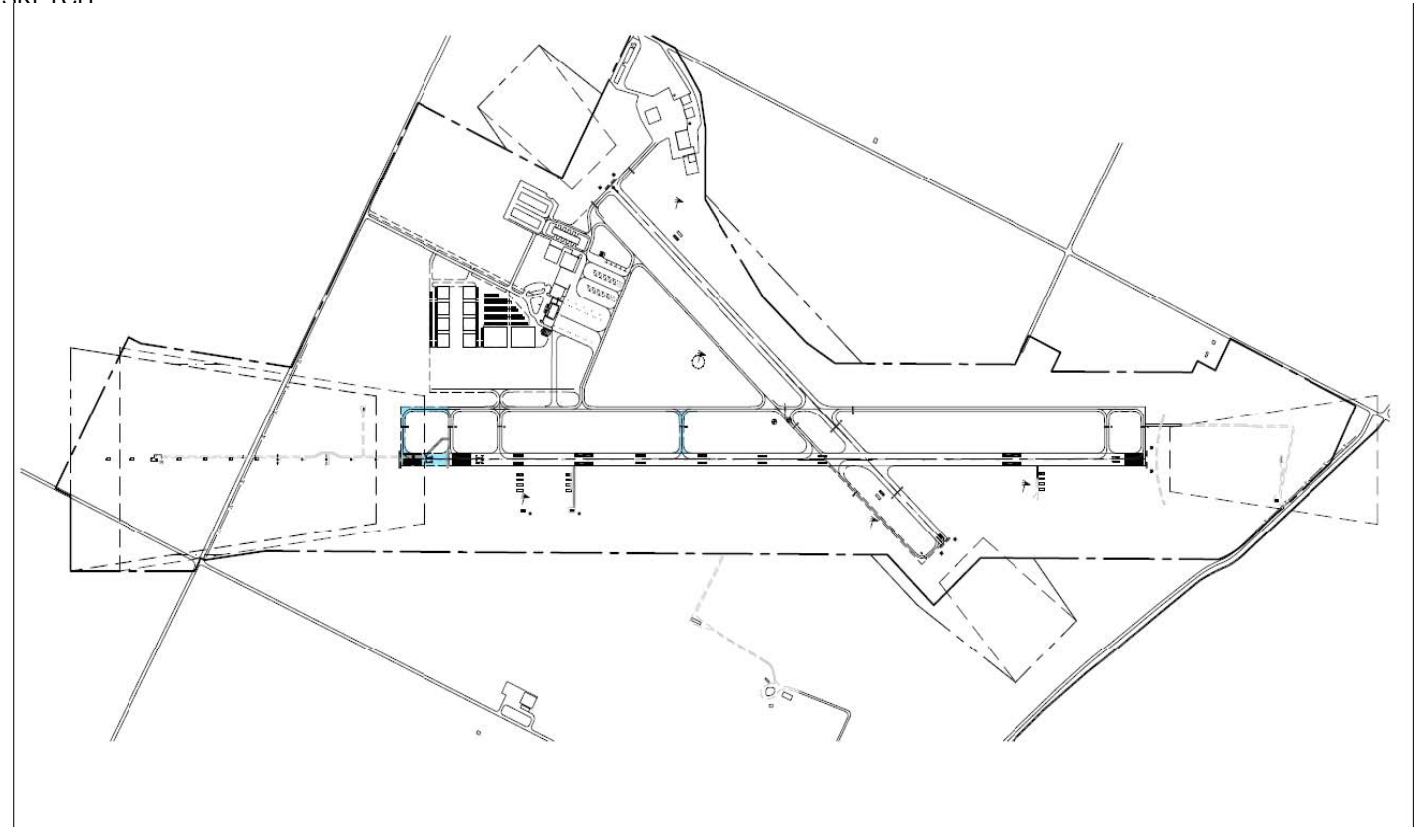

JUSTIFICATION:

Determine, evaluate and mitigate environmental concerns with expanding the runway to 6,100 feet. Design loading 60,000 DWG.

Sponsor Signature: _____			Date: _____		
COST ESTIMATE:					
Description		Quantity	Unit L.S.	Unit Cost	Est. Cost \$
Environmental Assessment		1	L.S.	\$75,000.00	\$75,000
Total					\$75,000

PREAPP NUMBER	GRANT NUMBER	NPIAS CODE	WORK CODE	FAA PRIORITY	FEDERAL \$

AIRPORT WORK ITEM	Lawrence Municipal	LOCAL PRIORITY	12	UPDATED	02/10
	Extend Runway 15-33 By 400 Feet To The South, Extend Parallel Taxiway, Airfield Lighting and Signage, Relocate Glide Slope and MALSR.			In what FY do you want to construct?	2017

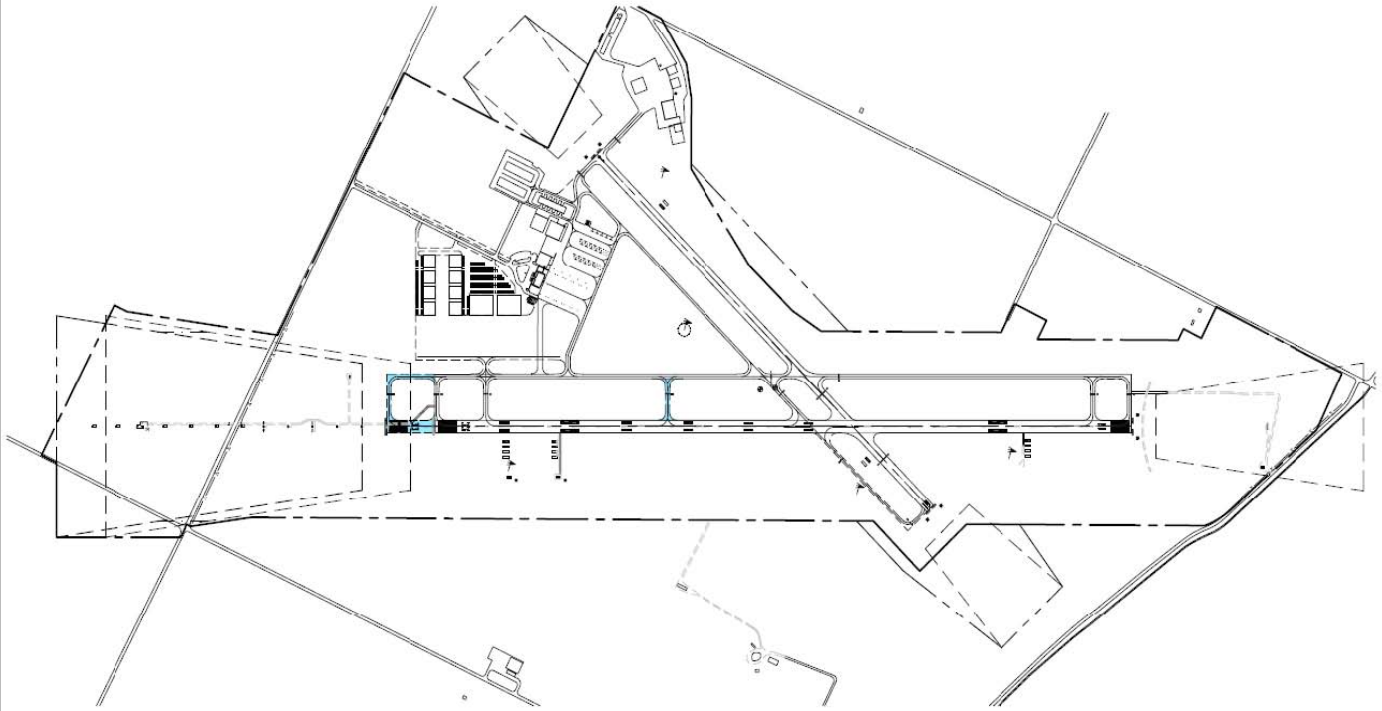

**JUSTIFICATION:**

Runway 15-33 will be extended from 5,700 feet to 6,100 feet so the airport can accommodate C-II aircraft with 1,000 nautical mile range. Runway strength will remain at 60,000 pounds DWG.

Date:

**COST ESTIMATE:**

Description	Quantity	Unit	Unit Cost	Est. Cost
Mobilization	1	L.S.	\$50,000.00	\$ 100,000
Embankment	75,000	C.Y.	12.00	900,000
Subbase Course	8,000	S.Y.	12.00	96,000
Asphalt Paving	4,000	Ton	130.00	520,000
Drainage Improvements	1	L.S.	250,000.00	250,000
Runway & Taxiway Marking	1	L.S.	50,000.00	50,000
Lighting & Signage	1	L.S.	100,000.00	100,000
Seeding	12	Acre	1,500.00	18,000
Relocate Visual Approach Aids	1	L.S.	225,000.00	225,000
Relocate Electronic Approach Aids	1	L.S.	175,000.00	175,000
Engineering and Testing	1	L.S.	316,000.00	316,000
Total				\$ 2,750,000

PREAPP NUMBER	GRANT NUMBER	NPIAS CODE	WORK CODE	FAA PRIORITY

AIRPORT WORK ITEM	Lawrence Municipal	LOCAL PRIORITY	UPDATED In what FY do you want to construct?	02/10
	Expand Aircraft Parking Apron (Phase III) (15,000 S.Y.)			Future

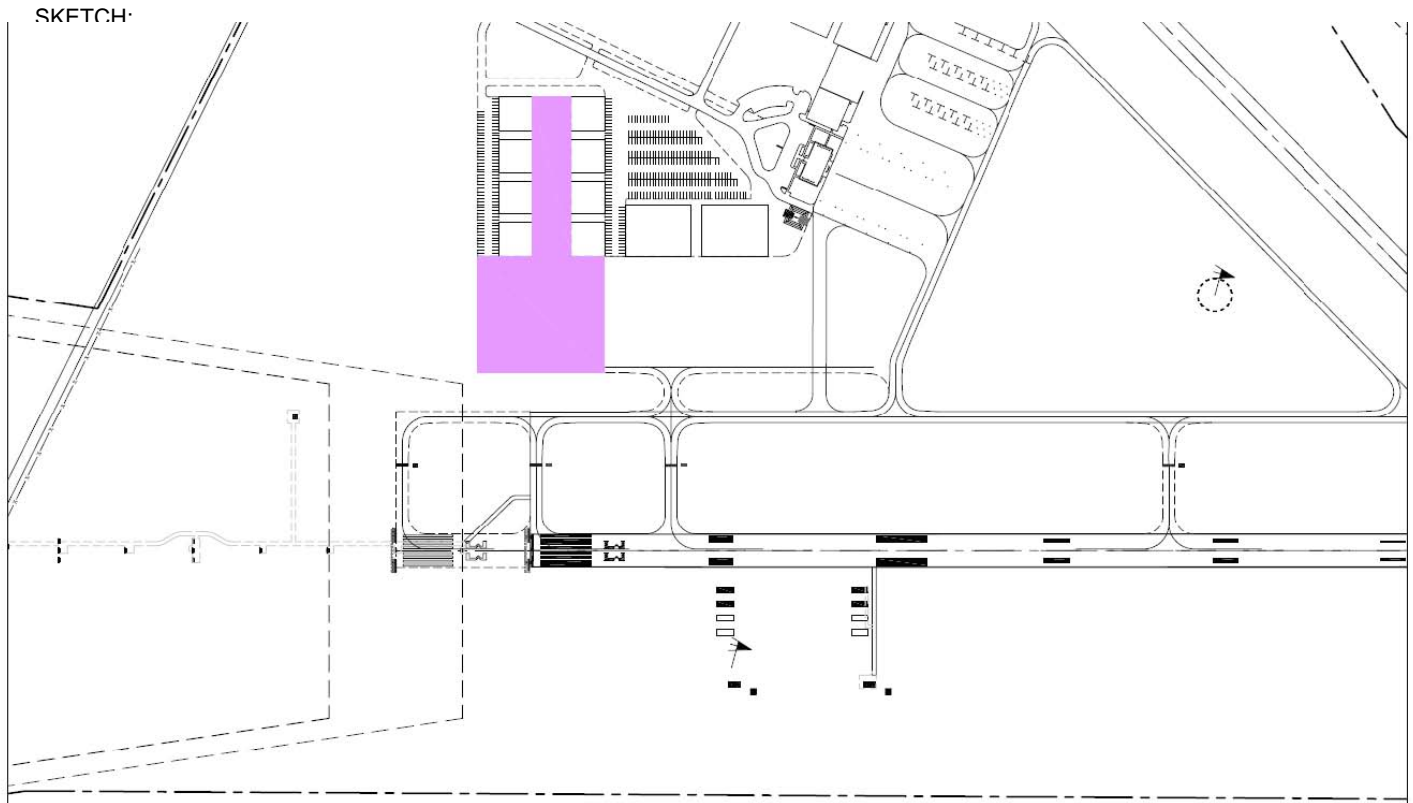

**JUSTIFICATION:**

Phase III Aircraft Parking Apron Expansion to meet forecast demand for airport operations based and itinerant aircraft demands. Design loading 60,000 DWG

Sponsor Signature: \_\_\_\_\_

Date: \_\_\_\_\_

**COST ESTIMATE:**

Description	Quantity	Unit	Unit Cost	Est. Cost
Mobilization	1	L.S.	\$50,000.00	\$ 80,000
Embankment	7,500	C.Y.	12.00	90,000
Subgrade Stabilization	15,000	S.Y.	8.00	120,000
Subbase Course	15,000	S.Y.	12.00	180,000
Asphalt Paving	7,200	Ton	130.00	936,000
Drainage Improvements	1	L.S.	130,000.00	130,000
Apron & Taxiway Marking	1	L.S.	15,000.00	15,000
Tiedowns	60	Each	400.00	15,000
Lighting & Signage	1	L.S.	75,000.00	75,000
Seeding	2	Acre	2,000.00	4,000
Engineering and Testing	1	L.S.	280,000.00	280,000
Total				\$ 1,925,000

PREAPP NUMBER	GRANT NUMBER	NPIAS CODE	WORK CODE	FAA PRIORITY	FEDERAL \$

AIRPORT WORK ITEM	Lawrence Municipal	LOCAL PRIORITY	UPDATED In what FY do you want to construct?	02/10
	Install Airport Perimeter/Security Fencing			Future

SKETCH:

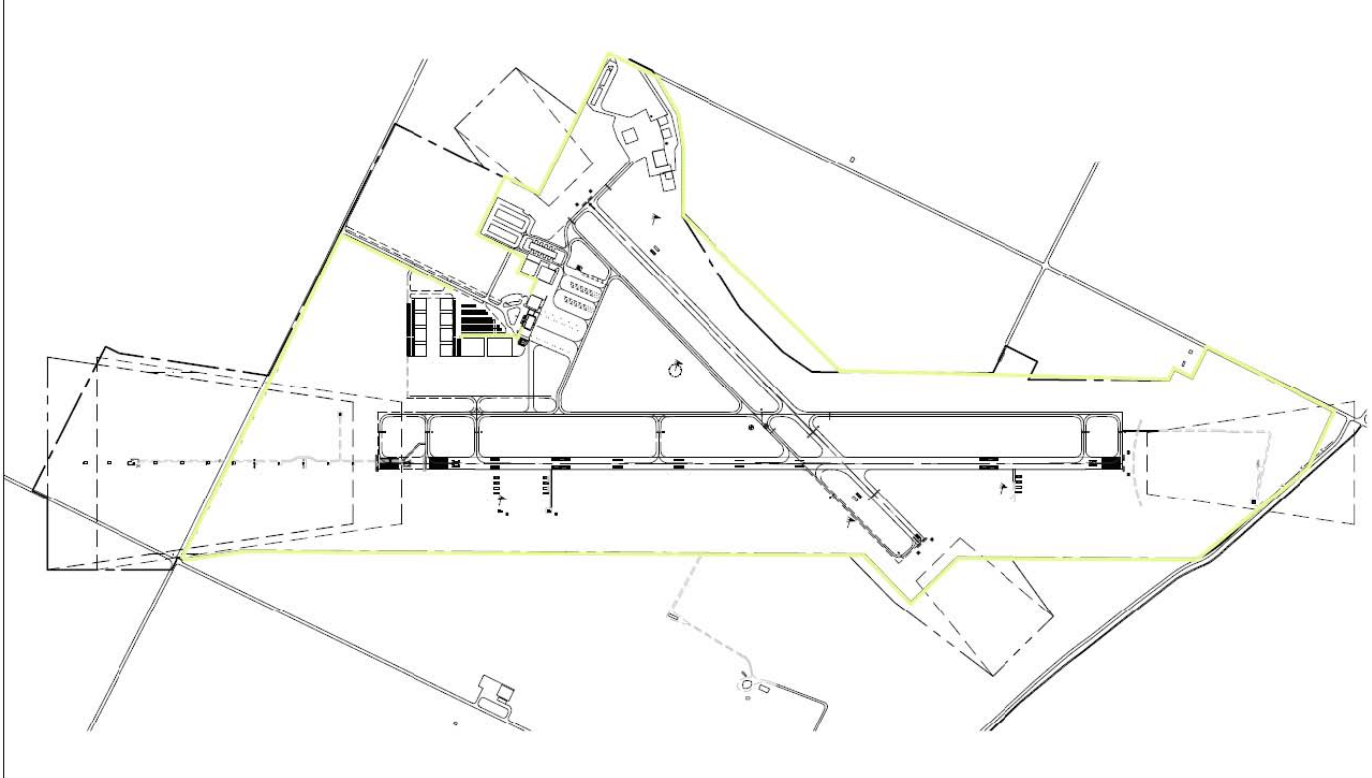

**JUSTIFICATION:**

Installation and/or upgrading airport perimeter/security fencing is necessary to control inadvertent entry onto the airports restricted operational areas for both people and wildlife, and to promote a higher level of security and access control around restricted airport facilities and infrastructure.

Sponsor Signature:

Date:

**COST ESTIMATE:**

Description	Quantity	Unit	Unit Cost	Est. Cost
Mobilization	1	L.S.	\$ 10,000.00	\$ 10,000
Woven Wire Fencing	26,000	L.F.	12.00	312,000
Chain link Fencing (8')	3,500	L.F.	25.00	87,500
Walk Gate	8	Each	500.00	4,000
Driveway Gate	4	Each	1,500.00	6,000
Automatic Driveway Gate	3	Each	30,000.00	90,000
Engineering and Testing		L.S.	90,500.00	90,500
Total				\$600,000

PREAPP NUMBER	GRANT NUMBER	NPIAS CODE	WORK CODE	FAA PRIORITY	FEDERAL \$