

SIGN EXHIBIT

PROPOSED EASEMENT DESCRIPTION

THAT PORTION CLINTON PARKWAY RIGHT OF WAY LYING ADJACENT TO THE NORTH LINE OF LOT 3 IN CLINTON PARKWAY OFFICE PARK, AN ADDITION TO THE CITY OF LAWRENCE, DOUGLAS COUNTY, KANSAS, DESCRIBED AS FOLLOWS:

COMMENCING AT THE NORTHEAST CORNER OF SAID LOT 3; THENCE SOUTH 90°00'00" WEST, COINCIDENT WITH THE NORTH LINE OF SAID LOT 3, A DISTANCE OF 38.00 FEET; THENCE NORTH 81°25'11" WEST, COINCIDENT WITH THE NORTH LINE OF SAID LOT 3, 24.47 FEET TO THE POINT OF BEGINNING; THENCE CONTINUE NORTH 81°25'11" WEST, COINCIDENT WITH THE NORTH LINE OF SAID LOT 3, 31.77 FEET; THENCE DEPARTING THE NORTH LINE OF SAID LOT 3, NORTH 00°00'00" EAST, 15.23 FEET; THENCE NORTH 90°00'00" EAST, 31.42 FEET; THENCE SOUTH 00°00'00" WEST, 19.97 FEET TO THE POINT OF BEGINNING, CONTAINING 553 SQUARE FEET, MORE OR LESS.

CLINTON PARKWAY PAVEMENT

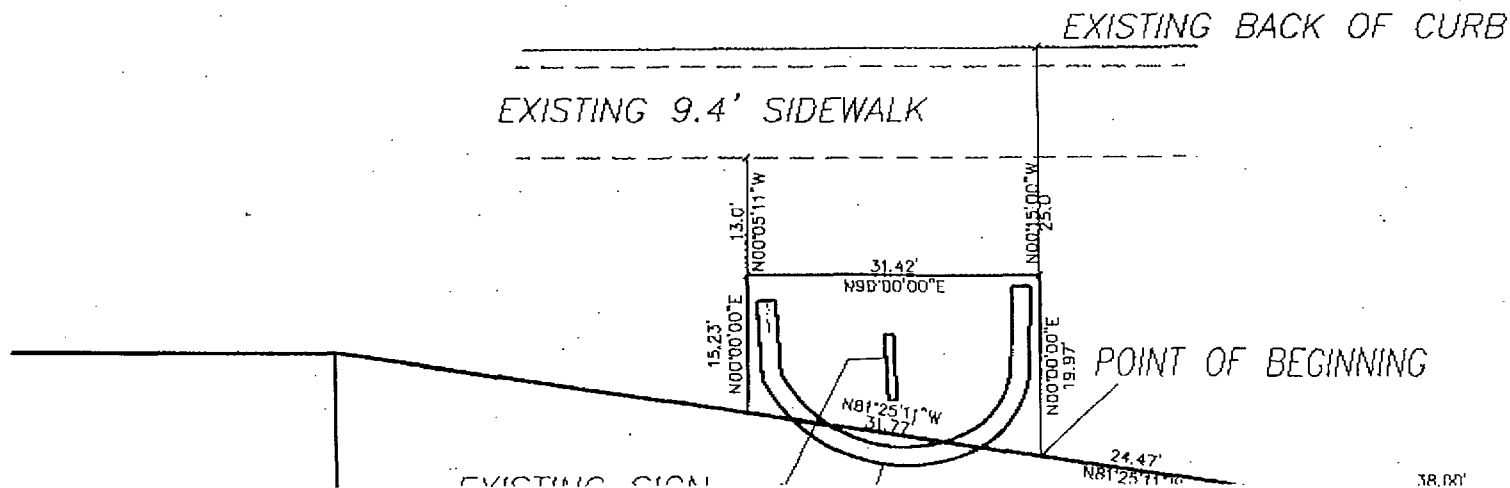

38.00'

Exh. bit 1 pg 1-2

EXISTING STONE
RETAINING WALL

LOT 3

I DENNIS BOLTZ, DO HEREBY CERTIFY THAT THIS
REAL PROPERTY DESCRIPTION WAS PREPARED BY
ME OR UNDER MY DIRECT SUPERVISION.

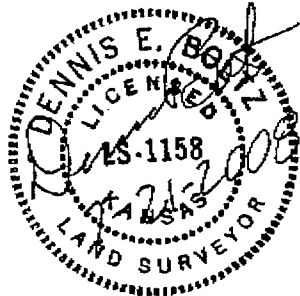

7-21-2008
DATE

DENNIS BOLTZ LS # 1158
PERIDIAN GROUP, INC
265 N STONECREEK DR.
GARDNER, KS 66030
913-856-7899

JOB # 08089
DWG: 08089-EXB.dwg

GRAPHIC SCALE

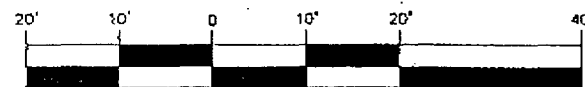

(IN FEET)
1 inch = 20 ft.

LEGEND:

DE = DRAINAGE EASEMENT
UE = UTILITY EASEMENT
STBK = BUILDING SETBACK LINE
R/W = RIGHT OF WAY