

NORTH ELEVATION SHOWING PROPOSED SIDEWALK HOSPITALITY AREA
SCALE: 1/4" = 1'-0"

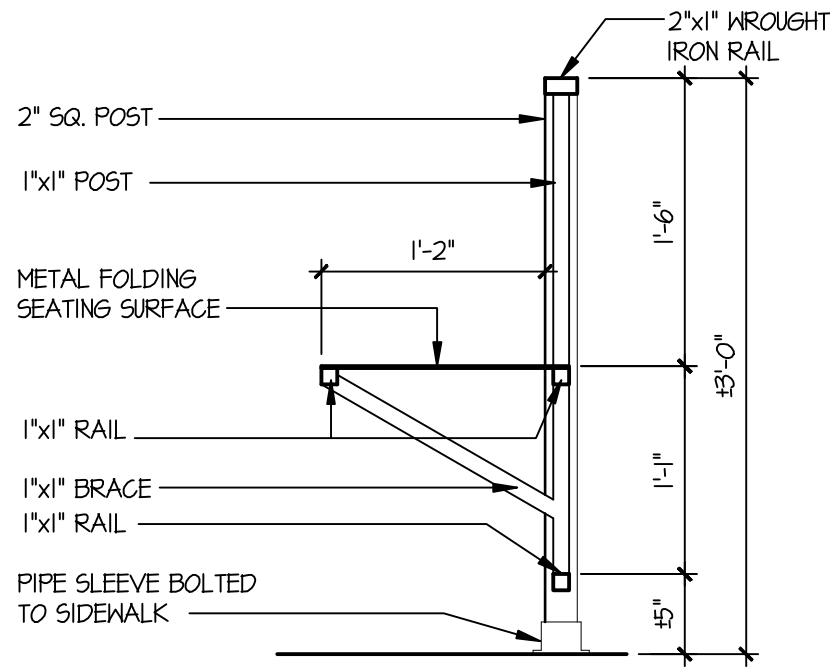

SURROUNDING PROPERTY
NO SCALE

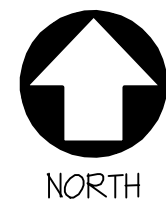

ALL MATERIAL TO BE WROUGHT IRON.

SECTION THROUGH RAILING
SCALE: 1" = 1'-0"

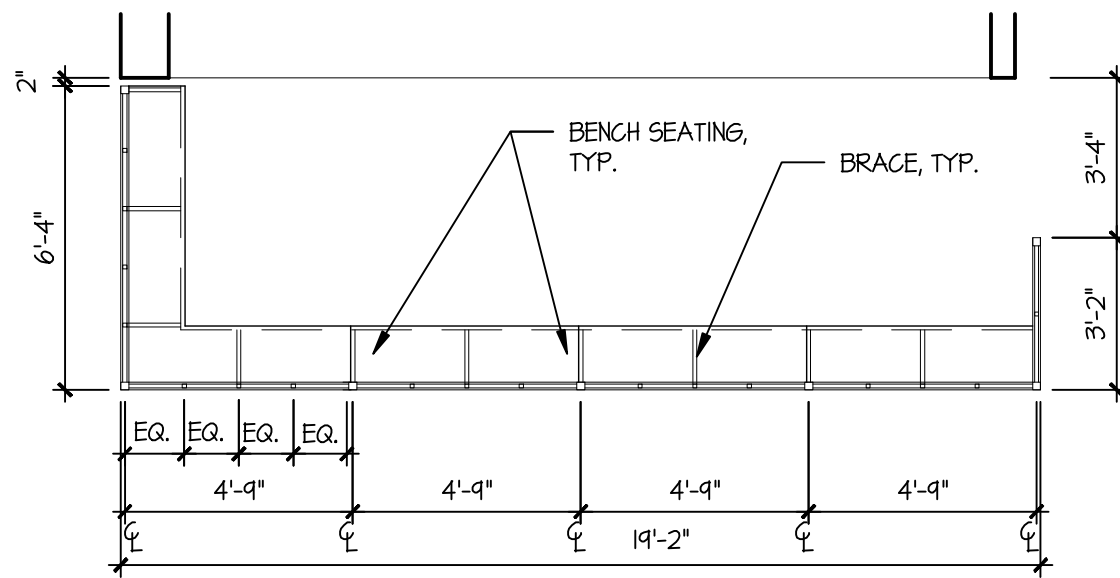

ENLARGED PLAN OF HOSPITALITY AREA
SCALE: 1/4" = 1'-0"

LOCATION MAP:
NOT TO SCALE

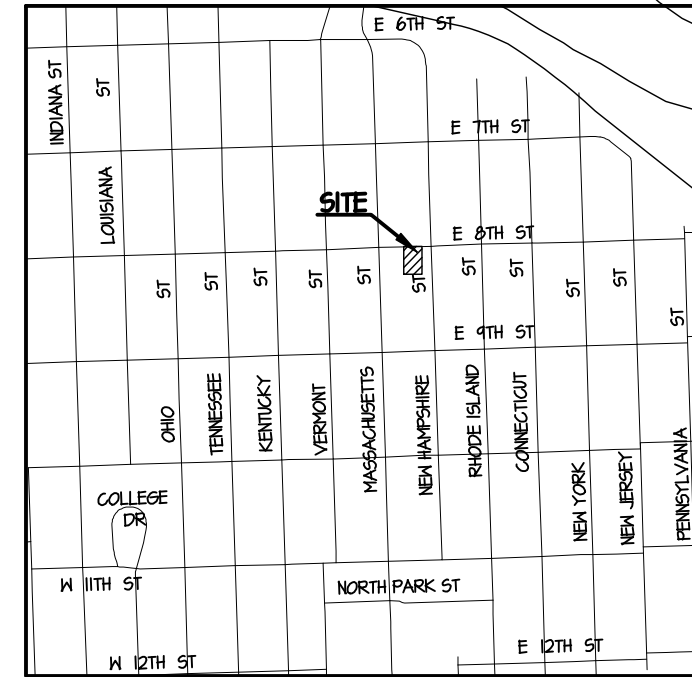

GENERAL NOTES:

- LEGAL DESCRIPTION : NEW HAMPSHIRE STREET WEST 22.3 OF EAST 416 LOT 45
ADDRESS : 17 EAST 8TH STREET
- CURRENT ZONING / USE : CD
- LAND AREA : 50' x 223' = 1115'
- PROPOSED PROJECT : SIDEWALK HOSPITALITY AREA FOR A BAR OR LOUNGE USE
- PARKING REQUIRED : EXEMPT
- DUMPSTER : EXISTING (IN ALLEY)
- PLAN FOR CITY APPROVAL, NOT FOR CONSTRUCTION.
- PROPERTY WILL NOT BE REPLATTED
- EXISTING GROSS SQUARE FOOTAGE: BASEMENT: 1,178 SQ. FT. - STORAGE
MAIN FLOOR: 1,250 SQ. FT. - BAR/LOUNGE
SECOND FLOOR: 1,162 SQ. FT. - OFFICE/ASSEMBLY
- SIDEWALK HOSPITALITY LICENSE TO BE OBTAINED UPON FINAL APPROVAL OF THE PLAN.

- PER CITY CODE SECTION 9-402, THE OUTDOOR DINING AREA WILL BE MANAGED TO PREVENT STORM WATER POLLUTION. FOOD WASTE, TRASH, CIGARETTES AND OTHER SOLID WASTES WILL BE COLLECTED AND DISPOSED OF PROPERLY. FLUID WASTE, INCLUDING WASTEWATER FROM PAVEMENT OR FURNITURE CLEANING, WILL BE COLLECTED AND DISCHARGED TO THE SANITARY SEWER SYSTEM.
- HRC REVIEW CASE #DR-02-01-04.
- RAILING SHALL NOT BE ATTACHED TO THE BUILDING.

IMPERVIOUS SURFACE TABLE:

PROJECT SITE: 1115 SQ. FT. = .026AC.

EXISTING CONDITIONS:

BUILDING FOOTPRINT: 1115 SQ. FT.
PAVEMENT AREA: 0 SQ. FT.
TOTAL IMPERVIOUS: 1115 SQ. FT.
TOTAL PERVIOUS: 0 SQ. FT.

PROPOSED CONDITIONS:

BUILDING FOOTPRINT: 1115 SQ. FT.
PAVEMENT AREA: 0 SQ. FT.
TOTAL IMPERVIOUS: 1115 SQ. FT.
TOTAL PERVIOUS: 0 SQ. FT.

LANDSCAPING:

NO ADDITIONAL LANDSCAPING IS PROPOSED.

ENFORCEMENT COMPLIANCE CRITERIA:

ON A QUARTERLY BASIS THE CODES ENFORCEMENT DIVISION WILL VISUALLY INSPECT THE LOCATION OF EACH LICENSED SIDEWALK DINING LICENSEE AND INSPECT THE SIDEWALK DINING AREA. THE CODES ENFORCEMENT DIVISION WILL VERIFY THE LICENSEE IS OPERATING THE SIDEWALK DINING AREA CONSISTENT WITH THE SITE PLAN AND CONDITIONS; USE OF RIGHT OF WAY AGREEMENT, ALL APPLICABLE CITY CODE PROVISIONS; AND GUIDELINES FOR SIDEWALK DINING AREAS. SPECIFICALLY, THE CODES ENFORCEMENT DIVISION WILL VERIFY:

- THE SIDEWALK DINING AREA IS NOT BEING USED WHEN THE RESTAURANT OR FOOD SERVICE ESTABLISHMENT IS CLOSED.
- ADVERTISING SIGNAGE IS NOT PRESENT IN THE SIDEWALK DINING AREA EXCEPT FOR THE NAME OF THE ESTABLISHMENT ON CHAIRS OR TABLES AS APPROVED BY THE CITY.
- ALL AMENITIES INCLUDING RAILINGS, BARRIERS, CHAIRS, AND TABLES ARE MAINTAINED IN GOOD CONDITION.
- THERE IS NO BLOCKAGE OF BUILDING ENTRANCES OR EXITS IN THE SIDEWALK DINING AREA.
- THE SIDEWALK DINING AREA; THE AREA FROM THE FRONT BUILDING FACADE TO THE CURB LINE, AND FIVE FEET ALONG THE ADJACENT SIDEWALK TO BOTH SIDES OF THE SIDEWALK DINING AREA, CONTAIN NO TRASH.
- NO TRASH OR REFUGE STORAGE CONTAINERS ARE IN THE SIDEWALK DINING AREA OR ON ADJACENT SIDEWALK AREAS.
- PURSUANT TO SECTION 9-402 OF THE CITY CODE, SIDEWALK DINING AREAS MUST BE MANAGED TO PREVENT STORMWATER POLLUTION.
- FOOD WASTE, TRASH, CIGARETTES AND OTHER SOLID WASTES MUST BE CONTAINED, COLLECTED, AND DISPOSED PROPERLY. COLLECTION MUST BE FREQUENT ENOUGH TO PREVENT WASTES CARRIED OFF BY WIND OR STORMWATER RUNOFF.
- WASTEWATER FROM THE CLEANING OF PAVEMENT, BUILDINGS, FURNITURE OR OTHER OUTDOOR SURFACES MUST BE COLLECTED AND DISCHARGED TO THE SANITARY SEWER SYSTEM OR OTHER APPROVED WASTEWATER TREATMENT PROCESS. INSTALLATION OF A NEARBY SANITARY SEWER CLEANOUT IS RECOMMENDED FOR THIS PURPOSE.
- PAVEMENT AND FURNISHINGS MUST BE CLEANED FREQUENTLY ENOUGH TO PREVENT CONTAMINATION OF STORMWATER RUNOFF.
- FOOD PREPARATION IS NOT PERMITTED WITHIN SIDEWALK DINING AREAS.
- IF THE ESTABLISHMENT NO LONGER HAS A CURRENT SIDEWALK DINING LICENSE, THE CODES ENFORCEMENT DIVISION WILL CONTACT THE FORMER LICENSEE OR OWNER OF THE PREMISES TO REQUIRE REMOVAL OF THE RAILING OR OTHER AMENITIES REMAINING IN THE RIGHT OF WAY.
- THERE WILL BE NO SOUND AMPLIFICATION DEVICES OR OTHER MEANS OF NOISE PRODUCTION UTILIZED IN THE SIDEWALK HOSPITALITY AREA.

FOR SIDEWALK DINING LICENSEES WITH A VALID DRINKING ESTABLISHMENT LICENSE AND CITY COMMISSION APPROVAL TO SELL, AND ITS PATRONS TO POSSESS AND CONSUME ALCOHOLIC BEVERAGES IN THE PUBLIC RIGHT OF WAY, THE CODES ENFORCEMENT DIVISION WILL INSPECT THE SIDEWALK DINING AREA TO ENSURE COMPLIANCE WITH THE FOLLOWING:

- POSSESSION AND CONSUMPTION OF ALCOHOL IN THE SIDEWALK DINING AREA IS LIMITED TO PATRONS SEATED AT TABLES.
- AN EMPLOYEE OF THE LICENSEE IS WORKING IN THE SIDEWALK DINING AREA, OR OTHERWISE ABLE TO MONITOR THE SIDEWALK DINING AREA, TO PREVENT ALCOHOLIC BEVERAGES FROM LEAVING THE LICENSED PREMISES AND TO ENSURE COMPLIANCE WITH OTHER ALCOHOL RELATED PROVISIONS.
- ALL ALCOHOLIC BEVERAGES CONSUMED IN THE SIDEWALK DINING AREA ARE IN THE APPROPRIATE CONTAINERS (NO GLASSES, CANS OR BOTTLES) UNLESS THE ESTABLISHMENT DEMONSTRATES IT MEETS THE 55% FOOD SALES REQUIREMENT.
- NO TAPS, KEGS, COOLERS, OR OTHER ALCOHOLIC BEVERAGE STORAGE DEVICES ARE USED IN THE SIDEWALK DINING AREA.

paulwerner
ARCHITECTS

545 COLUMBIA DRIVE
SUITE 1002
LAWRENCE, KS 66049
OFFICE: 785.832.0804
FAX: 785.832.0890

QUINER:
PEACH MADL
17 E 8TH STREET
LAWRENCE, KANSAS
66044
OFFICE (785) 842-0111

THE SANDBAR
SIDEWALK HOSPITALITY AREA
17 EAST 8TH STREET
LAWRENCE, KANSAS

PROJECT # 28850

FEBRUARY 2, 2009

RELEASE: DATE:
1.0 2.2.09
1.1 3.25.09
1.2 5.4.09