

# Links Sensitive Area Site Plan Soils Classification Map, Enlarged

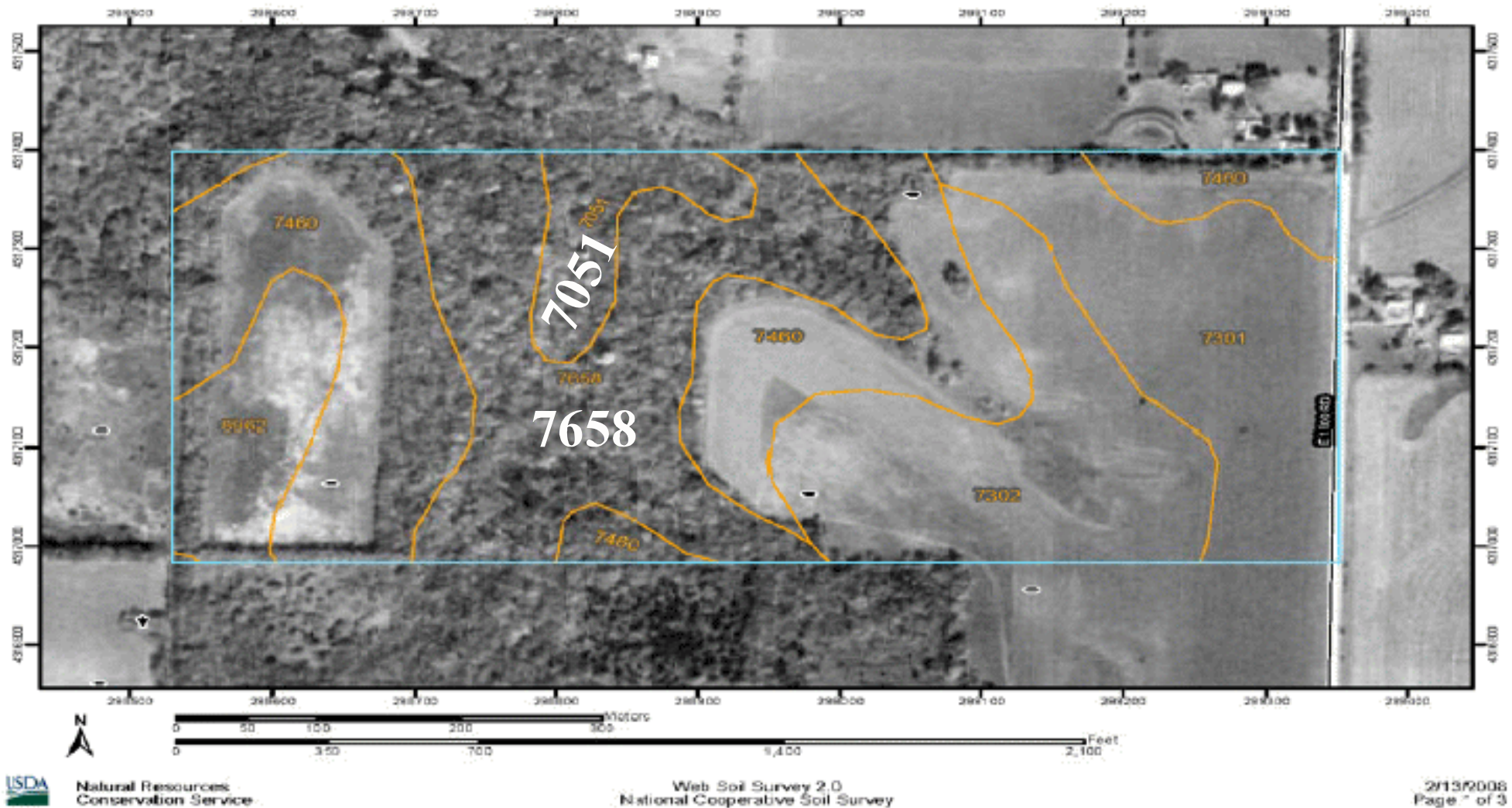

**Figure 1.** This is a screen print of an enlargement of the Links at Lawrence Sensitive Area Site Plan . The table describing each soil type is on attached page. This was enlarged because the original is too small to read.

# Table from Links Soils Map

| Douglas County, Kansas (KS045)    |   |              |                |
|-----------------------------------|---|--------------|----------------|
| Map Unit Symbol                   | Map Unit Name   | Acres in AOI | Percent of AOI |
| 7051                              | Kennebec silt loam, frequently flooded                | 3.8          | 4.5%           |
| 7301                              | Martin silty clay loam, 1 to 3 percent slopes         | 13.6         | 16.1%          |
| 7302                              | Martin silty clay loam, 3 to 7 percent slopes         | 15.0         | 17.7%          |
| 7460                              | Oska silty clay loam, 3 to 6 percent slopes           | 26.5         | 31.4%          |
| 7658                              | Vinland-Rock outcrop complex, 15 to 45 percent slopes | 20.0         | 23.7%          |
| 8962                              | Woodson silt loam, 1 to 3 percent slopes              | 5.6          | 6.6%           |
| Totals for Area of Interest (AOI) |   | 84.5         | 100.0%         |

**Figure 2.** This is a screen print of an enlarged Soils Map excerpted from the Sensitive Area Site Plan, Staff Report on The Links At Lawrence rezoning application, February 26, 2008, City Commission Regular Agenda Item No. 1. The following is the list of land characteristics falling under the definition of “sensitive land” copied directly from 20-1101(d)(2): “a. Floodways, based on 100 year storm; b. [Floodplain](#) outside the floodway, based on 100 year storm; c. Jurisdictional [Wetlands](#); d. [Stream Corridors](#); e. [Stand of Mature Trees](#) or Individually Significant Mature Trees; f. Prominent Geographic Features with Rocky Outcroppings;” and also including “g. [Archaeological and Historic Sites](#).”



# Slope Map for Links Sensitive Area Site Map



**Figure 3.** Screen Print of an enlarged excerpt taken from the Sensitive Area Site Plan for THE LINKS AT LAWRENCE. This shows +15% slopes, approximately 19.01 acres in acres. The soil is Vinland Rock Outcrop. The slope sides are extremely erodible. The stream will continue to flow on the outside of any enclosure, the underground current continuing to undermine any fill. The **Land Development Code** in 1701 (Definitions) identifies the one type of sensitive land to be protected as **stream corridors** and defines them as “A strip of land 100 feet wide, of which the centerline shall be the centerline of a stream that is not an intermittent stream or an intermittent stream specifically identified in the Comprehensive Plan as a significant intermittent stream subject to protection.” The Northwest plan (see next page) identifies this stream in the Floodplain Map included in the Northwest Plan. The Area Plans are included in and are a part of the Comprehensive Plan.

