

DEC 21, 2006

To: Traffic Safety Commission City of Lawrence

From: Phyllis and Stan Rolfe, 821 Sunset Drive, Lawrence

Subject: Safety Issue at Intersection of Ninth Street and Sunset Drive to the North

We are concerned about the safety of pedestrians and cars at the intersection of Ninth Street and Sunset Drive to the north which is shown in Attachment A.

At present, cars park on both sides of the 800 block of Sunset Drive resulting in only one driving lane open while entering or exiting this residential area. Sunset drive is one of two exits servicing the area north of Ninth Street which has some 31 homes on Sunset Drive, Broadview and Dudley Court using this intersection. The second exit is located at Highland Drive and Ninth Street, is very close to Iowa Street and is in essence a 5 way intersection. Some of the residents on Highland Drive also choose to use the Ninth and Sunset exit making it a fairly busy corner.

During heavy traffic times, if a car is exiting Sunset Drive at the same time a second car is trying to enter either from the east or the west accidents are possible. This is particularly true if a third car is traveling from the east and comes up and over the Ninth Street hill on top of someone trying to turn into Sunset that has been slowed by the congestion at this intersection.

Attachment B and C show the congestion at the above mentioned corner at two different times of day. Attachment D shows the added danger at night when visibility is poor.

From a safety perspective, we are requesting that NO PARKING signs be placed on the East side of sunset Drive, between Ninth Street and Broadview. (Attachment E). This distance is approximately 120 feet and will make entering and exiting Sunset Drive to the north much safer for the residents of this area.

It would also help to make the area more accessible to emergency vehicles.

Thank you for your consideration.



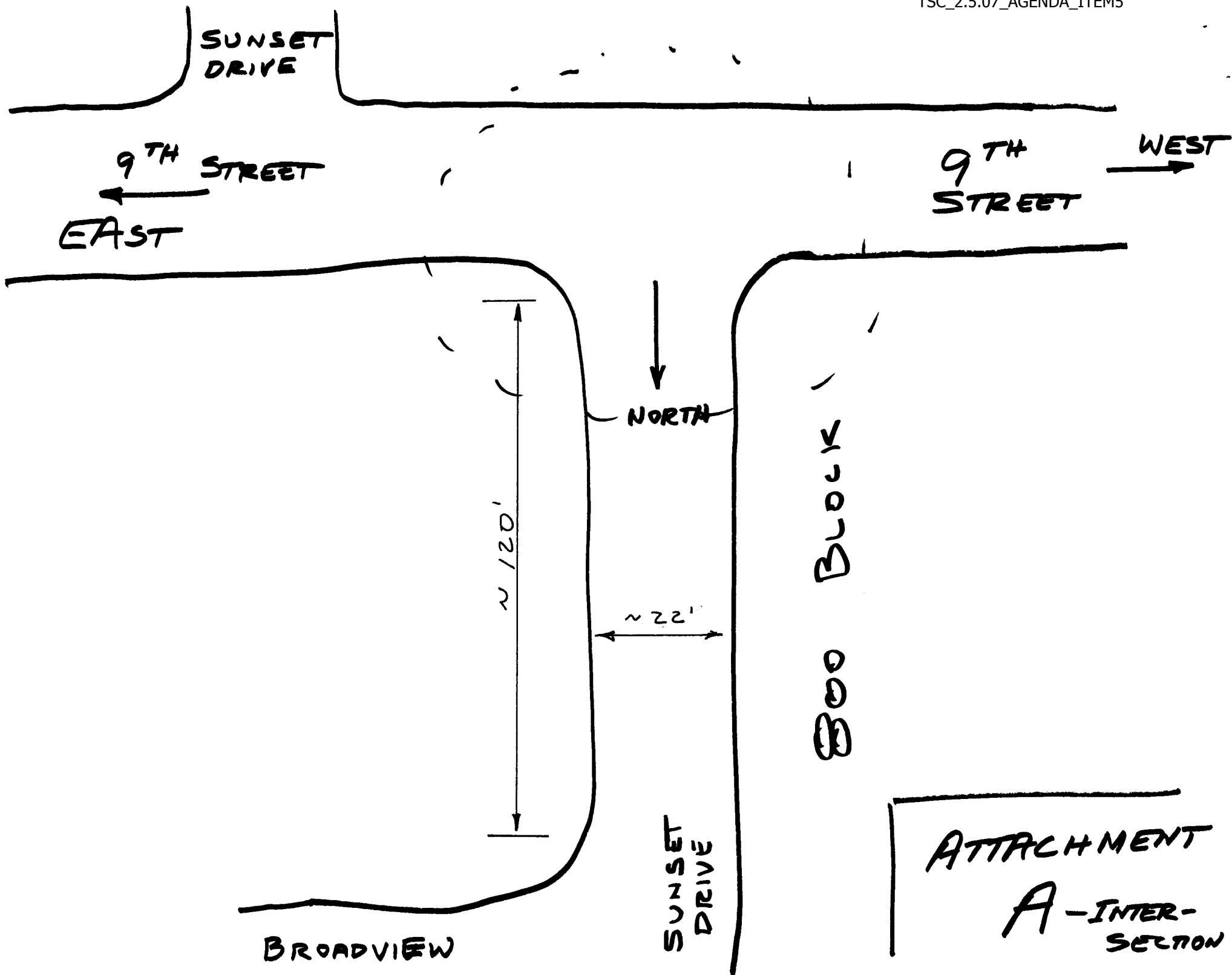

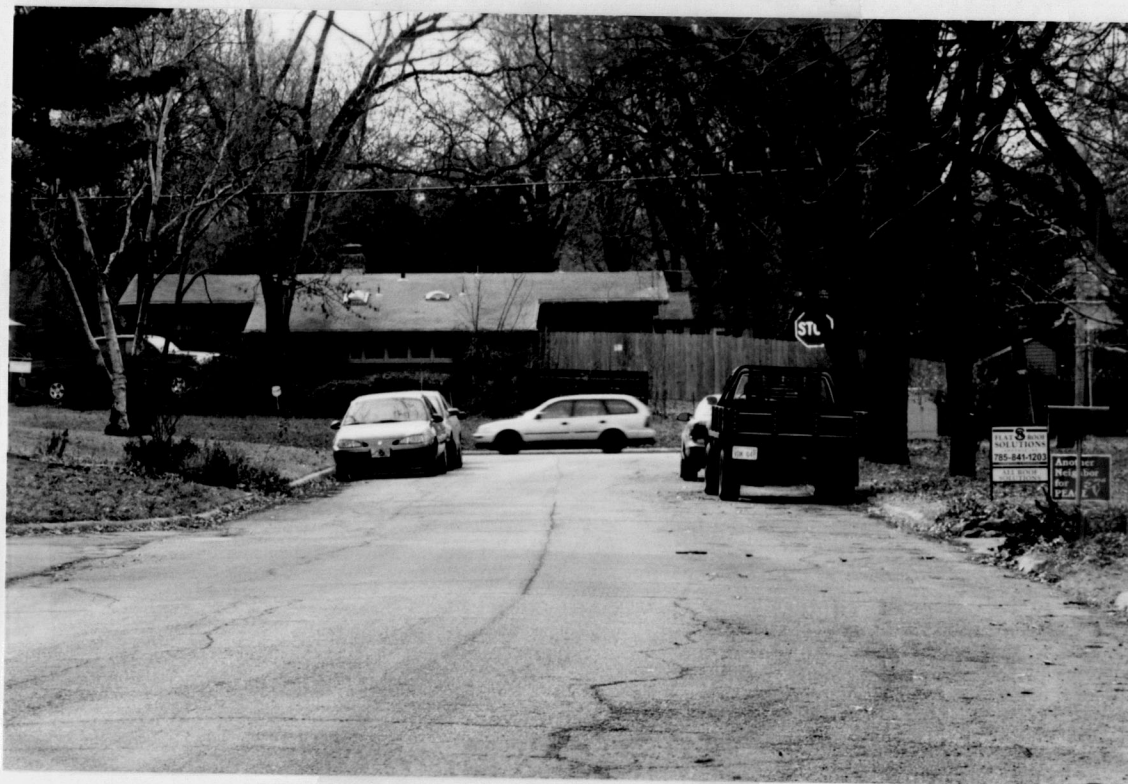

ATTACHMENT B - INTERSECTION
LOOKING SOUTH -
CARS PARKED ON
BOTH SIDES OF SUNSET



ATTACHMENT C - INTERSECTION
LOOKING SOUTH -
CARS PARKED ON
BOTH SIDES OF SUNSET

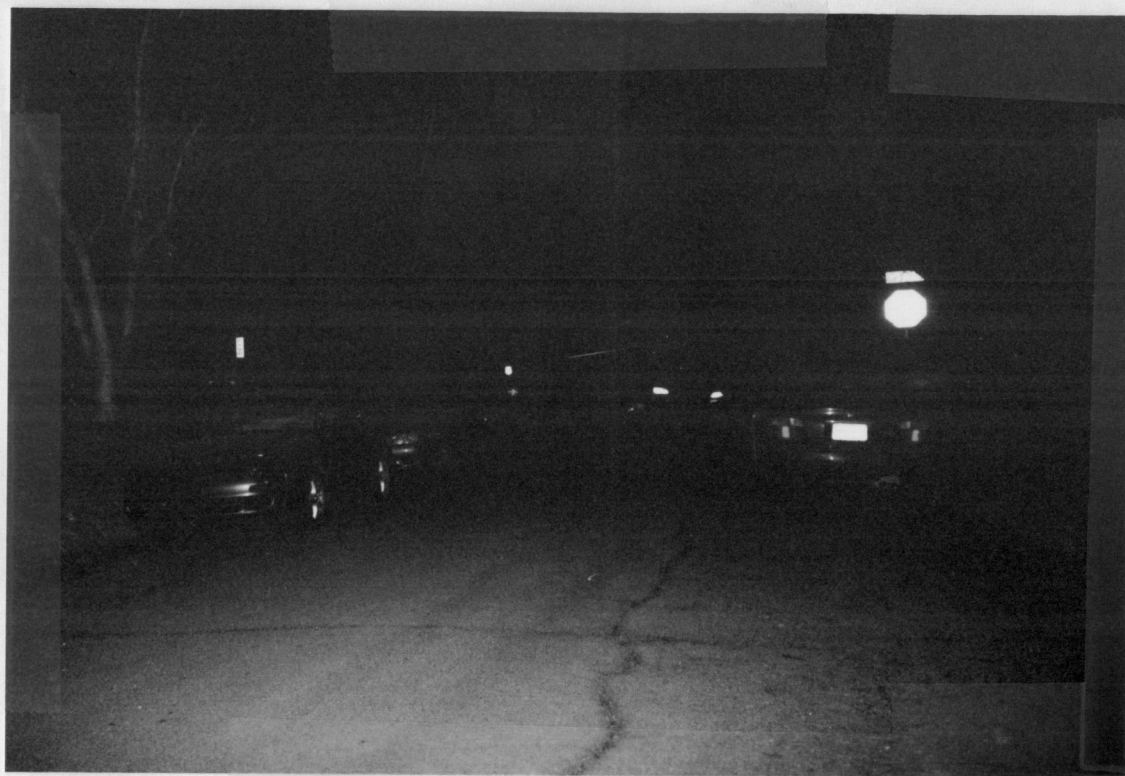

ATTACHMENT D - INTERSECTION
LOOKING SOUTH
AT NIGHT

