

M C V Limited

KASOLD ROAD

1" = 200'

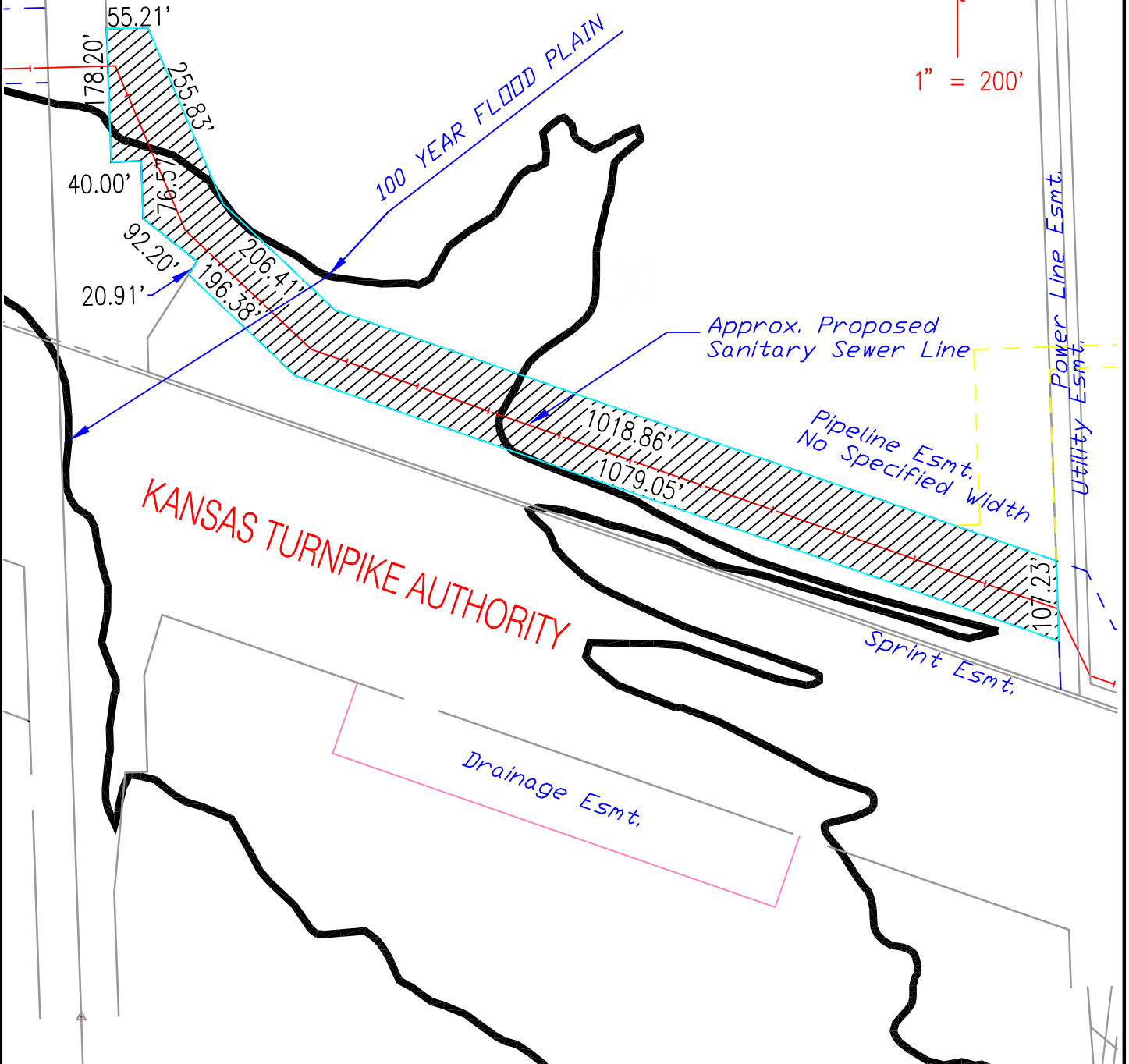

Professional Engineering Consultants, P.A.

1263 S.W. TOPEKA BLVD. • TOPEKA, KANSAS 66612  
785-233-8300 • FAX 785-233-8855

TEMPORARY CONSTRUCTION EASEMENT  
M C V LIMITED PROPERTY