

Z-02-02-04: Rezoning of 3.242 acres from RS-1 to M-2
 Former Riverside School on SW Corner of N Iowa St & Riverridge Rd

Lawrence-Douglas County Planning Office
 February 2004



Area Requested

Scale: 1 Inch = 500 Feet

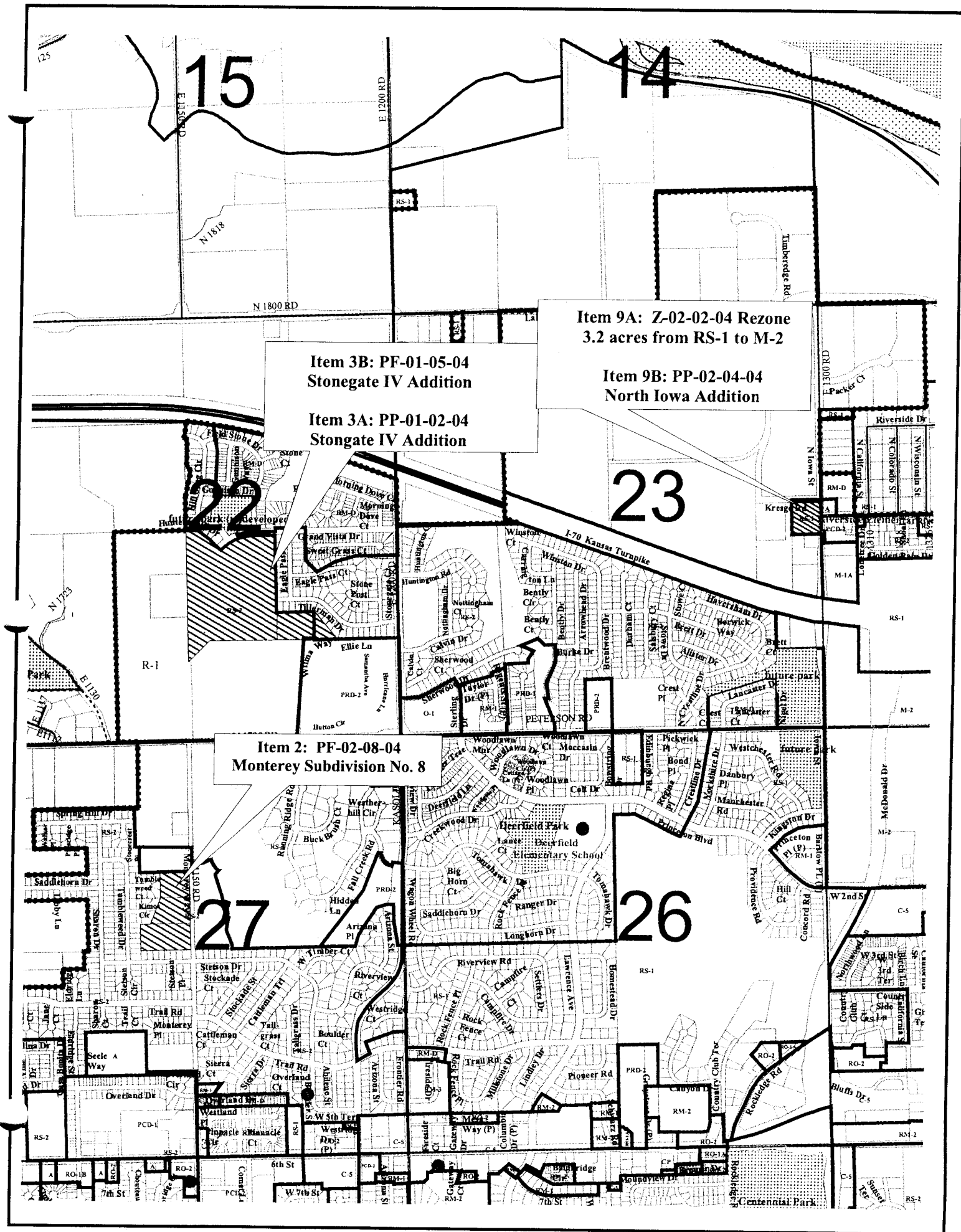

15

14

23

27

26

Item 3B: PF-01-05-04
Stonegate IV Addition

Item 3A: PP-01-02-04
Stonegate IV Addition

Item 9A: Z-02-02-04 Rezone
3.2 acres from RS-1 to M-2

Item 9B: PP-02-04-04
North Iowa Addition

Item 2: PF-02-08-04
Monterey Subdivision No. 8